



GOVERNOR'S HURRICANE CONFERENCE[®]

MAY 8-13, 2022

PALM BEACH COUNTY CONVENTION CENTER
HILTON WEST PALM BEACH

STRONGER TOGETHER



Florida Division of
Emergency Management

American
Red Cross

National Weather
Service

Florida Emergency
Preparedness Association

P.O. Box 279, Tarpon Springs, FL 34688-0279 ♦ Phone (727) 944-2724 ♦ Fax (727) 944-2687
E-mail: rene@flghc.org

GrantWorks

RESILIENCY ADVISOR TO

OVER 450

STATES, COUNTIES, AND CITIES

SUBJECT-MATTER EXPERTS IN:



CDBG - DISASTER RECOVERY



BUYOUTS & ACQUISITIONS



HAZARD MITIGATION



AMERICAN RESCUE PLAN



FEMA PUBLIC ASSISTANCE



HOUSING ASSISTANCE

COME SEE US!

BOOTHS 741, 743, 745

MY CIGAR ROLLER CO.
ROLLING ON 05/11 & 05/12

**BUILDING OUR NATION'S COMMUNITIES. HELP FOR
TODAY, HOPE FOR TOMORROW.**

512.387.4556 | www.GrantWorks.net

Governor's Hurricane Conference®

In-Kind Donors



The Governor's Hurricane Conference® relies heavily on the assistance of volunteers to prepare for and execute the conference. The four sponsoring agencies (Florida Division of Emergency Management, American Red Cross, Florida Emergency Preparedness Association and the National Weather Service) dedicate extensive human and other resources to all aspects of the conference. Additionally, other agencies and organizations provide staff and services that help make the conference a success. It is with sincere appreciation that we recognize those agencies.



Governor's Hurricane Conference®

Conference Underwriters



As a not-for-profit corporation, the Governor's Hurricane Conference® strives to maintain reasonable registration fees that afford the maximum participation of all organizations, large and small. With that philosophy, it would not be possible for the GHC to provide all of the amenities that attendees enjoy, without assistance. Therefore, we seek financial contributions from the business community in order to provide refreshment breaks and other items and events.

This year's Underwriters deserve a very sincere "Thank You" from all of us for making the Governor's Hurricane Conference® not only a great learning experience, but an enjoyable experience, as well. As you see representatives of our Underwriters this week, please convey your appreciation for their help.



Governor's Hurricane Conference®

Student Program



The GHC Student Program is in its 13th year and continues to empower the next generation of emergency management professionals through education, networking, and mentorship. We could not do it without the generous contributions of our sponsors. Thank you for your continued support!

Follow us on Twitter @FLGHC_Students and like us on Facebook (www.facebook.com/FLGHCStudents/) to see what our current and former students are up to.

For any questions, or for information on how to become a sponsor for next year's program, email us at GHCStudentProgram@gmail.com.



HILTON WEST PALM BEACH FLOOR PLAN

HOTEL LAYOUT
HILTON WEST PALM BEACH



- KEY
- MEETING/CONFERENCE ROOMS
 - FOOD & BEVERAGE
 - RESTROOMS

HOTEL LAYOUT
HILTON WEST PALM BEACH

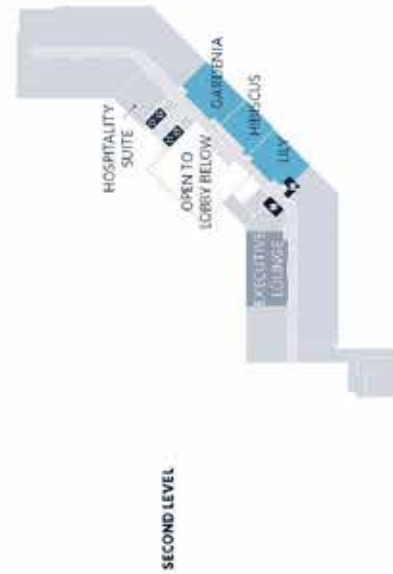

Contents

Agenda of Activities	2
Awards Luncheon.....	5
Exhibit Hall Events.....	9
Exhibit Hall Map.....	6
Exhibitors.....	7
Floor Plan Hilton WPB.....	iv
Floor Plan PBCCC.....	37
General Session	4
Hotels	1
In-Kind Donors.....	i
Mobile App.....	3
Registration Policies	1
Student Program	iii
Training Session Descriptions	11
Training Session Matrix	18
Underwriters	ii
Workshop Descriptions.....	25
Workshop Matrix.....	19



PURPOSE BUILT TO PROTECT™



Commitment
to Safety



Collection
of Innovators



Solution
Systems

Visit us at
Booth #225



SAFETY

TRUST

EXPERIENCE

PROFESSIONALISM

- Pre-event Disaster Planning
- Emergency Road Clearance
- Hazardous Tree Removal
- Debris Removal and TDS Management

Custom
TREE CARE inc.
DISASTER RESPONSE // //

(785)478-9805
CustomTreeCare.com

CONFERENCE HOTELS

Headquarters Hotel

Hilton West Palm Beach

600 Okeechobee Blvd.

West Palm Beach, FL 33401

Phone: (561) 231-6000

West Palm Beach Marriott

1001 Okeechobee Blvd.

West Palm Beach, FL 33401

Phone: (561) 833-1234

Hyatt Place West Palm Beach/Downtown

295 Lakeview Ave.

West Palm Beach, FL 33401

Phone: (561) 655-1454

Hilton West Palm Airport

150 Australian Ave.

West Palm Beach, FL 33406

Phone: (561) 684-9400

IMPORTANT REGISTRATION POLICIES

- Name badges are color-coded based on the registration fee paid.
Attendees will be required to wear their name badges at all conference functions.
- Blue:** Fully registered for all training sessions and conference activities, including the Awards Luncheon. (Sunday - Friday)
- Purple:** Fully registered for all training session activities (Sunday - Wednesday)
- Red:** Fully registered for all conference activities, including the Awards Luncheon. (Wednesday - Friday)
- Black:** Not registered, presenter only for presentations or conference support.

- Registration may not be “shared.” Authorization for substitution of pre-registered attendees must be presented in writing.

36th Governor's Hurricane Conference®

Agenda of Activities

Palm Beach County Convention Center / Hilton West Palm Beach

Sunday, May 8

10:00 a.m. – 5:00 p.m.	Registration Opens.....	PBCCC, Level 1
12:00 p.m. – 5:00 p.m.	Social Media Lounge.....	PBCCC, Level 1
1:30 p.m. – 5:00 p.m.	Training Sessions.....	PBCCC, Level 1 & 2
3:00 p.m. – 3:30 p.m.	Break.....	PBCCC, Level 1

Monday, May 9

7:30 a.m. – 5:00 p.m.	Registration Opens.....	PBCCC, Level 1
8:00 a.m. – 8:30 a.m.	Morning Beverages.....	PBCCC, Level 1
8:00 a.m. – 5:00 p.m.	Social Media Lounge.....	PBCCC, Level 1
8:30 a.m. – 5:00 p.m.	Training Sessions.....	Hilton & PBCCC
8:30 a.m. – 5:00 p.m.	Media Room.....	PBCCC, Room 1J/K
10:00 a.m. – 10:30 a.m.	Break.....	PBCCC Level 1
12:00 p.m. – 1:30 p.m.	Lunch.....	(on your own)
3:00 p.m. – 3:30 p.m.	Break.....	PBCCC Level 1

Tuesday, May 10

8:00 a.m. – 5:00 p.m.	Registration Opens.....	PBCCC, Level 1
8:00 a.m. – 8:30 a.m.	Morning Beverages.....	PBCCC, Level 1
8:00 a.m. – 5:00 p.m.	Social Media Lounge.....	PBCCC, Level 1
8:30 a.m. – 5:00 p.m.	Training Sessions.....	Hilton & PBCCC
8:30 a.m. – 5:00 p.m.	Media Room.....	PBCCC, Room 1J/K
10:00 a.m. – 10:30 a.m.	Break.....	PBCCC Level 1
12:00 p.m. – 1:30 p.m.	Lunch.....	(on your own)
3:00 p.m. – 3:30 p.m.	Break.....	PBCCC Level 1

Wednesday, May 11

8:00 a.m. – 5:00 p.m.	Registration Opens.....	PBCCC, Level 1
8:00 a.m. – 8:30 a.m.	Morning Beverages.....	PBCCC, Level 1
8:00 a.m. – 5:00 p.m.	Social Media Lounge.....	PBCCC, Level 1
8:30 a.m. – 5:00 p.m.	Media Room.....	PBCCC, Room 1J/K
8:45 a.m. – 11:00 a.m.	General Session.....	PBCCC, Level 2, Grand Ballroom
11:30 a.m. – 1:00 p.m.	FEPA Board of Directors Meeting.....	Hilton, Cypress B
11:00 a.m. – 6:00 p.m.	Exhibits.....	PBCCC, Level 1, Exhibit Hall
12:00 p.m. – 1:30 p.m.	Complimentary Lunch in Exhibit Hall.....	PBCCC, Level 1, Exhibit Hall
1:30 p.m. – 5:00 p.m.	Training Sessions.....	Hilton & PBCCC

3:00 p.m. – 3:30 p.m.	Break in Exhibit Hall	PBCCC, Level 1, Exhibit Hall
3:00 p.m. – 4:00 p.m.	FHCA Emergency Preparedness Council	Hilton, Lilly
5:00 p.m. – 6:00 p.m.	Reception in Exhibit Hall.....	PBCCC, Level 1, Exhibit Hall
6:15 p.m. – 7:30 p.m.	American Red Cross Disaster Services Meeting.....	Hilton, Coral D

Thursday, May 12

8:00 a.m. – 5:00 p.m.	Registration Opens.....	PBCCC, Level 1
8:00 a.m. – 8:30 a.m.	Morning Beverages	PBCCC, Level 1, Exhibit Hall
8:00 a.m. – 5:00 p.m.	Social Media Lounge	PBCCC, Level 1
8:00 a.m. – 12:00 p.m.	Exhibits.....	PBCCC, Level 1, Exhibit Hall
8:30 a.m. – 10:00 a.m.	Workshops.....	Hilton & PBCCC
8:30 a.m. – 5:00 p.m.	Media Room	PBCCC, Level 1, Room 1J/K
10:00 a.m. – 11:30 a.m.	Break and Dedicated Exhibit Hall Time	PBCCC, Level 1, Exhibit Hall
11:45 a.m. – 1:30 p.m.	Awards Luncheon.....	PBCCC, Level 2, Grand Ballroom
1:30 p.m. – 5:00 p.m.	Workshops.....	Hilton & PBCCC
3:00 p.m. – 3:30 p.m.	Break	PBCCC, Level 1
5:30 p.m. – 7:00 p.m.	FLVOAD Meeting.....	Hilton Coral D/E

Friday, May 13

8:00 a.m. – 8:30 a.m.	Morning Beverages	PBCCC, Level 1
8:30 a.m. – 12:00 p.m.	Workshops.....	Hilton & PBCCC
8:30 a.m. – 12:30 p.m.	Media Room	PBCCC, Level 1, Room 1J/K
10:00 a.m. – 10:30 a.m.	Break	PBCCC, Level 1

MOBILE APP

This year we have retired the paper evaluation forms. The session and presenter evaluations can now be completed directly through the mobile app. It is important to get your feedback on all sessions and speakers in order for the GHC to make improvements and offer a top rate attendee experience.

We encourage you to download the app to become familiar with all events offered at this year’s conference. Search GHC2022 in the App Store or in Google Play.

Or use the QR Code for the online version of the app.



36th Annual Governor's Hurricane Conference[®]

General Session

Wednesday, May 11, 2022

Palm Beach County Convention Center

Grand Ballroom

8:45 a.m. – 11:00 a.m.

Moderator

Bill Johnson, RN

Florida Emergency Management Association

Honor Guard/ Pledge of Allegiance

Palm Beach County Fire Rescue

National Anthem

Alexander Drefoos School of the Arts

Welcome

Robert Weinroth

Mayor

Palm Beach County

Governor Ron DeSantis

State of Florida

Kenneth Graham

Director

National Hurricane Center

Kevin Guthrie

Director

Florida Division of Emergency Management

Earl Eues, Jr.

Director

Terrebonne Parish Homeland Security and Emergency Preparedness (Louisiana)

Deanne Criswell

Administrator

Federal Emergency Management Agency

36th Annual Governor's Hurricane Conference[®]

Awards Luncheon

Palm Beach County Convention Center

Grand Ballroom

Thursday, May 12, 2022

11:45 a.m. - 1:30 p.m.

Invocation:

Chief Jeremy Hurd, Chaplain

Palm Beach County Fire Rescue Department

Lunch

Memorial Honors

Awards Presentations

Governor's Hurricane Conference[®]

Members of the Board of Directors

Dr. Shrink⁺
INTERNATIONAL SHRINK WRAP SUPPLIER

Supplying the largest selection of shrink wrap sizes available, perfect to fit any disaster relief project or application!

HURRICANE & DISASTER WRAP

Wholesale Pricing Available
Become a preferred vendor now at: dr-shrink.com

MADE IN AMERICA
QUALITY ASSURED

dr-shrink.com
800.968.5147
231.723.2685
315 Washington St.
Manistee, MI 49660

EXHIBIT HALL MAP

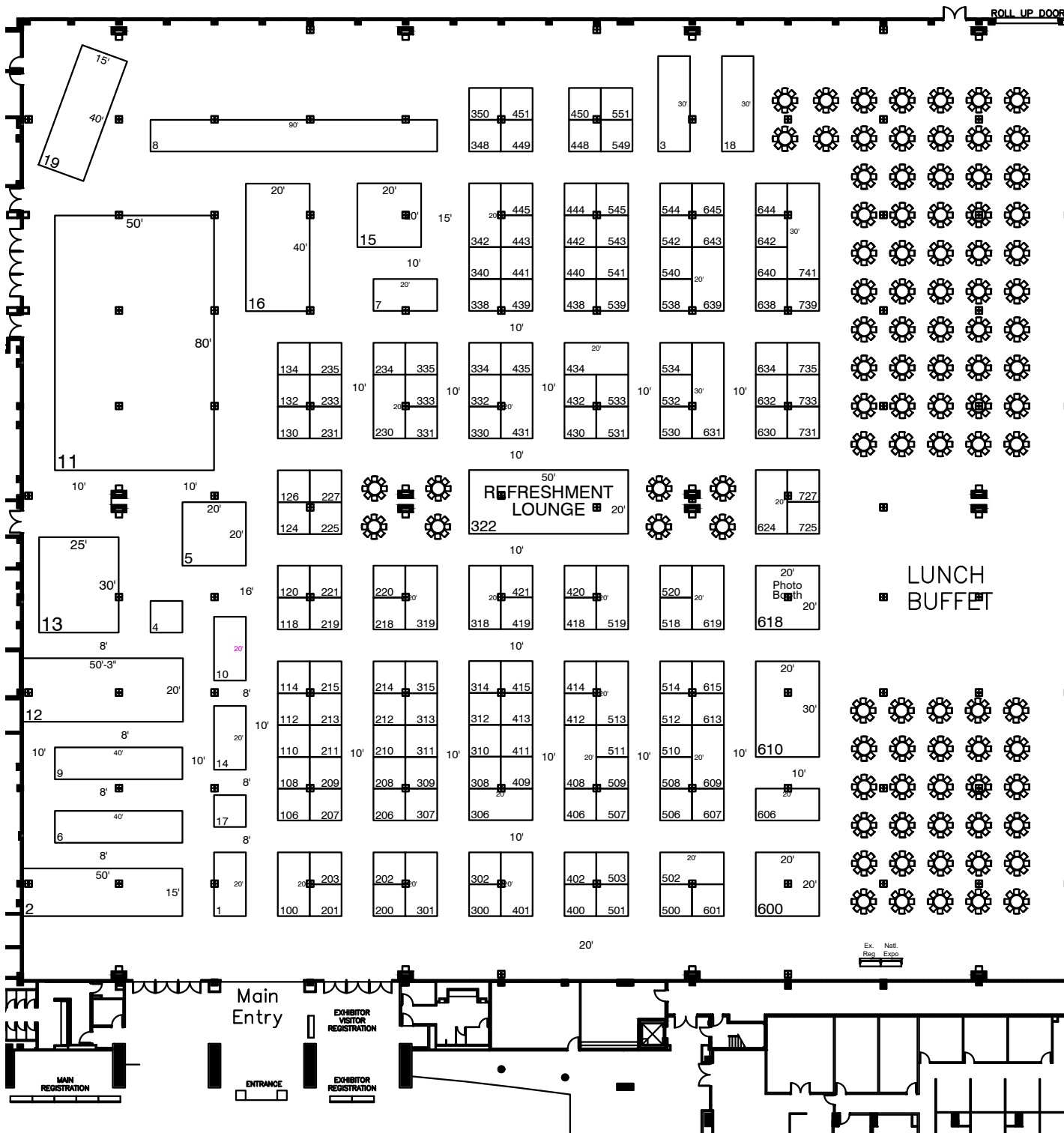

36th Annual Governor's Hurricane Conference®

EXHIBITORS

Company	Booth	
AEM.....	435	Emergency Response Fueling Services, LLC Veh 9
Aggreko	338	Ernst & Young LLP
All Traffic Solutions.....	507	Everbridge
American Portable Air, Inc.	309	EVI - Emergency Vehicles, Inc. Veh 2
AQI Services.....	402	Exeter Architectural Products
Arena Americas	430	FDOT / FL511
AshBritt, Inc.	421	FirstNet.....
Barry University	440	FlaWARN.....
Bergeron Emergency Services, inc.	100	FLOOD RISK AMERICA.....
BK Technologies	332	FloodBreak
Blue Can Water	632	Floodproofing.com.....
BMS CAT	124	Florida International University - Academy for International Disaster Management
BOLDplanning	221	Florida Power & Light Company.....
Bosma Enterprises	409	Florida Public Utilities
Bridgford Foods Corporation	120	FORTS SERVICES
Brief Relief.....	541	Frontline Communications.....
Brizo Construction	610	FSI NORTH AMERICA®
Center for Independent Living of N. Central FL.....	442	GA Foods.....
CentrAlert, Inc.....	615	Garner Environmental Services, Inc.....
CERES ENVIRONMENTAL SERVICES	725	Genasys Inc.....
Chef Minute Meals.....	520	General Services Administration - Federal Acquisition Service- CASE.....
Columbia Southern University	334	Global Emergency Response, Inc.
Cotton Logistics	502	Global Sourcing Solutions
Cradlepoint	445	Grainger.....
Crisis Housing Solutions. A Division of Adopt a Hurricane Family, Inc.	Veh 19	Grannys Alliance Holdings Inc.....
Crisis Track.....	444	GrantWorks, Inc.....
CrowderGulf	218	Guest Communications Corporation (GCC).....
Custom Tree Care, Inc.	307	Gulf Coast State College TEMPEST
D&J Enterprises, Inc.....	331	Halosil International, Inc.
DebrisTech, LLC	306	Horizon Signal Technologies, Inc.
Deloitte	300	Hormel Foods Corporation
Department of Business & Professional Regulation...	532	Hull's Environmental Services
Deployed Resources, LLC.....	118	IEM
Doodie Calls, INC	609	Integrity Medical Solutions.....
DP&O / eXACT Recovery.....	624	International Association of Emergency Managers
Dr. Shrink, Inc.	203	Jaguar Fueling Services
DRC Emergency Services, LLC	200	JR Evans Engineering
Duncan-Parnell.....	735	Kane Innovations, Inc.....
Eagle Rising Food Solutions	644	Komptech Americas.....
Eisman & Russo, Inc	512	Krucial Staffing
Ellipse Global.....	510	Landfall Strategies, LLC

LDV, Inc.	Veh 12	Royal Plus, Inc.....	600
Lex Products.....	503	Safeware Inc.....	518
Lipsey Logistics Worldwide LLC.....	230	Satcom Direct.....	509
Lodging Solutions and Industrial Tent Systems.....	Veh 20	SATPHONESTORE.....	312
Luxfer Magtech (HeaterMeals).....	432	School of Public Administration University of Central Florida.....	533
Macro Companies Inc.....	319	SERVPRO of West Palm Beach	234
Merit.....	214	Signal Power	5
Mersino.....	412	SkyBase Communications LLC	302
Metric Consulting, LLC	634	SLSCO, LTD.....	202
Midland Radio Corporation.....	415	Southern Disaster Recovery.....	400
Military Battery Systems, Inc.	201	SPOT COOLERS	220
MLU Services	631	SUN COAST RESOURCES, INC.....	606
Morbark, LLC.....	318	Sunbelt Rentals	401
MRE STAR	308	TAW Power Systems.....	619
Mutualink, Inc.	545	Taylor Power Systems, Inc.	350
MWI Pumps.....	227	Tetra Tech, Inc.	206
National Structures Events and Services	126	TFR Enterprises, Inc.....	212
Nomad GCS	Veh 18	The Eagles' Wings Foundation.....	451
Nova Southeastern University	413	The Sandbagger, LLC	739
NRC Gulf Environmental Services, Inc.....	210	Thompson Consulting Services, LLC	313
OnSolve.....	330	Thunder Creek Equipment	439
Operation BBQ Relief.....	108	Tidal Basin.....	414
PANTROPIC POWER, INC.	601	Tigercat Industries Inc.	419
PARAMOUNT POWER	508	Tradewinds Power Corp	420
PEAKE.....	543	Traube Tents & Structures.....	112
Pelsue Company	607	Trident Systems Incorporated	134
Phillips & Jordan, Inc.	208	Trojan Battery	132
Plum Laboratories, Inc.....	106	True North Emergency Management, LLC.....	514
PODS ENT LLC.....	500	U.S. Flood Control	301
Portable Air.....	411	UF Fire & Emergency Services	340
Power Assemblies	348	United Rentals PHVAC.....	335
Powertac USA	213	USA Up Star	Veh 11
Precise Kit Promotions Inc	639	Verizon.....	235
Prism Lighting Services, LLC	4	WeatherSTEM Inc.	638
Progress Solar Solutions	14	Western Shelter.....	225
Pronto Recovery.....	613	Witt O'Brien's.....	519
ProPac, Inc.	7	WrapRoof	513
PS Flood Barriers	114	WSP USA.....	406
Puff 'n Stuff Catering, LLC.....	642		
Ranco Response	511		
Rave Mobile Safety	418		
Ready America, Inc.	434		
ReadyWise Inc.	211		
Rescue 42	538		
Ring Power Corp	342		
RM Cheek Consulting LLC	449		
Rostan Solutions	441		

EXHIBIT HALL EVENTS

Please visit the many vendors in the Exhibit Hall who support the GHC!



Connect 2 Win!

WIN a \$200 Amazon Gift Card from GHC - 5 Winners!

CONNECT with EXHIBITORS to WIN!

Participating exhibitors have purchased a limited number of entry tickets. Exhibitors will distribute tickets (at their discretion) to attendees who make a 'connection' with them about their product or service. Fill out your tickets and put them in the raffle drum in the center of the exhibit hall. Five winners drawn during Exhibit Hall hours. You need not be present to win and can enter multiple tickets!

Participating exhibitors are listed on the MOBILE APP
and the flyer in your portfolio!

Green Screen Photo Booth

While visiting our many exhibitors in the Exhibit Hall, stop by the Green Screen Photo Booth where you will have the opportunity to picture yourself...literally... in the midst of a raging hurricane (and other disasters), and demonstrate to the world just how you would react to the experience. But wait...there's more! You will also be supplied with a photographic memento (a 4"x6" photo and on-site access to electronic format) that can be used not only to commemorate the event, but also to impress others with your bravery (hopefully!) and your preparedness prowess!

This is underwritten as a free service to attendees by:



2022 Training Sessions

- TS1. Homeland Security Exercise and Evaluation Program (HSEEP) (L146)
- TS2. Intermediate Emergency Operations Center Functions (G2300)
- TS3. Mitigation for Emergency Managers (G393)
- TS4. Looking For a Job? Now What Do You Do?
- TS5. Emergency Planning (G235)
- TS6. Management of Spontaneous Volunteers in Disasters (G489)
- TS7. Tropical Meteorology 1: FEMA/EMI 311 – Hurricane Readiness
- TS8. Tropical Meteorology 2: Hurricane Hazards: Local Threats, Impacts and Messaging
- TS9. Understanding Inland Tropical Cyclone Winds
- TS10. NWS Support Services - Weather Support from Preparedness to Recovery
- TS11. *Health Care Emergency Management***
- TS12. Incident Command System/Emergency Operations Center Interface (G191)
- TS13. All-Hazards Position Specific Liaison Officer (L956)
- TS14. Multi-Hazard Emergency Planning for Schools (FL364)
- TS15. Flood Fight Operations (G361)
- TS16. Recovery from Disaster, the Local Government Role (G205)
- TS17. *Crucial Conversations: Tools For Talking When Stakes Are High***
- TS18. Unmanned Aircraft Systems in Disaster Management (AWR345)
- TS19. Recovery Funding – It's All Connected
- TS20. Planning for Disaster Debris Management (MGT460)
- TS21. Emergency Operations Center Tour
- TS22. Emergency Operations Center Tour (repeat)
- TS23. Volunteers and Donations (G288)
- TS24. Introduction to HURREVAC
- TS25. *Applying Web-Based HURREVAC***
- TS26. Response Planning for People with Access and Functional Needs in Rural America (MGT403)
- TS27. Florida's Recovery Obligation Calculation (F-ROC)
- TS28. AlertFlorida (Incident Communications) and IPAWS Training
- TS29. Florida Statewide Regional Evacuation Studies Training
- TS30. Crisis Leadership and Decision Making (MGT340)
- TS31. Introduction to the New Integrated Planning Process (formerly known as the TEPW)
- TS32. Psychological First Aid: Helping Others in Times of Stress
- TS33. Individual Assistance Program Update
- TS34. Using the Infrastructure Resilience Planning Framework to Strengthen Our Community's Foundation From Hurricane Impacts
- TS35. Disaster Response for Floodplain Managers
- TS36. *Effective Social Media Strategies During Times of Crisis***
- TS37. Disaster Housing Recovery and Mitigation Programs
- TS38. FDEM Standardization of FEMA Public Assistance
- TS39. PAWsitive Information About Service Animals
- TS40. Palm Beach County's Debris Management Plan: Tour the SWA's Renewable Energy Facility 2

2022 Training Session Descriptions

TS1. Homeland Security Exercise and Evaluation Program (HSEEP) (L146) – Organized by John Wilson

Sunday, May 8, 1:30 p.m. – 5:00 p.m. PBCCC 1D
Monday, May 9, 8:30 a.m. – 5:00 p.m.
Tuesday, May 10, 8:30 a.m. – 5:00 p.m.
Wednesday, May 11, 1:30 p.m. – 5:00 p.m.

The Homeland Security Exercise and Evaluation Program (HSEEP) (L146) course 2021 Version 14.1 will assist in all areas (design, development, conduct, evaluation, and improvement planning) relating to exercises and familiarize participants with the federal guidance and direction to build and maintain self-sustaining exercise programs. HSEEP is a capabilities and performance-based exercise program that provides a standardized methodology and terminology for all exercise areas. Class activities include creating exercise documentation, conducting exercise planning conferences and briefings, and practicing exercise evaluation. Individuals involved in all areas of exercises are encouraged to attend. HSEEP is an interactive course that allows participants to share personal lessons learned while gaining practical experience. Certificates are being issued by the FEMA Emergency Management Institute (EMI). HSEEP is an intermediate-level course and participants should come with a basic understanding of exercise design.

Prerequisites:

IS-120.C: An Introduction to Exercises
IS-130.A: Exercise Evaluation and Improvement Planning

Level: Basic

Limit: 35

TS2. Intermediate Emergency Operations Center Functions (G2300) – Organized by Ivy Baker

Sunday, May 8, 1:30 p.m. – 5:00 p.m. PBCCC 2D
Monday, May 9, 8:30 a.m. – 5:00 p.m.
Tuesday, May 10, 8:30 a.m. – 5:00 p.m.
Wednesday, May 11, 1:30 p.m. – 5:00 p.m.

The E/L/G 2300 Intermediate Emergency Operations Center Functions is a three-day course with the goal of assisting individuals and jurisdictions who desire to develop or improve their Emergency Operation Centers (EOC). By the end of the course, students will be able to demonstrate, through activities and a Final Exam, the managerial and operational roles of the modern-day EOC as a NIMS Command and Coordination functional group operating within a Multiagency Coordination System (MACS).

Prerequisites:

IS0100.C, An Introduction to the Incident Command System, ICS 100
IS2200, Basic Emergency Operations Center Functions
IS0700.B, An Introduction to the National Incident Management System
IS0800.D, National Response Framework, An Introduction

Level: Basic

Limit: 30

TS3. Mitigation for Emergency Managers (G393) – Organized by Ivy Baker

Sunday, May 8, 1:30 p.m. – 5:00 p.m. PBCCC 2E
Monday, May 9, 8:30 a.m. – 5:00 p.m.
Tuesday, May 10, 8:30 a.m. – 5:00 p.m.
Wednesday, May 11, 1:30 p.m. – 5:00 p.m.

This course is designed to enable the non-technical emergency worker to acquire skills in the use of mitigation. The course provides training in how to perform mitigation activities fundamental to reducing and eliminating long-term risk from hazards. It addresses the

important roles of the emergency program manager (or other local government representative) in mitigation: motivator, coordinator, and monitor in local implementation of the National Mitigation Strategy.

Prerequisites:

IS-393.b

Level: Basic

Limit: 30

TS4. Looking For a Job? Now What Do You Do? – Organized by Jessica Geib

Monday, May 9, 8:30 a.m. – 5:00 p.m.

PBCCC 1A

This training session will be a full day class presenting information on how to search for a job and the interviewing process. Presenters for this course will include seasoned emergency managers, experienced in hiring. Discussions will include how to get yourself discovered, developing a successful resume, and facilitating an effective interview. Upon completion of this session, participants will walk away with their resumes reviewed by the presenters and participate in a mock interview process. Participants are required to bring four (4) copies of their updated resume.

Level: Basic

Limit: 40

TS5. Emergency Planning (G235) – Organized by Jeff Goldberg

Monday, May 9, 8:30 a.m. – 5:00 p.m.

PBCCC 1B

Tuesday, May 10, 8:30 a.m. – 5:00 p.m.

Wednesday, May 11, 1:30 p.m. – 5:00 p.m.

This FEMA course offers training in the fundamentals of the emergency planning process, including the rationale behind planning. It will develop the capability for effective participation in the all-hazard emergency operations planning process to save lives and protect property threatened by disaster. This is an elective course for the FEMA Advanced Professional Series Certificate. 16 contact hours in the response mission area will be awarded for FEPA certification.

Level: Basic

Limit: 35

TS6. Management of Spontaneous Volunteers in Disasters (G489) – Organized by Christy Rojas

Monday, May 9, 8:30 a.m. – 5:00 p.m.

PBCCC 1C

This course is designed to identify those issues and challenges in the management of spontaneous volunteers; how to manage these volunteers, develop a plan for your community; and learn how to utilize and operate a Volunteer Reception Center (VRC). This course will also discuss best practices for managing volunteers including their use by VOADs.

Level: Basic

Limit: 30

TS7. Tropical Meteorology 1: FEMA/EMI 311 – Hurricane Readiness – Organized by Pablo Santos

Monday, May 9, 8:30 a.m. – 5:00 p.m.

Hilton Coral Ballroom C

This one-day course is an introduction to the National Hurricane Center's forecast procedures and products, and FEMA's National Hurricane Program's tools for how to incorporate them into planning and response. Topics include hurricane basics, forecast uncertainty, and NHC and NWS products. The course also covers the storm surge hazard, readiness checklists, decision aids, and evacuation planning. This course is intended for persons responsible for developing or revising hurricane preparedness plans and procedures for businesses, government agencies, and coastal communities.

Level: Basic

TS8. Tropical Meteorology 2: Hurricane Hazards: Local Threats, Impacts and Messaging
– Organized by Pablo Santos

Tuesday, May 10, 8:30 a.m. – 5:00 p.m. Hilton Coral Ballroom C

As the National Hurricane Center provides hurricane forecasts and watches/warnings along the coast, WFOs subsequently provides downscaled and locally refined forecasts along with additional inland watches/warnings. Altogether, hurricane information is locally tailored to support decision-making which meets the needs of coastal, inland, and marine interests alike. Detailed threat assessments that account for forecast magnitude and uncertainty for individual hazards, as well as projections of corresponding potential impacts are made available. This session will explore the local threat assessment process and the distilled message that falls from it including interactive exercises. Special emphasis will be given to effective methods for communicating assessed risk to decision-makers, as well as its reporting to public safety messaging. Certain challenges to public messaging will be outlined along with perspectives from ongoing social science studies and the ever-increasing role of social media.

Level: Basic

TS9. Understanding Inland Tropical Cyclone Winds – Organized by Pablo Santos

Wednesday, May 11, 1:30 p.m. – 3:00 p.m. Hilton Coral Ballroom C

This presentation and panel discussion will discuss how tropical cyclone wind fields are impacted by terrain (frictional effects) and especially by rivers, lakes, open fields, estuary systems, woods and urban areas. We will present wind fields from Tropical Storm Irma, Hurricane Matthew and a hypothetical major event impacting portions of Florida. We will also discuss how real hurricane wind fields act vs. the simplified HURREVAC presentation of winds. Last, but not least, why it is so important to account for uncertainty and not focus on the precision of a deterministic-based forecast. This session is highly recommended for emergency managers, key decision-makers and executive committees/MAC groups.

Level: Basic

TS10. NWS Support Services - Weather Support from Preparedness to Recovery – Organized by Pablo Santos

Wednesday, May 11, 3:30 p.m. – 5:00 p.m. Hilton Coral Ballroom C

National Weather Service meteorologists are prepared to assist our emergency response partners through all phases of a tropical disaster, including pre-season preparedness, disaster planning, incident response and post-storm recovery. Our forecast and interpretive services leverage complex meteorological information that can help you and your response teams make appropriate and efficient disaster response decisions. This session will interactively showcase diverse services your NWS can provide during tropical season planning, preparedness, storm response, and recovery. We will also actively demonstrate the various communication mediums we utilize to keep you and your teams informed of the latest critical weather intelligence.

Level: Basic

TS11. **Health Care Emergency Management** – Organized by John Wilgis

Monday, May 9, 8:30 a.m. – 5:00 p.m. PBCCC 1E
Tuesday, May 10, 8:30 a.m. – 5:00 p.m.
Wednesday, May 11, 1:30 p.m. – 5:00 p.m.

The Healthcare Emergency Management course is a two-day classroom-based course that provides health care emergency coordinators training related to emergency management principles, key components, and regulatory concepts of emergency preparedness and response programs. It furthers the student's knowledge with an overview of the agencies, organizations, and systems in Florida that they will work with. This course ensures that Florida's health care emergency management professionals are equipped with the most current information, standards, regulations, and best practices in the health care emergency management community.

Level: Advanced

Limit: 35

TS12. Incident Command System/Emergency Operations Center Interface (G191) – Organized by Ivy Baker

Monday, May 9, 8:30 a.m. – 5:00 p.m. PBCCC 1L

The goal of this professional development course, Incident Command System/Emergency Operations Center Interface (G191), is to enable the students to develop an effective interface between the Incident Command/Unified Command and the Emergency Operations Center by applying National Incident Management System principles.

Prerequisites:

IS0100.C, An Introduction to the Incident Command System, ICS 100
IS2200, Basic Emergency Operations Center Functions
IS0700.B, An Introduction to the National Incident Management System
IS0800.D, National Response Framework, An Introduction

Level: Basic

Limit: 30

TS13. All-Hazards Position Specific Liaison Officer (L956) – Organized by John Wilson

Monday, May 9, 8:30 a.m. – 5:00 p.m. PBCCC 2A
Tuesday, May 10, 8:30 a.m. – 5:00 p.m.

This course will provide local and state emergency management/emergency service personnel with the following knowledge base; roles and responsibilities of the Liaison Officer (LOFR) as a member of the Command Staff; roles and responsibilities of the Liaison Officer with regard to Stakeholders; types of communication and work-location requirements for a given incident; process and relevant parties involved in incident information flow, including the role of Assistant Liaison Officers; Liaison Officer's contributions to the NIMS incident action planning process; demobilization process as it relates to the duties of the LOFR. This session will include exercise, simulations, discussions and a final exam.

Level: Basic

Limit: 30

TS14. Multi-Hazard Emergency Planning for Schools (FL364) – Organized by John Wilson

Monday, May 9, 8:30 a.m. – 5:00 p.m. PBCCC 2B
Tuesday, May 10, 8:30 a.m. – 5:00 p.m.

This training session provides schools with knowledge, skills and tools needed to refine and develop an all-hazards Emergency Operations Plan (EOP) and to identify how to train and exercise the school EOP. This course follows the guidance set forth in the FEMA Comprehensive Preparedness Guide CPG 101, for developing emergency operations plan and explains how to use the National Incident Management System (NIMS) as the foundation for planning and building partnerships with outside agencies such as law enforcement, fire, and emergency management. Participants should bring a copy of their schools Emergency Operations Plan to the course.

Prerequisites:

IS-100: SC and IS-700 recommended

Level: Basic

Limit: 30

TS15. Flood Fight Operations (G361) – Organized by Ivy Baker

Monday, May 9, 8:30 a.m. – 5:00 p.m. PBCCC 2C
Tuesday, May 10, 8:30 a.m. – 5:00 p.m.
Wednesday, May 11, 1:30 p.m. – 5:00 p.m.

This course is for emergency managers, public works officials, levee district representatives, and others responsible for planning, preparing, and managing the response to a flood. Using a combination of lectures, discussions, activities, and exercises, this course

will take participants through the complete process from well before the flood, to the clean up afterwards. Officials from every community at risk of flooding should take this training.

Level: Basic

Limit: 30

TS16. Recovery from Disaster, the Local Government Role (G205) – Organized by Ivy Baker

Monday, May 9, 8:30 a.m. – 5:00 p.m. PBCCC 2F

Tuesday, May 10, 8:30 a.m. – 5:00 p.m.

Wednesday, May 11, 1:30 p.m. – 5:00 p.m.

This course covers foundational concepts in disaster recovery and the latest guidance on recovery planning. Participants will assess either their own recovery plan or a sample against this national planning guidance. Following that, participants will discuss how a disaster recovery effort can be organized, managed, and led along with the types of challenges faced by recovery managers. Scenario activities throughout the course give participants the opportunity to target information strategies and address local capabilities and challenges. They will also analyze lessons learned from Joplin, Missouri.

Level: Basic

Limit: 30

TS17. Crucial Conversations: Tools For Talking When Stakes Are High – Organized by John Vicenti

Monday, May 9, 8:30 a.m. – 5:00 p.m. Hilton Coral Ballroom A

Tuesday, May 10, 8:30 a.m. – 5:00 p.m.

Whenever you are not getting the results you are looking for, it is likely a crucial conversation is keeping you stuck. Whether it is a problem with poor quality, missed deadlines, decreased client satisfaction, or a strained relationship with partners, if you cannot talk honestly with nearly anybody about almost anything, you can expect poor results. Crucial Conversations teaches skills for creating alignment and agreement by fostering open dialogue around high-stakes, emotional, or risky topics, at all levels of your organization. By learning how to speak and be heard (and encouraging others to do the same), you will surface the best ideas, make the highest-quality decisions, and then act on your decisions with unity and commitment.

Level: Advanced

Limit: 28

TS18. Unmanned Aircraft Systems in Disaster Management (AWR345) – Organized by Ivy Baker

Monday, May 9, 8:30 a.m. – 5:00 p.m. Hilton Coral Ballroom B

This course is an introduction to Unmanned Aircraft Systems (UAS) use in disaster management, from mitigation and preparedness to response and recovery. It is intended to help participants gain a basic understanding of UAS; learn the general concepts to help an agency build a successful UAS program; learn the importance of engaging the local community; understand the need to ensure that privacy issues, civil rights, and civil liberties are thoroughly addressed; identify when UAS would enhance a disaster mission; and understand the basics of UAS types and sensors. The overall course goal is to provide a basic overview of UAS so that agencies can learn the first steps in determining if UAS are right for their work.

Participants will learn what is covered under UAS regulations, who may operate UAS, what FAA authorization allows, and what the major issues are for UAS integration. The course materials will familiarize participants with the main types and capabilities of rotary and fixed-wing UAS, as well as the types of payloads and missions that generally are best for each with examples of how certain payloads have been or could be used in relevant situations to aid in disaster management.

Prerequisites:

Students must also register for this course with the National Disaster Preparedness Training Center at <https://ndptc.hawaii.edu/training/>

Level: Basic

Limit: 45

TS19. Recovery Funding—It's All Connected – Organized by Jeff Goldberg

Monday, May 9, 8:30 a.m. – 5:00 p.m. Hilton Coral Ballroom E
Tuesday, May 10, 8:30 a.m. – Noon

In this session, we will discuss the FEMA PA process, required documentation, potential difficulties, common mistakes, ever changing FEMA guidance, and the appeals process. We will also cover best practices for pre-event plans, processes, and policies that are important to a successful submittal. Example forms and written guidance will be provided. Topics will also include reporting, insurance, and environmental and historic preservation.

Level: Basic
Limit: 35

TS20. Planning for Disaster Debris Management (MGT460) – Organized by Ivy Baker

Monday, May 9, 8:30 a.m. – 5:00 p.m. Hilton Coral Ballroom D

This management-level instructor-led course will provide lectures, knowledge checks, and course module tools/activities on pre-disaster debris management planning. The focus of the course is to identify debris management plan components and best planning practices using existing plan examples and case studies and to draft an outline of a debris management plan. This course will empower participants to create pre-disaster debris management plans for their own communities.

Prerequisites:

Students must also register for this course with the National Disaster Preparedness Training Center at <https://ndptc.hawaii.edu/training/>

Level: Basic
Limit: 45

TS21. Emergency Operations Center Tour – Organized by Bill Johnson, RN

Monday, May 9, 8:00 a.m. – 5:00 p.m. Offsite

A well-designed and fully functional emergency operations center (EOC) is critical for the successful management of disasters. This six-hour training session includes visits to three (3) area EOCs including the Palm Beach County EOC, the City of West Palm Beach EOC, and the South Florida Water Management District EOC. Presentations will include information on organizing, staffing, and operating these facilities. Best practices will also be shared.

Transportation and lunch will be provided.

Level: Basic
Limit: 40

TS22. Emergency Operations Center Tour (repeat) – Organized by Bill Johnson, RN

Tuesday, May 10, 8:00 a.m. – 5:00 p.m. Offsite

Repeat of TS21

Level: Basic
Limit: 40

TS23. Volunteers and Donations (G288) – Organized by Christy Rojas

Tuesday, May 10, 8:30 a.m. – 5:00 p.m. PBCCC 1C
Wednesday, May 11, 1:30 p.m. – 5:00 p.m.

This training will support local governments and their emergency management partners in preparing for, responding to, and recovering from disaster events at the local level. The course is designed to strengthen the abilities of local jurisdictions to successfully

prepare for and handle volunteer and donations management issues that may arise. The course content and activities may also serve as a template, thereby enhancing uniformity in addressing areas of donated unsolicited goods, unaffiliated volunteers, and un-designated cash. This training also provides information regarding the states volunteer and donations management responsibilities, which are designed to help build relationships between government and non-governmental organizations.

Level: Basic
Limit: 30

TS24. Introduction to HURREVAC – Organized by John Wilson

Tuesday, May 10, 8:30 a.m. – Noon PBCCC 1L

The National Hurricane Program's Decision Support Tool (HURREVAC) is a free web-based platform available to government emergency managers that provides evacuation timing guidance. HURREVAC combines real-time National Hurricane Center forecast products and storm surge modeling with evacuation clearance times from Hurricane Evacuation Studies. The focus of the Introduction to HURREVAC training session is to discuss HURREVAC features and functionality and provide a demonstration of the user interface.

Prerequisites:

Students will need to **bring their own computer** and **register for a web-based HURREVAC account**

Level: Basic
Limit: 50

TS25. Applying Web-Based HURREVAC – Organized by John Wilson

Tuesday, May 10, 1:30 p.m. – 5:00 p.m. PBCCC 1L

The National Hurricane Program's Decision Support Tool (HURREVAC) is a free web-based platform available to government emergency managers that provides evacuation timing guidance. HURREVAC combines real-time National Hurricane Center forecast products and storm surge modeling with evacuation clearance times from hurricane evacuation studies. The Applying Web-Based HURREVAC training session's purpose is to demonstrate how to apply decision support functionality based on hurricane scenarios, including hurricane hazard risk assessment and evacuation timing guidance.

Prerequisites:

Students will need to **bring their own computer** and **register for a web-based HURREVAC account**

Level: Advanced
Limit: 50

TS26. Response Planning for People with Access and Functional Needs in Rural America (MGT403)
– Organized by Ivy Baker

Tuesday, May 10, 8:30 a.m. – 5:00 p.m. Hilton Coral Ballroom B

This is a planning and management-level course. This course will assist in preparing communities to meet the assistance and safety needs of older adults, and people with access and functional needs during a crisis event in rural and tribal communities using an approach with the Department of Homeland Security's (DHS) Whole Community initiative. Due to the expected diverse student population, general information regarding crisis planning and response (ICS), National Incident Management System (NIMS), etc.) will be discussed, flowing into a narrower discussion regarding the needs and care issues of older adults. Included in the discussion are short- and long-term care, pet care, medication, and the need for durable medical equipment and healthcare. The issue of individuals from assisted-living and nursing homes will be emphasized in lessons learned from various disasters.

Attendees must also register for this course with the Rural Domestic Preparedness Consortium at <https://ruraltraining.org/course/MGT-403/?scheduled=true&id=4476>

Continued on page 20

2022 TRAINING SESSIONS

Room	Sunday, May 8 th	
	1:30 p.m. - 5:00 p.m.	
1D	TS1. Homeland Security Exercise and Evaluation Program (L146) – day 1 (limit 35)	
2D	TS2. Intermediate Emergency Operations Center Functions (G2300) – day 1 (limit 30)	
2E	TS3. Mitigation for Emergency Managers (G393) – day 1 (limit 30)	
Room	Monday, May 9 th	
	8:30 a.m. 5:00 p.m.	
1A	TS4. Looking For a Job? Now What Do You Do? (limit 40)	
1B	TS5. Emergency Planning (G235) – day 1 (limit 35)	
1C	TS6. Management of Spontaneous Volunteers in Disasters (G489) (limit 30)	
1D	TS1. Homeland Security Exercise and Evaluation Program (L146) – day 2 (limit 35)	
1E	TS11. Health Care Emergency Management – day 1 (limit 35)	
1L	TS12. Incident Command System/Emergency Operations Center Interface (G191) (limit 30)	
2A	TS13. All-Hazards Position Specific Liaison Officer (L956) - day 1 (limit 30)	
2B	TS14. Multi-Hazard Emergency Planning for Schools (FL364) – day 1 (limit 30)	
2C	TS15. Flood Fight Operations (G361) – day 1 (limit 30)	
2D	TS2. Intermediate Emergency Operations Center Functions (G2300) – day 2 (limit 30)	
2E	TS3. Mitigation for Emergency Managers (G393) – day 2 (limit 30)	
2F	TS16. Recovery From Disaster, the Local Government Role (G205) – day 1 (limit 30)	
Hilton Coral A	TS17. Crucial Conversations: Tools For Talking When Stakes Are High – day 1 (limit 28)	
Hilton Coral B	TS18. Unmanned Aircraft Systems in Disaster Management (AWR345) (limit 45)	
Hilton Coral C	TS7. Tropical Meteorology 1: FEMA/EMI 311 – Hurricane Readiness	
Hilton Coral D	TS20. Planning for Disaster Debris Management (MGT460) (limit 45)	
Hilton Coral E	TS19. Recovery Funding–It's All Connected – day 1 (limit 35)	
Off-Site	TS21. Emergency Operations Center Tour (bus loads at 8:00 a.m.) (limit 40)	
Room	Tuesday, May 10 th	
	8:30 a.m. - Noon	1:30 p.m. -5:00 p.m.
1A	TS30. Crisis Leadership and Decision Making (MGT340) (limit 35)	
1B	TS5. Emergency Planning (G235) – day 2 (limit 35)	
1C	TS23. Volunteers and Donations (G288) – day 1 (limit 30)	
1D	TS1. Homeland Security Exercise and Evaluation Program (L146) – day 3 (limit 35)	
1E	TS11. Health Care Emergency Management – day 2 (limit 35)	
1G/1H/1I		TS27. Florida's Recovery Obligation Calculation (F-ROC)
1L	TS24. Introduction to HURREVAC (limit 50)	TS25. Applying Web-Based HURREVAC (limit 50)
2A	TS13. All-Hazards Position Specific Liaison Officer (L956) – day 2 (limit 30)	
2B	TS14. Multi-Hazard Emergency Planning for Schools (FL364) – day 2 (limit 30)	
2C	TS15. Flood Fight Operations (G361) – day 2 (limit 30)	
2D	TS2. Intermediate Emergency Operations Center Functions (G2300) – day 3 (limit 30)	
2E	TS3. Mitigation for Emergency Managers (G393) – day 3 (limit 30)	
2F	TS16. Recovery From Disaster, the Local Government Role (G205) – day 2 (limit 30)	
Hilton Coral A	TS17. Crucial Conversations: Tools For Talking When Stakes Are High – day 2 (limit 28)	
Hilton Coral B	TS26. Response Planning for People with Access and Functional Needs in Rural America (MGT403) (limit 40)	
Hilton Coral C	TS8. Tropical Meteorology 2: Hurricane Hazards: Local Threats, Impacts and Messaging	
Hilton Coral D	TS28. AlertFlorida (Incident Communications) and IPAWS Training	TS29. Florida Statewide Regional Evacuation Studies Training
Hilton Coral E	TS19. Recovery Funding–It's All Connected – day 2 (limit 35)	
Offsite	TS22. Emergency Operations Center Tour (repeat) (bus loads at 8:00 a.m.) (limit 40)	
Room	Wednesday, May 11 th	
	1:30 p.m. -3:00 p.m.	3:30 p.m. - 5:00 p.m.
1A	TS32. Psychological First Aid: Helping Others in Times of Stress (limit 25)	
1B	TS5. Emergency Planning (G235) – day 3 (limit 35)	
1C	TS23. Volunteers and Donations (G288) – day 2 (limit 30)	
1D	TS1. Homeland Security Exercise and Evaluation Program (L146) – day 4 (limit 35)	
1E	TS11. Health Care Emergency Management – day 3 (limit 35)	
1G/1H/1I	TS38. FDEM Standardization of FEMA Public Assistance	
1L	TS33. Individual Assistance Program Update (limit 50)	
2A	TS34. Using the Infrastructure Resilience Planning Framework to Strengthen Our Community's Foundation From Hurricane Impacts (limit 25)	

2B	TS35. Disaster Response for Floodplain Managers (limit 50)	
2C	TS15. Flood Fight Operations (G361) – day 3 (limit 30)	
2D	TS2. Intermediate Emergency Operations Center Functions (G2300) – day 4 (limit 30)	
2E	TS3. Mitigation for Emergency Managers (G393) – day 4 (limit 30)	
2F	TS16. Recovery From Disaster, the Local Government Role (G205) – day 3 (limit 30)	
Hilton Coral A	TS31. Introduction to the New Integrated Planning Process (formerly known as the TEPW) (limit 40)	
Hilton Coral B	TS37. Disaster Housing Recovery and Mitigation Programs (limit 45)	
Hilton Coral C	TS9. Understanding Inland Tropical Cyclone Winds	TS10. NWS Support Services - Weather Support from Preparedness to Recovery
Hilton Coral D	TS39. PAWsitive Information About Service Animals	
Hilton Coral E	TS36. Effective Social Media Strategies During Times of Crisis (limit 25)	
Offsite	TS40. Palm Beach County's Debris Management Plan: Tour the SWA's Renewable Energy Facility 2 (bus loads at 1:00 p.m.) (limit 40)	

2022 WORKSHOPS

Room	Thursday 8:30 a.m. – 10:00 a.m.	Thursday 1:30 p.m. – 3:00 p.m.	Thursday 3:30 p.m. – 5:00 p.m.	Friday 8:30 a.m. – 10:00 a.m.	Friday 10:30 a.m. - Noon
Palm Beach County Convention Center					
1A	WS101. After the Storm: Debris Management Best Practices	WS113. Improving BRIC, HMGP and Mitigation Funding Outcomes in Florida	WS123. Implementing Mitigation	WS133. Operationalizing After-Action Reports & Improvement Plans	WS142. Private Sector Response Support to EOCs and Field Operations - Successes and Challenges
1B/1C	WS102. Best Practices and Lessons Learned Managing Emergency School Shelters	WS114. Federal ESF #14–Cross-Sector Business and Infrastructure: Supply Chain Coordination	WS124. Exercising for Recovery – A Tale of Two Cities	WS134. Pandemics and Storms and Fires, Oh My! Best Practices in Special Needs Sheltering	WS143. Are You FEPA Certified? If Not, Why Not?
1D/1E	WS103. Planning and Exercise Tools in HURREVAC	WS115. Decision Support Tools for Hurricane Decision Makers–Best Practices	WS125. Hidden in Plain Sight: Including Persons with Disabilities Before, During and After Disasters	WS135. Emergency Press Conferences and Working with American Sign Language Interpreters and Captions	WS144. Atlantic Hurricane Season Prediction/Outlook – 2022
1L	WS104. Making Your Community More Resilient in 2022 and Beyond: A Miami-Dade Case Study	WS116. Logistics Operational Overview	WS126. Florida National Guard		
2A	WS105. Ensuring Disaster Feeding is More Than Just Ham Sandwiches and Casseroles	WS117. Making the Most of Your Resources: Leveraging the Value of Service	WS127. Best Practices in Community Outreach and Education	WS136. What Red Cross Service Delivery Looks Like in 2022	WS145 Academic Research Presentations
2B/2C	WS106. The Power of CERT	WS118. Displaced During a Pandemic: Non-Congregate Sheltering	WS128. What is a VAL and What Can They Do for Me?	WS137. Survivor Assistance: Past, Present and Future	WS146. Navigating Volunteer Engagement in a Post-Pandemic World
2D	WS107. The Value of Big Data in Health Care Response	WS119. Communication Flow of Essential Information During Emergencies for Health Care Personnel	WS129. The Importance of COOP in Health Care	WS138. Health Care Integration Strategies for Non-Acute Health Care Providers	WS147. Patient Movement and Tracking: We Need a Solution!
2E	WS108. Stress Management for Responders	WS120. Aviation Emergency Management: Partners in Preparedness and Response	WS130. UAS in Hurricane Response: Rapid Needs Assessment and Live Streaming Video	WS139. Team Awareness Kit–How It Can Help Emergency Managers Improve Their Situational Awareness	
2F	WS109. Improving Coordination with Energy Providers (Roundtable)				
Hilton West Palm Beach					
Hilton Coral A/B	WS110. Communicating Through Crisis: Proactively Communicating in a Reactive Environment				WS148. Social Media Exercise
Hilton Coral C	WS111. Panel Discussion - Public Messaging of Forecast Uncertainty and the Public's Expectations	WS121. The Potential Storm Surge Flooding Map - What is it? What Does it Represent?	WS131. Catastrophic Inland Flooding: Could it Happen in Florida?	WS140. Watch/Warning Philosophy and Potential Tropical Cyclones	WS149. Hurricane Evacuations: Modeling, Communicating, Procedures & Considerations
Hilton Coral D/E	WS112. Florida's Recovery Obligation Calculation	WS122. Just What Emergency Managers and First Responders Need to Know About Public Assistance	WS132. Trends and Progression of FEMA's Public Assistance Program	WS141. Hurricane Michael–Roadmap to Recovery	WS150. Joint Damage Assessment County Guide: What Does the Process Look Like and How Can My County Prepare?

Prerequisites:

Participant must be a U.S. citizen

IS100.C: Introduction to the Incident Command System (ICS)

IS200.C: ICS for Single Resources and Initial Action Incidents

IS-368: Including People With Disabilities & Others With Access & Functional Needs in Disaster Operations

Level: Basic

Limit: 40

TS27. Florida's Recovery Obligation Calculation (F-ROC) – Organized by Bill Johnson, RN

Tuesday, May 10, 1:30 p.m. – 5:00 p.m.

PBCCC 1G/1H/1I

The Florida Division of Emergency Management (FDEM) is spearheading a first-in-the-nation initiative to reorganize and maximize the Public Assistance process for State and Local governments. Working with experts across the public and private sectors, the Division is facilitating a model where sub-recipients can “buy-up” their initial project obligations by taking concrete steps to mitigate their financial risk. This training session will present the details of the initiative and the Division’s partnership with the Disaster Recovery Contractor’s Association and provide an update on the current status of this project before the 2022 Atlantic Hurricane Season.

Level: Basic

TS28. AlertFlorida (Incident Communications) and IPAWS Training – Organized by Andrew Sussman

Tuesday, May 10, 8:30 a.m. – Noon

Hilton Coral Ballroom D

This training will cover concepts essential for successful use of Incident Communications, Incident Templates, and variables. How new Incidents are launched will be discussed as well as a basic workflow. Training on how to use Incident Communications for IP-AWS notifications and an overview on WEA/EAS/NWEM messages will be demonstrated.

Level: Basic

TS29. Florida Statewide Regional Evacuation Studies Training – Organized by Andrew Sussman

Tuesday, May 10, 1:30 p.m. – 5:00 p.m.

Hilton Coral Ballroom D

This training will focus on questions and discussion from participants. Training will cover the new SharePoint Site, GIS Portal, terms/ definitions, ways to apply the information in the study and use of the Transportation Interface for Modeling Evacuations (TIME).

Level: Basic

TS30. Crisis Leadership and Decision Making (MGT340) – Organized by Ivy Baker

Tuesday, May 10, 8:30 a.m. – 5:00 p.m.

PBCCC 1A

This session is an executive-level presentation for the nation’s senior officials at the city, county, regional, territory, tribal, and state levels. Seminar participants will discuss the strategic- and executive-level issues and challenges related to preparing for, responding to, and recovering from a catastrophic incident. The venue provides an excellent opportunity to share proven strategies and practices and apply lessons learned from past natural and human-made disasters.

Level: Basic

Limit: 35

TS31. Introduction to the New Integrated Planning Process (formerly known as the TEPW/MYTEP)

– Organized by Ian Guidicelli

Wednesday, May 11, 1:30 p.m. – 5:00 p.m.

Hilton Coral Ballroom A

In 2020, FEMA updated guidance that readjusts from the Training and Exercise Planning Workshop (TEPW) to the Integrated Preparedness Planning Workshop (IPPW) and the end product, from the Multi-Year Training and Exercise Plan (MYTEP), to the

Integrated Preparedness Plan (IPP). This interactive session will cover what you need to know about the changes and how to move your organization forward under the new system.

This session is conducted by FEMA EMI Adjunct Instructors who have also conducted statewide TEPWs and published MYTEPs

Level: Basic

Limit: 40

TS32. Psychological First Aid: Helping Others in Times of Stress – Organized by John Vincenti

Wednesday, May 11, 1:30 p.m. – 5:00 p.m. PBCCC 1A

This course enables participants to provide basic care, comfort, and support to people who are experiencing disaster-related stress. The course provides a framework for understanding the factors that affect stress responses in disaster relief workers and the clients they serve, introduces the principles of psychological first aid, and provides guidelines for when to refer a client or fellow relief worker to a disaster mental health worker or partner agency focused on mental health or crisis counseling. Participants engage in practice exercises and a review of the course content.

Upon completion of this course, participants will be able to; recognize the signs of stress in clients, co-workers, and themselves; provide immediate support to people who may be experiencing stress by using psychological first aid principles; obtain disaster mental health support for clients, co-workers, and themselves, when needed.

Level: Basic

Limit: 25

TS33. Individual Assistance Program Update – Organized by John Wilson

Wednesday, May 11, 1:30 p.m. – 5:00 p.m. PBCCC 1L

This training session will provide attendees with an update on changes to the IA program resulting from the latest version of FEMA's Individual Assistance Program and Policy Guide (IAPPG). It will cover changes that expand FEMA support to historically underserved communities and changes to guidelines, including direct housing eligibility and to those applicants living on heir's property who have been denied assistance in the past.

Level: Basic

Limit: 50

TS34. Using the Infrastructure Resilience Planning Framework to Strengthen Our Community's Foundation From Hurricane Impacts – Organized by John Wilson

Wednesday, May 11, 1:30 p.m. – 5:00 p.m. PBCCC 2A

Becoming *stronger together* against hurricane forces requires our interconnected foundation of infrastructure to become more resilient. To help us in this endeavor, the Infrastructure Resilience Planning Framework has been developed to enable users to identify their critical infrastructure, assess related risks, and develop/implement resilience solutions. This session will provide an overview of this framework, how stakeholders can use it to increase the resilience of their infrastructure systems, and how it can be applied to mitigate hurricane impacts. Drawing illustrations from real-world examples, attendees will gain an understanding of the framework's five-step process, its tools and resources, and how to better collaborate with stakeholders; how to use the framework to be more competitive for relevant grant and loan applications; how infrastructure systems are interconnected and dependent upon one another and how this affects resilience; how to incorporate the framework into other plans such as hazard mitigation; who and how to contact for additional information and assistance.

Prerequisites:

Infrastructure Dependency Primer (IDP), accessible at <http://www.cisa.gov/idp>. There is no test, but reviewing this content will help attendees get the maximum value from the instruction.

Level: Basic

Limit: 25

TS35. Disaster Response for Floodplain Managers – Organized by John Wilson

Wednesday, May 11, 1:30 p.m. – 5:00 p.m. PBCCC 2B

This training session's purpose is to acquaint those working in fields related to floodplain management what takes place during damage/disaster assessment and disaster recovery and the role a floodplain manager plays in this process. It highlights basic topics such as building evaluation and personal safety and goes over what a floodplain manager's responsibility in disaster assessment such as high-water marks, the FEMA 50% rule and other specific duties. Certified Floodplain Managers attending the session will receive three (3) CEU credits upon completion by supplying pertinent information such as name and ASFPM CFM certification number at the course offering.

Attendees, if not Certified Floodplain Managers, should at least have a fundamental understanding of these concepts. This includes the aspects related to the FEMA National Flood Insurance Program (NFIP), the usage of flood maps, the understanding of flood zones and how enforcement of NFIP regulations is handled with regards to permitting and inspections.

Prerequisites:

Basic familiarity with floodplain management or associated field

Level: Basic

Limit: 50

TS36. Effective Social Media Strategies During Times of Crisis – Organized by John Jamason

Wednesday, May 11, 1:30 p.m. – 5:00 p.m. Hilton Coral Ballroom E

In this tumultuous age of natural disasters and health care crises, join Palm Beach County Social Media Manager, Jill Alvarez and City of Tampa Fire Rescue Emergency Coordinator, John Antapasis for an insightful training session and discussion on how to effectively manage social media and emergency communications during multiple incidents. Learn to simultaneously push traditional preparedness measures while keeping your constituents informed of the progress of an ongoing pandemic and new safety protocols in place to stop the spread and address the needs of your most vulnerable populations.

Prerequisites:

Basic knowledge of social media best practices

Level: Advanced

Limit: 25

TS37. Disaster Housing Recovery and Mitigation Programs – Organized by John Wilson

Wednesday, May 11, 1:30 p.m. – 5:00 p.m. Hilton Coral Ballroom B

For those needing disaster housing following a hurricane, *Stronger Together* requires Florida's experienced public and private affordable housing providers to leverage resources and strengthen disaster recovery and risk reducing mitigation programs. This session consisting of expert panels will provide training on these matters. First, an overview will be presented of the housing recovery continuum from pre-disaster planning through the various housing response/recovery phases and strategies will be presented to engage stakeholders on important disaster housing and recovery strategies. Then, learn where the housing dollars are including Florida's State and Local Housing Trust Funds and SHIP fund. Understand how to access these funds for temporary rental assistance, emergency repairs, long-term recovery and year-round mitigation. A best practice discussion will feature the results of two major resilience initiatives, Enterprise Community Partners' Keep Safe Miami and the Tampa Bay Regional Planning Council's Resilience Energy Assessment of Communities and Housing (REACH). Both initiatives created new tools to reduce risks to housing infrastructure from sea level rise and coastal flooding and will be explored with information on adapting them for use throughout Florida. The training session is eligible for CE credits of the Florida Chapter of the American Planning Association.

Level: Basic

Limit: 45

TS38. FDEM Standardization of FEMA Public Assistance – Organized by Kimberly Prosser

Wednesday, May 11, 1:30 p.m. – 5:00 p.m. PBCCC 1G/1H/1I

Director Kevin Guthrie, with the Florida Division of Emergency Management (FDEM), is bringing together the industry's best and brightest to create a standardized process for FEMA Public Assistance (PA) in Florida. The Division has established working groups for Category A (Debris) & Category B (Emergency Protective Measures) to identify challenges with the current process and ways to remedy them, and establish a standardized process, including policies, templates, forms and checklists. The goal is to expedite the FEMA PA process from identifying damages, documentation of damages, obligation of projects, reimbursement of expenses through to the closeout of disasters throughout the State of Florida. This session will include a panel of industry experts ready to discuss how the FDEM PA process can be improved for Category A & B throughout the State of Florida.

Level: Basic

TS39. PAWsitive Information About Service Animals – Organized by Andrew Sussman

Wednesday, May 11, 1:30 p.m. – 5:00 p.m. Hilton Coral Ballroom D

A professionally exciting presentation. The audience will learn the different types of jobs service animals provide as well as the legal definition of a service animal and the differences between other types of working animals such as police work, search and rescue, emotional and therapy animals. Live demo at the end.

Level: Basic

TS40. Palm Beach County's Debris Management Plan: Tour the SWA's Renewable Energy Facility 2

– Organized by John Jamason

Wednesday, May 11, 1:00 p.m. – 5:00 p.m. Offsite

This onsite experience will include Solid Waste Authority of Palm Beach County emergency response staff presenting its debris management plan, which includes inter-local agreements with most municipalities, six qualified contractors, and eight potential sites to manage post-storm debris. An overview of how the SWA secures its facilities. A discussion with the waste-to-energy operator on their storm preparation and recovery plans to allow them to continue to operate leading up to, during and after a storm event. There will also be two interactive pieces - the tour to see an almost \$700 million community investment in the cleanest, greenest waste-to-energy facility in North America; and an experience on an interactive touch table to show the importance in recycling right.

Level: Basic

Limit: 40

GOVERNOR'S HURRICANE CONFERENCE®

PO Box 279

Tarpon Springs, Florida 34688-0279

Phone: (727) 944-2724

Fax: (727) 944-2687

Email: rene@flghc.org

Website: www.flghc.org

2022 Workshops

- WS101. After the Storm: Debris Management Best Practices
- WS102. Best Practices and Lessons Learned Managing Emergency School Shelters
- WS103. Planning and Exercise Tools in HURREVAC
- WS104. Making Your Community More Resilient in 2022 and Beyond: A Miami-Dade Case Study
- WS105. Ensuring Disaster Feeding is More Than Just Ham Sandwiches and Casseroles
- WS106. The Power of CERT
- WS107. The Value of Big Data in Health Care Response
- WS108. Stress Management for Responders
- WS109. Improving Coordination with Energy Providers (Roundtable)
- WS110. Communicating Through Crisis: Proactively Communicating in a Reactive Environment
- WS111. Panel Discussion - Public Messaging of Forecast Uncertainty and the Public's Expectations
- WS112. Florida's Recovery Obligation Calculation
- WS113. Improving BRIC, HMGP and Mitigation Funding Outcomes in Florida
- WS114. Federal ESF #14–Cross-Sector Business and Infrastructure: Supply Chain Coordination
- WS115. Decision Support Tools for Hurricane Decision Makers–Best Practices
- WS116. Logistics Operational Overview
- WS117. Making the Most of Your Resources: Leveraging the Value of Service
- WS118. Displaced During a Pandemic: Non-Congregate Sheltering
- WS119. Communication Flow of Essential Information During Emergencies for Health Care Personnel
- WS120. Aviation Emergency Management: Partners in Preparedness and Response
- WS121. The Potential Storm Surge Flooding Map - What is it? What Does it Represent?
- WS122. Just What Emergency Managers and First Responders Need to Know About Public Assistance
- WS123. Implementing Mitigation
- WS124. Exercising for Recovery – A Tale of Two Cities
- WS125. Hidden in Plain Sight: Including Persons with Disabilities Before, During and After Disasters
- WS126. Florida National Guard
- WS127. Best Practices in Community Outreach and Education
- WS128. What is a VAL and What Can They Do for Me?
- WS129. The Importance of COOP in Health Care
- WS130. UAS in Hurricane Response: Rapid Needs Assessment and Live Streaming Video
- WS131. Catastrophic Inland Flooding: Could it Happen in Florida?
- WS132. Trends and Progression of FEMA's Public Assistance Program
- WS133. Operationalizing After-Action Reports & Improvement Plans
- WS134. Pandemics and Storms and Fires, Oh My! Best Practices in Special Needs Sheltering
- WS135. Emergency Press Conferences and Working with American Sign Language Interpreters and Captions
- WS136. What Red Cross Service Delivery Looks Like in 2022
- WS137. Survivor Assistance: Past, Present and Future
- WS138. Health Care Integration Strategies for Non-Acute Health Care Providers
- WS139. Team Awareness Kit–How It Can Help Emergency Managers Improve Their Situational Awareness

- WS140. Watch/Warning Philosophy and Potential Tropical Cyclones
- WS141. Hurricane Michael – Roadmap to Recovery
- WS142. Private Sector Response Support to EOCs and Field Operations - Successes and Challenges
- WS143. Are You FEPA Certified? If Not, Why Not?
- WS144. Atlantic Hurricane Season Prediction/Outlook - 2022
- WS145. Academic Research Presentations
- WS146. Navigating Volunteer Engagement in a Post-Pandemic World
- WS147. Patient Movement and Tracking: We Need a Solution!
- WS148. Social Media Exercise
- WS149. Hurricane Evacuations: Modeling, Communicating, Procedures & Considerations
- WS150. Joint Damage Assessment County Guide: What Does the Process Look Like and How Can My County Prepare?
-

2022 Workshop Descriptions

WS101. After the Storm: Debris Management Best Practices – Organized by Lee Mayfield

Thursday, May 12, 8:30 a.m. – 10:00 a.m. PBCCC 1A

Debris Management is one of the most important and visible aspects of recovery. This session will provide a best practices guide for coordinating recovery efforts between government agencies, storm debris contractors and residents. Topics will include initial damage assessment, rapid activation of debris management sites, coordination of information, working with collection and monitoring vendors, right-of-entry, and the political realities of any large disaster debris operation.

WS102. Best Practices and Lessons Learned Managing Emergency School Shelters – Organized by Jeff Goldberg

Thursday, May 12, 8:30 a.m. – 10:00 a.m. PBCCC 1B/1C

Join us for a panel discussion about going to school one day and opening an emergency shelter the next day. As more emphasis and expectations are being placed on schools to operate emergency shelters, what can we do better? What can school districts in Florida do to support one another?

WS103. Planning and Exercise Tools in HURREVAC – Organized by John Wilson

Thursday, May 12, 8:30 a.m. – 10:00 a.m. PBCCC 1D/1E

The National Hurricane Program's Hurricane Decision Support Tool (HURREVAC) is a free, web-based platform available to government emergency managers. In addition to the operational hurricane tracking information and evacuation timing decision support tools, HURREVAC can be used to support planning efforts and exercise development. In 2021, HURREVAC announced a new capability: a built-in Storm Simulation Tool. Using this tool, HURREVAC users will be able to generate and customize a simulated storm track and forecast products in HURREVAC and interact with the storm with much of the same functionality as a real storm. The Storm Simulation Tool will be an asset for the development of exercises and planning scenarios. In addition to the new Storm Simulation Tool, there are many features within HURREVAC to support planning efforts. HURREVAC allows users to display, interact, and download the Sea, Lake and Overland Surge from Hurricane (SLOSH) products that identify areas at risk of storm surge inundation from hurricanes. Users can customize the type of storm and scenario they would like to use for plans and exercises with the MOM/MEOW storm surge mixer. Embedded Hurricane Evacuation Studies (HES) provide critical planning factors and information that can be used to guide hurricane evacuation and response plans. Those HES also provide the foundation for using the HURREVAC evacuation decision support tools, including the development of evacuation scenarios, timeline actions, and timing arcs. All these resources are available in HURREVAC to help state, local, tribal, and territorial emergency managers with planning hurricane evacuations.

WS104. Making Your Community More Resilient in 2022 and Beyond: A Miami-Dade Case Study
– Organized by Andrew Sussman

Thursday, May 12, 8:30 a.m. – 10:00 a.m. PBCCC 1L

This workshop will identify how Miami-Dade County is addressing challenging issues such as increasingly more frequent and intense hurricanes, climate change, sea-level rise, and extreme flooding. Presenters will discuss how the county has integrated resiliency efforts into its emergency management preparedness, response, recovery, and mitigation efforts. The panel will also address funding mechanisms to address resiliency challenges and gaining the support of stakeholder groups including private sector and elected officials. Attendees will be encouraged to share how their community is improving its resiliency.

WS105. Ensuring Disaster Feeding is More Than Just Ham Sandwiches and Casseroles –Organized by Jessica Geib

Thursday, May 12, 8:30 a.m. – 10:00 a.m. PBCCC 2A

Disaster Feeding, an already complex issue, has been made even more challenging when incorporating additional COVID challenges. Supply chain issues, distribution model limitations, and fewer volunteers - not to mention incorporating dietary considerations and increased demand can create a complex response feeding system post event. This panel discussion will include traditional feeding partners along with some new players- whose innovation ensured Florida continued to meet the needs of our most vulnerable over the past two years. Learn how your community can incorporate new strategies and include additional partners in planning for the next event.

WS106. The Power of CERT– Organized by Christy Rojas

Thursday, May 12, 8:30 a.m. – 10:00 a.m. PBCCC 2B/2C

CERT Leadership from across the nation met in Florida in 2019 to establish the National CERT Association. Modeled after The Florida CERT Association, the goal is to promote resilience by incorporating best practices and sharing resources to empower trained volunteers in our communities and across the nation. This session will explore how CERT in Florida continues to grow and serve as a national leader. Hear more about National CERT, Florida CERT, learn about CERT Task Books, CERT hurricane deployments and the incredible things CERT Teams are achieving.

WS107. The Value of Big Data in Health Care Response – Organized by John Wilgis

Thursday, May 12, 8:30 a.m. – 10:00 a.m. PBCCC 2D

The COVID-19 pandemic and other large-scale emergency events have shown the value of having essential elements of information and different data points that provide decision makers with valuable information. Health care response is rooted in informed decision-making. Today's data platforms offer promising opportunities for improving situational awareness by providing data and information supporting a horizontal and vertical response.

WS108. Stress Management for Responders – Organized by John Wilgis

Thursday, May 12, 8:30 a.m. – 10:00 a.m. PBCCC 2E

This workshop will address the unique stressors related to first responders and first receivers including a sense of belonging, support from one another and a strong sense of purpose. Participants will learn about how the effects of long-duration events and the stress it creates can factor into behavioral health issues such as post-traumatic stress disorder, substance abuse and depression. First responders and receivers are faced with a myriad of stressors that go beyond what the general population may experience. Recent evidence-based research indicates that maintaining one's behavioral health is important, along with physical health, to staff retention and resilience. The workshop will breakdown the issues and stigma related to behavioral health due to lack of education, fear and misunderstanding.

WS109. Improving Coordination with Energy Providers (Roundtable) – Organized by Kimberly Prosser

Thursday, May 12, 8:30 a.m. – 10:00 a.m.

PBCCC 2F

In the first hours after Hurricane Ida hit Louisiana, nearly 1.1 million customers were in the dark. Nine days after Ida, hundreds of thousands of homes and businesses in Louisiana, most of them outside New Orleans, still did not have power. Power restoration is a significant part of response, which can impact residents in their personal recovery and government and private businesses in their response and recovery operations. Through Hurricanes Michael, Irma and Matthew, Florida has similarly experienced major power outages. This roundtable discussion will feature state and local emergency managers and energy provider representatives sharing their experiences from Hurricane Ida, last winter's storms in Texas and from prior events in Florida. The goal is to share lessons learned on what has worked well in preparing for such events in terms of coordination between emergency management and energy providers and where room to improve exists based on recent past events that caused major disruptions in energy supply to the community.

WS110. Communicating Through Crisis: Proactively Communicating in a Reactive Environment

– Organized John Jamason

Thursday, May 12, 8:30 a.m. – 10:00 a.m.

Hilton Coral Ballroom A/B

This panel of public and private communications professionals will discuss the critical importance of clear, consistent and principled communications to crisis management and disaster response, as well as best practices for incorporating new facets of digital communications.

Panelists will also discuss the importance of building and executing a strong communications plan, how to develop strong public and private alliances and look back on lessons learned over the past two years. Top insights will be shared on how to leverage government PIOs historical and expert knowledge of ground operations with real time knowledge from contractors, and how to streamline those public/private communications across the board. Attendees will leave with our top 5 tips for implementing similar partnership models in their jurisdictions and the tools to successfully and effectively execute.

WS111. Panel Discussion - Public Messaging of Forecast Uncertainty and the Public's Expectations

– Organized by Pablo Santos

Thursday, May 12, 8:30 a.m. – 10:00 a.m.

Hilton Coral Ballroom C

Recent hurricanes that have affected Florida during the past few hurricane seasons have resulted in many messaging challenges regarding hazard risk and public perception of long-range forecasts. This has led to both over- and under-reaction to individual preparedness efforts and a continued focus on the exact track forecast and expected Saffir-Simpson Hurricane Wind Scale category rather than the potential impacts faced by each individual hazard (storm surge, inland flooding, and winds). This interactive session will bring together experts from the media, the National Weather Service and National Hurricane Center, and social scientists to examine how public messaging is perceived and how improvements could be made to elicit a proper response to hurricane threats in Florida.

WS112. Florida's Recovery Obligation Calculation – Organized by Bill Johnson, RN

Thursday, May 12, 8:30 a.m. – 10:00 a.m.

Hilton Coral Ballroom D/E

The Florida Division of Emergency Management is spearheading a first-in-the-nation initiative to reorganize and maximize the Public Assistance process for State and Local governments. Working with experts across the public and private sectors, the Division is facilitating a model where sub-recipients can “buy-up” their initial project obligations by taking concrete steps to mitigate their financial risk.

This workshop will present the details of the initiative and the Division's partnership with the Disaster Recovery Contractor's Association and will solicit feedback from attendees on ways to standardize processes and measure risk in Category A and B Public Assistance projects. All local government officials, emergency managers, and disaster recovery coordinators are encouraged to attend and provide their feedback and input.

WS113. Improving BRIC, HMGP and Mitigation Funding Outcomes in Florida – Organized by Lee Mayfield

Thursday, May 12, 1:30 p.m. – 3:00 p.m.

PBCCC 1A

The federal government allocates billions of dollars into programs designed to mitigate future damage and make public infrastructure more resilient. Mitigation programs such as the Building Resilient Infrastructure and Communities (BRIC) Program and the Hazard Mitigation Grant Program (HMGP) offer eligible applicants funding to protect their public infrastructure both before and after a disaster. However, mitigation opportunities and process improvements are constant efforts that take time to develop and implement. This session highlights common challenges that applicants face when attempting to gain access to these programs, best practices being implemented throughout the United States and Florida, and critical next steps that every applicant can take to better prepare for their chance to receive funding to mitigate their public infrastructure against disaster. Panelists will include subject matter experts from both the public and private sector. Join us for a discussion on the current mitigation outlook, what was noticeable in the past and what communities and experts see now, and where mitigation is going based on recent funding trends.

WS114. Federal ESF #14–Cross-Sector Business and Infrastructure: Supply Chain Coordination

– Organized by Lee Mayfield

Thursday, May 12, 1:30 p.m. – 3:00 p.m.

PBCCC 1B/1C

After hurricane landfalls, complex supply chain impacts can be experienced at every level from international/domestic manufacturing, US port import processing, to the “last mile” retail/commercial distribution. These impacted systems provide direct, traditional response resources to include temporary roof tarping, fuel, food, and other key commodities. This session is an opportunity for attendees to hear directly from the lead ESF #14 Agency, the Cybersecurity and Infrastructure Agency (CISA) as they discuss private supply and infrastructure coordination during disasters.

WS115. Decision Support Tools for Hurricane Decision Makers–Best Practices – Organized by John Wilson

Thursday, May 12, 1:30 p.m. – 3:00 p.m.

PBCCC 1D/1E

This workshop will present ways in which critical risk information from open-source databases can be used or incorporated into decision support tools used by hurricane decision makers such as HURREVAC. The Resilience Analysis and Planning Tool (RAPT) is a free GIS web map that allows federal, state, local, tribal and territorial emergency managers and other community leaders to examine the interplay of census data, infrastructure locations, and hazards including real-time weather information, historic disasters, and estimated annualized frequency of hazard risk (fema.gov/rapt). Participants will learn how to use RAPT in coordination with familiar hurricane modeling products such as HURREVAC, HAZUS, and CERA to inform hurricane planning including evacuation and sheltering decision making, identifying vulnerable populations, and recovery decision making. The workshop will also detail the state’s hazmat facility database (E-Plan) and how the location of these facilities can now be imported into HURREVAC. This information gives emergency management officials a more comprehensive view of facilities at risk and provides the opportunity to access risk and protective measures using various wind speeds and surge projections.

WS116. Logistics Operational Overview –Organized by Melissa Rudd

Thursday, May 12, 1:30 p.m. – 3:00 p.m.

PBCCC 1L

This workshop will provide an overview of standard logistics processes and procedures including:
Points of Distribution (POD)

Statewide Mutual Aid Agreement (SMAA)

- Joining the agreement
- Resource Requests and Offers
- Eligible Expenses and processing reimbursements
- Direct State Aid Agreement (DSAA) for State-to-Local resource acquisitions

Emergency Management Assistance Compact (EMAC)

- Deployment eligibility and expectations
- Creating a Mission Ready Package (MRP)
- Eligible expenses and processing reimbursements

The ultimate takeaway is for participants to have an increased understanding of State Logistics and Mutual Aid Functions that can be extrapolated across all of Florida's emergency management stakeholders. FDEM is currently developing a Sales Force online extension for all Mutual Aid Operations. Depending on the status of the implementation, this may be showcased to the participants as well.

WS117. Making the Most of Your Resources: Leveraging the Value of Service – Organized by Christy Rojas

Thursday, May 12, 1:30 p.m. – 3:00 p.m. PBCCC 2A

Volunteers are a great benefit when they supplement existing government and organizational efforts. The tangible economic benefit to a community through the work they perform, which can be used as the local community's match for FEMA benefits if accurate records are maintained. Voluntary Agency Liaisons at the Federal and State level, along with VOAD leadership will discuss the incredible resource volunteers can offer in disaster recovery, and the monetary benefit they can bring to your community. This session will discuss innovative ways to provide solutions, how to track volunteer hours and how to work with volunteers in your community.

WS118. Displaced During a Pandemic: Non-Congregate Sheltering – Organized by Phill Brodeur

Thursday, May 12, 1:30 p.m. – 3:00 p.m. PBCCC 2B/2C

Novel. Catastrophic. Unprecedented. Words we have come to know with cascading consequences from the 2014 Ebola crisis to devastating flooding and infrastructure impacts presented by Hurricane Harvey in 2017, followed by complexities of the COVID-19 global pandemic paired with statewide impacts from Winter Storm Uri. As Hurricane Laura focused in on Louisiana, preparations to assist our neighbors were underway. Considering COVID-19 protective measures, it was determined the State would secure non-congregate shelters pivoting and adapting to the new environment. This presentation will highlight the successes and challenges from the local perspective of conducting sheltering during the COVID-19 pandemic as well as support provided for citizens quarantined to their homes with limited resources. Relationships between various levels of government, non-profits, private sector hotels, and support agencies will be explored. We will investigate the new challenges amidst responding to a devastating winter storm where sheltering was again required; however, new solutions had to be developed to meet the COVID environment while experiencing limited resources due to the impacts to critical community lifelines. Patrons will learn of collaborative efforts as cities leaned in to provide wrap around services leveraging the full force of City resources; ways the jurisdictions adapted to meet needs and balance the swinging pendulum of acceptable best practice vs. viability of accessible resources; and unique challenges concerning Elected Officials.

WS119. Communication Flow of Essential Information During Emergencies for Health Care Personnel
– Organized by John Wilgis

Thursday, May 12, 1:30 p.m. – 3:00 p.m. PBCCC 2D

This workshop includes a facilitated panel discussion that will engage the audience in describing traditional methods of emergency communication and emergency communication technologies used in disaster response. The discussion will describe essential elements of information (EEI) and how data and information is prioritized for dissemination to health care providers across a community. The panel will engage the audience in a discussion centered on the challenges of providing and receiving EEI with and among community partners to strengthen community-based health care response. The panel will also discuss the role health care coalitions may play in emergency communications with their members and county and state emergency management agencies.

WS120. Aviation Emergency Management: Partners in Preparedness and Response – Organized by Melissa Rudd

Thursday, May 12, 1:30 p.m. – 3:00 p.m. PBCCC 2E

The ability for Florida to stand strong to the hurricane threat has a willing partner ready to assist the emergency management community - Aviation Emergency Management Programs. They can support and complement emergency management agencies; yet most emergency managers are unfamiliar with airports and air carrier capabilities. This session will present the important role that the aviation industry plays in disaster preparedness, response, and recovery. Hear emergency managers from Florida airports and airline partners discuss how they coordinate operations effectively with federal, state, and local emergency management agencies based on response operations for hurricanes including Harvey, Irma, Marie and Michael as well as other emergencies.

WS121. The Potential Storm Surge Flooding Map - What is it? What Does it Represent? –Organized by Pablo Santos

Thursday, May 12, 1:30 p.m. – 3:00 p.m. Hilton Coral Ballroom C

The Potential Storm Surge Flooding Map produced by the Storm Surge Unit at the National Hurricane Center is a relatively new tool designed to aid decision makers make life safety decisions during a land falling tropical storm or hurricane. Similar to the hurricane cone graphic, it is based on many scenarios/possibilities and thus represents a risk map. The graphic is based on several hundred realistic scenarios and represents the 10% exceedance (the worst 10% of the storms) flooding above ground at a specific location. The potential storm surge flooding graphic is thus a dynamic real-time complement to pre-existing MOMs/MEOs (worst-case scenario) and eliminates unrealistic scenarios. It is meant to be used as a decision support tool to help decision makers perform risk assessments, fine tune evacuation decisions, and make other decisions where there is limited risk tolerance. Recent land falling hurricanes have demonstrated how this new tool can be effectively used to cut unnecessary evacuations versus historical approaches. For example, during Dorian, it was estimated that only 1.5M Florida residents were under evacuation orders versus 4.5M estimated using worst-case scenario planning and historical approaches. This constitutes a 67% reduction in evacuations. This session will discuss how the *Potential Storm Surge Flooding Map* is created, what it shows, and how to properly interpret it for real-time storm risk analysis. This workshop will include interactive exercises that will simulate a real hurricane scenario, walk participants through evacuation decision making, and help the audience message it to the public.

WS122. Just What Emergency Managers and First Responders Need to Know About Public Assistance

– Organized by Lee Mayfield

Thursday, May 12, 1:30 p.m. – 3:00 p.m. Hilton Coral Ballroom D/E

In June 2020, FEMA established a new Public Assistance (PA) grant rule that all documentation must be turned in within 90 days of the work finishing for any disasters occurring after June 1st, 2020; meaning within 90 days of the last debris being dumped (not invoice turned in), all activity reports, payroll, invoices, backup documentation, etc. must be in FEMA's hands, or FEMA will not reimburse the costs. Emergency managers do not need to know all the details of PA eligibility; but there are several critical points that impact how emergency managers may operate during a response. This workshop will go over these critical points on FEMA eligibility and how to document certain costs to expedite reimbursement from FEMA one transition to recovery begins. Panelists will include both subject matter expert consultants and key staff from Florida jurisdictions who have recent experience navigating FEMA's PA program.

WS123. Implementing Mitigation – Organized by Eve Rainey

Thursday, May 12, 3:30 p.m. – 5:00 p.m. PBCCC 1A

Now that your mitigation grant application has been approved and your contract has been signed, the real work can begin. Before shovels begin slinging dirt or hammers start pounding, it's a good idea to fully understand everything that needs to be done to satisfy the contract to not jeopardize funding. It can seem overwhelming, but this workshop will help you understand the pitfalls to avoid, the I's that must be dotted and the T's that must be crossed. It will help you understand the relationship you should be having with your project manager and the help that is available along the way. By learning some of these best practices, you will leave feeling confident and able to tackle even the largest of projects. This workshop will discuss requirements and what to expect throughout the project management process including contracting, procurement, quarterly reports, requests for reimbursements, modifications,

and closeouts. The presentation will also include time for those who have successfully implemented mitigation projects in the past to discuss their best practices, as well as a question-and-answer session.

WS124. Exercising for Recovery – A Tale of Two Cities – Organized by Jeff Goldberg

Thursday, May 12, 3:30 p.m. – 5:00 p.m. PBCCC 1B/1C

Many agencies focus on the response side of exercises, often neglecting the recovery phase which can stretch over years. This panel will discuss the often-forgotten recovery exercise, examining two ways that they have been done. The first being Walton County Emergency Management's "Road 2 Resilience" full day tabletop exercise. This exercise brought together over 100 participants from over 75 different organizations to exercise recovery issues caused by a catastrophic hurricane. The next exercise was "Project Phoenix 2.0: The Recovery", a tabletop exercise developed by the Tampa Bay Regional Planning Council (TBRPC) to prepare emergency managers and small business owners for a worst-case disaster scenario and make both emergency management and business communities more resilient and how, due to the pandemic, was turned into a "train the trainer" style program so organizations can modify and use this exercise in house. In both cases, panelists will walk the participants through the exercise design process and hear about lessons learned (from an exercise design standpoint as well as from the actual exercise) and how they are being incorporated into plans.

WS125. Hidden in Plain Sight: Including Persons with Disabilities Before, During and After Disasters

– Organized by Christy Rojas

Thursday, May 12, 3:30 p.m. – 5:00 p.m. PBCCC 1D/1E

This workshop will focus on 1) acquainting participants with Autism Spectrum Disorder (ASD) and its impact on those with autism in a shelter environment; 2) sharing strategies for interacting with children, teens, and adults with ASD will be addressed; 3) addressing how the Independent Living Network (ILN) can provide to emergency management professionals assistance to reach persons with disabilities and improve their health, safety and independence; and 4) discussions on lessons learned from the experiences between the ILN, emergency management, and other disaster professionals during the COVID-19 pandemic and hurricanes Irma, Michael and Dorian. Information will be shared on how the collaborative efforts between ASD-serving organizations, the ILN and emergency management community can position Florida as the nation's leader in meeting the disaster related needs of people with disabilities.

WS126. Florida National Guard – Organized by Melissa Rudd

Thursday, May 12, 3:30 p.m. – 5:00 p.m. PBCCC 1L

Come learn from the best in the business! Florida National Guard presents leadership and planning tools on lessons learned from our active hurricane seasons to include COVID response. Senior leaders will discuss present methodologies, training and response guidelines for FLNG missions as well as best practices in response and leadership. Open discussion on planning materials and tools that are applicable across organizations like decision point timelines, battle rhythms, gap analysis products and more.

WS127. Best Practices in Community Outreach and Education – Organized by Jessica Geib

Thursday, May 12, 3:30 p.m. – 5:00 p.m. PBCCC 2A

Community Outreach and Education is a critical component of effective emergency management programs. Hear from several successful and innovative programs, including the Hurricane Kit Project from Pinellas County Emergency Management and FIU International Hurricane Research Center's range of education activity opportunities. Presenters will share about their programs and allow time for audience involvement of local best practices in community outreach. Come ready to share!

WS128. What is a VAL and What Can They Do for Me? – Organized by Christy Rojas

Thursday, May 12, 3:30 p.m. – 5:00 p.m. PBCCC 2B/2C

Voluntary Agency Liaisons at the Federal and State levels are incredible resources in disaster recovery. This session will help provide an understating on how Voluntary Agency Liaisons (VALs) partner with internal FEMA components and external partners, innovate to provide solutions that address unmet needs in disaster impacted communities, educate external partners, connect stakeholders with available resources, support Long Term Recovery Committees, support donation management while working together with local Emergency Managers.

WS129. The Importance of COOP in Health Care – Organized by John Wilgis

Thursday, May 12, 3:30 p.m. – 5:00 p.m. PBCCC 2D

Continuity of Operations Planning outlines methods, resource needs, information and a system outlining how critical operations will continue under a broad range of circumstances. Private sector organizations, like health care providers, may refer to this type of planning as business interruption or continuity planning and it may reflect one component of a larger risk management plan. This workshop will feature a facilitated interdisciplinary panel and audience discussion on continuity planning and how significant it is for health care providers. Recent examples from Hurricanes Matthew, Hermine, Irma and Michael will be included in the conversations. The purpose of the workshop is to highlight the key elements of continuity planning and establish how continuity plans should be integrated with a wide, community-based response.

WS130. UAS in Hurricane Response: Rapid Needs Assessment and Live Streaming Video – Organized by Jeff Goldberg

Thursday, May 12, 3:30 p.m. – 5:00 p.m. PBCCC 2E

This presentation will focus on the use of Unmanned Aircraft Systems for response during the 2020/2021 hurricane seasons. Hurricanes Laura, Sally and Ida will be used as case studies to demonstrate how UAS were used by the FSU EMHS/CDRP UAS team to provide timely and accurate situational awareness to emergency management decision makers and others in government. Specific attention will be made to the use of live streaming and details will be provided as to how this was implemented.

WS131. Catastrophic Inland Flooding: Could it Happen in Florida? – Organized by Pablo Santos

Thursday, May 12, 3:30 p.m. – 5:00 p.m. Hilton Coral Ballroom C

The Southeastern United States has seen catastrophic flooding rain from tropical cyclones in recent years. In 2017, Hurricane Harvey dropped over 5 feet of rain in the Houston area. In 2018, Hurricane Florence produced around 36" in North Carolina, and in 2019, Tropical Storm Imelda produced over 43" in the Houston area. Impacts from these catastrophic flood events can occur well away from the destructive winds and the category of the storm does not play a significant role in how much rain falls. The first part of this session will discuss how the Weather Prediction Center creates rainfall forecasts and evaluates flash flooding risks associated with tropical events. This part will also include simulations of extreme rainfall events (courtesy of the River Forecast Center in Atlanta) resulting in catastrophic flooding that include flood mapping of six Florida rivers. This provides the background for a discussion of the impacts associated with catastrophic flooding in Florida. The second part of this session will be interactive and will focus on the challenges of messaging these extreme events. Participants will be given scenarios for small group discussions.

WS132. Trends and Progression of FEMA's Public Assistance Program – Organized by Lee Mayfield

Thursday, May 12, 3:30 p.m. – 5:00 p.m. Hilton Coral Ballroom D/E

FEMA's delivery of the Public Assistance program has undergone significant modifications in the past few years. With changes such as the introduction of the PAAPG, the FEMA Grant's Portal, the 428 Alternative Grant's program and the streamlined grant application to name just a few, it has become increasingly more difficult for potential applicants to stay informed and abreast of recent

changes, changes that could significantly impact their agency, municipality, or PnP's ability to completely recover from a declared event. This presentation will provide the attendees with a basic background in the PA program, an overview of current trends in the delivery of the program, as well as alerting to some potential "pitfalls" or missteps that could hinder a full financial recovery. Important topics such as proper procurement, eligibility, and adequate documentation will also be covered to highlight the issues that could lead to a de-obligation of a grant or subsequent negative audit finding.

WS133. Operationalizing After-Action Reports & Improvement Plans – Organized by Bill Johnson, RN

Friday, May 13, 8:30 a.m. – 10:00 a.m. PBCCC 1A

Developing a thorough and objective After-Action Report and Improvement Plan (AAR/IP) is incredibly important. However, that is just the first step. Following up on action items contained in the improvement plan, creating a corrective action plan and program, and operationalizing these activities into all phases of emergency management ensures that a jurisdiction memorializes best practices and lessons learned. Too often, these activities fall to the emergency manager after the AAR/IP has been developed; but it is a true team effort across all departments and offices. Attendees can learn how to take the simplest to most complex IP tasks and understand how these are translated into real, sustainable projects leading to a more prepared community and enhance resilience.

WS134. Pandemics and Storms and Fires, Oh My! Best Practices in Special Needs Sheltering
– Organized by Jeff Goldberg

Friday, May 13, 8:30 a.m. – 10:00 a.m. PBCCC 1B/1C

The past few years has been very stressful on all of us, particularly those with special needs. In this workshop, we will have panelists from different jurisdictions discuss how recent incidents have impacted special needs sheltering. Among the topics, we will discuss staffing, logistics, last minute registrations, and take questions from the audience in this interactive workshop.

WS135. Emergency Press Conferences and Working with American Sign Language Interpreters and Captions
– Organized John Jamason

Friday, May 13, 8:30 a.m. – 10:00 a.m. PBCCC 1D/1E

Sharing information critical to life safety in times of emergencies and disasters is the responsibility of government entities, PIO's, media outlets, and responding agencies. Access to this information is equally crucial for persons who are Deaf & Hard of Hearing. Providing equal access to information is required under the law but can often prove challenging. This workshop breaks down the entire process step-by-step. Specifically, this workshop teaches participants the proactive steps they can take to ensure equal access to information.

WS136. What Red Cross Service Delivery Looks Like in 2022 – Organized by Phill Brodeur

Friday, May 13, 8:30 a.m. – 10:00 a.m. PBCCC 2A

The American Red Cross is responding to concurrent major disasters driven by extreme weather nearly continuously. The operational landscape consists of more climate disasters more often, with longer response phases, affecting and displacing increasingly larger and more vulnerable populations with access to ever decreasing resources. In places with little resilience and repetitive loss, these acute needs, like climate disasters that contribute to them, are becoming chronic challenges.

Between 2021 and 2030, the American Red Cross will refocus its response, recovery and preparedness programs to measurably improve both the short-term coping capacity and longer-term adaptive capacity of vulnerable populations to acclimate to increasing climate disasters due to climate change. Beginning in FY 2022, the American Red Cross will begin adapting service delivery to vulnerable populations in connection with extreme weather events (such as hurricanes, floods, wildfires) caused by climate change. Discussion will include identification of vulnerable communities by using applied data, geo-spatial analytics as well as targeted investments and partnerships within the identified communities to address significant, recurrent barriers.

WS137. Survivor Assistance: Past, Present and Future – Organized by Kimberly Prosser

Friday, May 13, 8:30 a.m. – 10:00 a.m.

PBCCC 2B/2C

Survivor assistance post-disaster has been around in various forms since recorded history. Because each disaster is unique, past events can shape the form and delivery of future assistance by revealing best practices. This workshop presents an overview of the historical context of survivor assistance and how it has evolved to what we see now. We will discuss recent disaster events, the many forms that survivor assistance can take, best practices, and how to avoid common pitfalls to promote survivor recovery in your community. We will conclude the session with a discussion of strategies that can improve survivor assistance for future events.

WS138. Health Care Integration Strategies for Non-Acute Health Care Providers – Organized by John Wilgis

Friday, May 13, 8:30 a.m. – 10:00 a.m.

PBCCC 2D

Health Care Coalitions (HCC) are groups of individual health care and response organizations working in a defined geographic area to prepare for, respond to, and recover from disasters and emergencies. Florida has been building and sustaining HCCs since 2012. This workshop will explore the role of HCCs while also discussing how non-acute providers can benefit from what HCCs provide in terms of planning, training, equipping and exercising their emergency operation plans. Workshop presenters will also share some best practices in building effective partnerships with long-term care facilities, how the facilities have become strong advocates in the community for the local emergency management programs, and how a local gap can be filled with the help of many state and federal partners.

WS139. Team Awareness Kit—How It Can Help Emergency Managers Improve Their Situational Awareness
- Organized by Jeff Goldberg

Friday, May 13, 8:30 a.m. – 10:00 a.m.

PBCCC 2E

The Team Awareness Kit (TAK) is a free suite of georeferenced imagery and communications tools that allow for scaled operational planning, data sharing, reconnaissance collection, and asset tracking. Teams using TAK can communicate and share location information in real time, even in restricted communications environments. This presentation will cover the organizational requirements, technology needs and an overview of the TAK suite of applications. Real-world TAK implementation by the FSU EMHS/CDRP UAS team in Hurricane Sally and Hurricane Ida will be used as case studies in this presentation.

WS140. Watch/Warning Philosophy and Potential Tropical Cyclones – Organized by Pablo Santos

Friday, May 13, 8:30 a.m. – 10:00 a.m.

Hilton Coral Ballroom C

Potential Tropical Cyclones are a relatively new designation for systems that are not yet a tropical cyclone but are expected to develop into one and affect land within the watch and warning time period. This designation has allowed the National Weather Service and the National Hurricane Center to issue its full suite of advisory products, including watches, warnings, and hazard information for these systems. This has allowed the timelier issuance of tropical storm and hurricane watches and warnings when systems develop near land. This session will discuss the considerations for issuing watches and warnings for developing systems, including the balance between providing actionable watch/warning information and the increased uncertainty of the track and intensity forecasts for these systems. The session will discuss the success and challenges of these forecasts since 2017, and whether additional lead-time could be provided in the future.

WS141. Hurricane Michael—Roadmap to Recovery – Organized by Jeff Goldberg

Friday, May 13, 8:30 a.m. – 10:00 a.m.

Hilton Coral Ballroom D/E

On October 10, 2018, Hurricane Michael made landfall in Bay County as a Category 5 Hurricane and the county was at the center of the destruction and devastation that occurred across Florida's panhandle. In the wake of the storm, communities throughout the panhandle faced a long road to recovery that necessitated leveraging funding from multiple programs to rebuild as quickly and effectively as possible. This process included managing new aspects of many of these programs, including major decision

points within the Public Assistance program on the use of Section 428 to award funding based on fixed cost estimates versus the traditional standard lane procedures. This session will include speakers who represent both smaller and larger communities within the panhandle and will provide perspectives on the different challenges these communities have faced throughout the recovery process as well as lessons learned as they recovered from a major hurricane.

WS142. Private Sector Response Support to EOCs and Field Operations - Successes and Challenges

– Organized by Lee Mayfield

Friday, May 13, 10:30 a.m. – Noon

PBCCC 1A

Historically, private emergency management firms have been supportive to local and state jurisdictions in both Recovery and Preparedness. Assisting with cost recovery efforts, grants management, planning, training, and exercise, outside expertise has proven valuable. More recently, private firms have become more engaged during the Response phase, supporting clients through two hurricane seasons while at the same time serving in professional, emergency management response roles since the start of the COVID-19 pandemic. This workshop will explore areas where the private sector has added value during response over past few hurricane seasons in the midst of a pandemic. Panel members will include both public and private sector emergency managers as we explore specific staff augmentation roles, special project support, successes, challenges, and funding sources.

WS143. Are You FEPA Certified? If Not, Why Not? - Organized by Jeff Goldberg

Friday, May 13, 10:30 a.m. – Noon

PBCCC 1B/1C

Why be FEPA certified? What does it mean to me? During this interactive workshop, learn what kinds of emergency management certification opportunities there are (including Healthcare and Instructor) and what you need to do to accomplish this goal. Commissioners will first present on factors needed to succeed, then you will have the opportunity to meet with Certification Commissioners and work with them on your specific questions regarding the application process and/or your application.

WS144. Atlantic Hurricane Season Prediction/Outlook–2022 – Organized by John Wilson

Friday, May 13, 10:30 a.m. – Noon

PBCCC 1D/1E

Colorado State University's initial Atlantic hurricane forecast for 2022 will be presented and discussed in detail.

WS145. Academic Research Presentations – Organized by Jessica Geib

Friday, May 13, 10:30 a.m. – Noon

PBCCC 2A

This session will feature selected research presentations from students and academics in Emergency and Disaster Management related academic courses or programs. A panel discussion with key emergency management stakeholders will follow each presentation and all are encouraged to attend and engage with future emergency managers and current researchers. Student scholarship recipients should also plan to attend this session.

Presenters have been selected and vetted through an application process and research posters will be on display near the registration table throughout the week.

WS146. Navigating Volunteer Engagement in a Post-Pandemic World – Organized by Tanya Holloway

Friday, May 13, 10:30 a.m. – Noon

PBCCC 2B/2C

In December 2020, Volunteer Match conducted research on the impact of Covid-19 on volunteering & social sector and found that 65% of organizations were operating with reduced resources and 11% had halted operations at least temporarily. The purpose of this workshop is to identify trends and create opportunities for post-pandemic volunteerism.

WS147. Patient Movement and Tracking: We Need a Solution! – Organized by John Wilgis

Friday, May 13, 10:30 a.m. – Noon

PBCCC 2D

This workshop will conduct a facilitated group discussion of the necessary EEIs, resources and tools needed to improve the evacuation and tracking of patient movement across a large geographical area. We will examine best practices and current protocols/procedures and include gaps in planning or operational response coordination.

WS148. Social Media Exercise – Organized by John Jamason

Friday, May 13, 10:30 a.m. – Noon

Hilton Coral Ballroom A/B

This session will discuss the outcomes and lessons learned during the 2022 GHC Social Media Exercise. Exercise participants will have an opportunity to share new and innovative ideas, trends and concepts gained from participating and examine how conference attendees engaged throughout the week.

WS149. Hurricane Evacuations: Modeling, Communicating, Procedures & Considerations

– Organized by Andrew Sussman

Friday, May 13, 10:30 a.m. – Noon

Hilton Coral Ballroom C

This workshop will cover the following: evacuation communication via social media and traffic data analysis and modeling, highlighting the results of an NSF grant funded study, which developed models for making real-time traffic predictions during hurricanes by synthesizing data from transportation systems and social media and analyzed traffic crashes during evacuations.

The Florida Department of Transportation (FDOT) and the Florida Highway Patrol (FHP), through planning and coordination have developed best practice standards when implementing Emergency Shoulder Use (ESU) mass evacuations via major traffic corridors. Various evacuation methods will be discussed, including a comparison of ESU and Contra-flow concepts.

WS150. Joint Damage Assessment County Guide: What Does the Process Look Like and How Can My County Prepare?

– Organized by Eve Rainey

Friday, May 13, 10:30 a.m. – Noon

Hilton Coral Ballroom D/E

This workshop's intention is to provide counties with a step-by-step look at the Joint Preliminary Damage Assessment (JPDA) process from start to finish following a hurricane, tropical storm, or tornado. State and County Representatives will be on-hand to discuss best practices from previous storms and successful strategies for preparing pre- and post-landfall while working with Federal Emergency Management Agency (FEMA). Additionally, the workshop will demonstrate the use of GIS software as a tool for identifying areas with the most damage and how to create an efficient methodology for conducting the JPDA.

The initial presentation will include an overview of the damage assessment process and its correlation to the potential activation of Public Assistance (PA) and/or Individual Assistance (IA), as well as a GIS demonstration. Following, State and County representatives will provide real-world recommendations for both blue sky and grey sky preparations that will be useful in the damage assessment process on the county-specific level.

Palm Beach County Convention Center

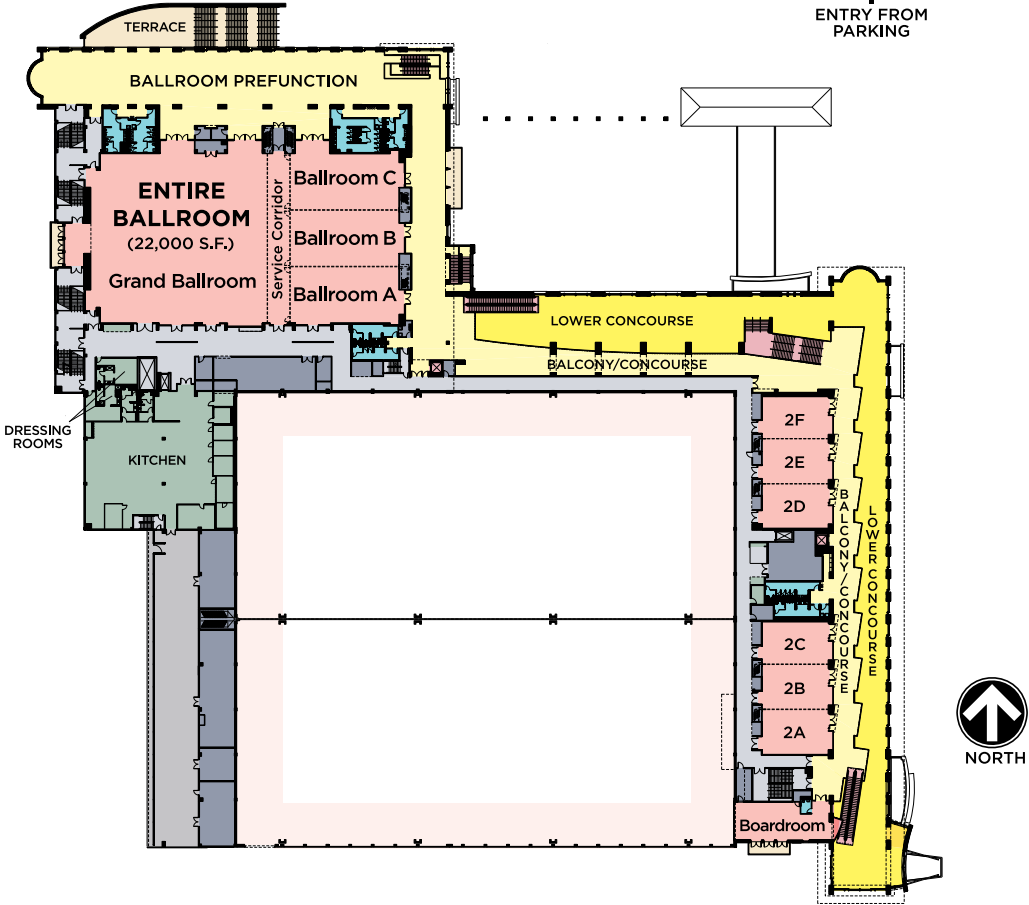
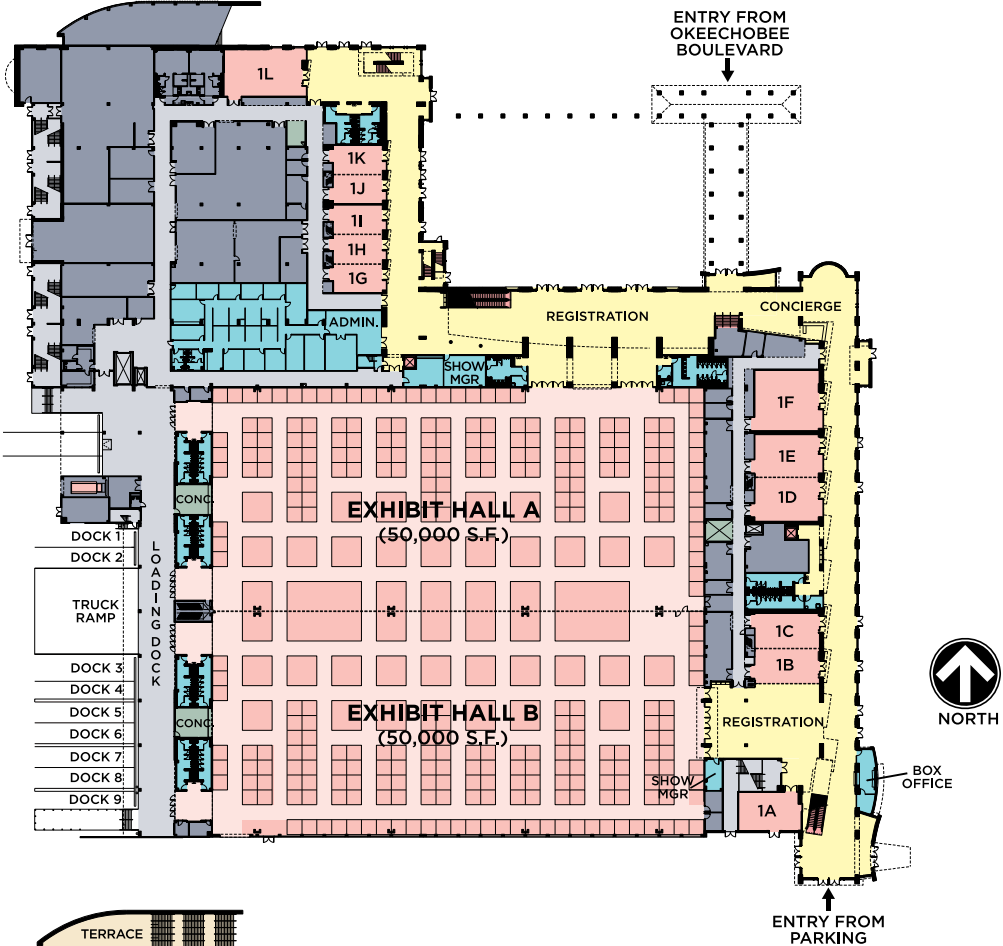

GET WHAT YOU NEED SAFER, FASTER, BETTER.



Emergency Disaster Relief

Full-service mobile facilities after storms & other disasters.

- Mobile Sleepers
- Mobile Restrooms
- Mobile Showers
- Mobile Laundry
- Mobile Catering



Industrial Temporary Structures

Industry-best tents & temporary structures for all your needs.

- Man & Base Camps
- Blast Tents
- Turn-Around Tents
- Medical Tents
- Dining Tents



Award Winning Catering

Best-in-class mobile & temporary food services.

- Expert Chefs
- Daily Selections
- Amazing Meals
- Covid-19 Safety
- 15,000 Meals / Day

Lodging
SOLUTIONSSM
EMERGENCY SERVICES



ITS
INDUSTRIAL TENTS



**SAFER.
FASTER.
BETTER.**

24/7 DEPLOYMENT | 888.995.4044 | BOLTONHOLDINGSLLC.COM

DISASTER CAN STRIKE ANYTIME **ARE YOU READY?**



BOSMA ENTERPRISES CAN HELP

We provide high-quality kits that provide disaster victims with essentials like bedding and toiletries. They are prepackaged for easy storage and quick distribution.

Call us today at **888.567.3422**
or visit us at **Booth 409** to make sure
you are ready when nature strikes.

BOSMA
Enterprises®

bosma.org/enterprises



SHELTER IN PLACE KIT





YOUR HURRICANE READINESS AND RESPONSE PARTNER

Disaster Debris Removal



Utility Vegetation Management



Civil Construction Services



C O N F I D E N C E I N C H A O S

WWW.GOSDR.COM



CrowderGulf...Standing the Test of Time.

We've sincerely appreciated the opportunity to work with you and we look forward to serving your recovery needs in the years to come.



Thank you for placing your trust in us for the past 50 years.



OVER 50 YEARS OF EXPERIENCE IN DISASTER RECOVERY

DEBRIS REMOVAL · REDUCTION · SITE MANAGEMENT · DEMOLITION

The full-time D&J Enterprises disaster support team is dedicated to providing rapid, coordinated, and efficient response to any disaster situation that requires outside support. D&J has the personnel, equipment resources, strong financial backing, and experience necessary to do just that. Our extensive experience of over 50 years has created an abundance of knowledge and skills for our principals, managers, and personnel. With that experience and our ability to self-perform any size project immediately, D&J is your trusted partner in a time of need.



334.821.1249 | 3495 LEE ROAD 10 | AUBURN, AL 36832
WWW.HURRICANERECOVERY.COM

400,000+ Reservists

READY TO DEPLOY AT A MOMENT'S NOTICE TO HELP OTHERS AT THEIR GREATEST TIME OF NEED.

- Clinical and Non-Clinical
- 423 Unique Profile Classes
- FEMA Trained
- Hurricane Response Experience

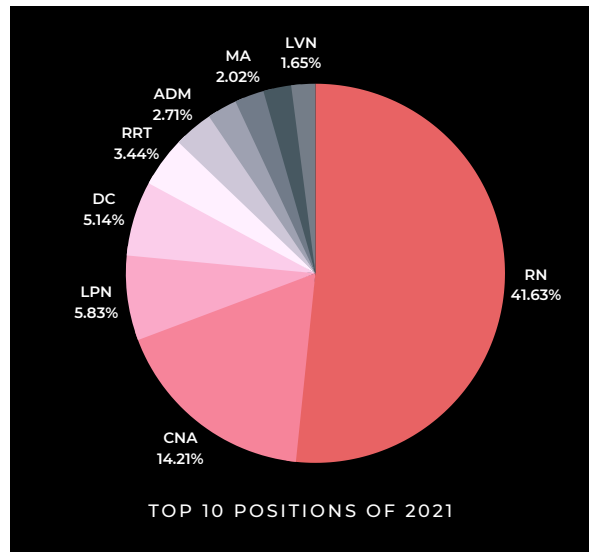

Reservist Profile Sign Up's

TOP 10 CLINICAL POSITIONS WHO SIGNED UP IN 2021

- RN - 64,285 - 41.63%
- CNA - 21,942 - 14.21%
- LPN - 8,998 - 5.83%
- DC - 7,937 - 5.14%
- RRT - 5,306 - 3.44%
- ADM - 4,181 - 2.71%
- EMT - 3,178 - 2.06%
- MA - 3,120 - 2.02%
- EMTP - 2,961 - 1.92%
- LVN - 2,555 - 1.65%

THE LEADER IN EMERGENCY DISASTER STAFFING

We offer the nation's largest roster of deployable clinical and non-clinical staff with nearly 400,000+ reservists in our pool of talent. Due to our reach Krucial can staff client needs at 100% fill rate within 48 hours. Krucial has been a disaster staffing provider since 2012, dating back to Hurricane Sandy. Interested in pre-event contracting? Visit Booth 643 to learn how we're the right partner to help weather the storm.

STAFFING PACKAGES INCLUDE:

- KRUCIAL ONSITE REPS
- KRUCIAL CLINICAL LIAISONS
- LOGISTICAL DOMINANCE
- 24-7 PARTNER SUPPORT
- FEMA TRAINED STAFF
- BACK-OFFICE SUPPORT
- FINANCIAL MANAGEMENT
- CREDENTIALING

**HURRICANE PREPAREDNESS:
LET'S TALK ABOUT YOUR STAFFING NEEDS.**

913.347.5336 | corporateEMD@krucialstaffing.com

BOOTH 643





FIRECO US

MecMast

by Fireco

Unmatched in strength, innovation, precision



www.firecoUSA.com