

# GOVERNOR'S HURRICANE CONFERENCE<sup>®</sup>

**MAY 11-16, 2025**

**PALM BEACH COUNTY CONVENTION CENTER  
HILTON WEST PALM BEACH**

## Enduring Together – Persevering with Purpose



**American  
Red Cross**

**National Weather  
Service**

**Florida Emergency  
Preparedness Association**

**P.O. Box 279, Tarpon Springs, FL 34688-0279 ♦ Phone (727) 944-2724 ♦ Fax (727) 944-2687**

**E-mail: [rene@flghc.org](mailto:rene@flghc.org)**



**SAFETY**

**TRUST**

**EXPERIENCE**

**PROFESSIONALISM**

- Pre-event Disaster Planning
- Emergency Road Clearance
- Hazardous Tree Removal
- Debris Removal and TDS Management

# CTC

**DISASTER RESPONSE**

**(785)478-9805**

**ctcdisaster.com**





PUTTING YOU ON THE ROAD TO RECOVERY

We are grateful for the opportunity to assist in your recovery efforts. We stand ready to serve.

# Governor's Hurricane Conference®

## In-Kind Donors



The Governor's Hurricane Conference® relies heavily on the assistance of volunteers to prepare for and execute the conference. The four sponsoring agencies (Florida Division of Emergency Management, American Red Cross, Florida Emergency Preparedness Association and the National Weather Service) dedicate extensive human and other resources to all aspects of the conference. Additionally, other agencies and organizations provide staff and services that help make the conference a success. It is with sincere appreciation that we recognize those agencies.





# Governor's Hurricane Conference®

## Conference Underwriters



As a not-for-profit corporation, the Governor's Hurricane Conference® strives to maintain reasonable registration fees that afford the maximum participation of all agencies, large and small. With that philosophy, it would not be possible for the GHC to provide all of the amenities that attendees enjoy, without assistance. Therefore, we seek financial contributions from the business community in order to provide refreshment breaks and other items and events.

This year's Underwriters deserve a very sincere "Thank You" from all of us for making the Governor's Hurricane Conference® not only a great learning experience, but an enjoyable experience, as well. As you see representatives of our Underwriters this week, please convey your appreciation for their help.



# Palm Beach County Convention Center

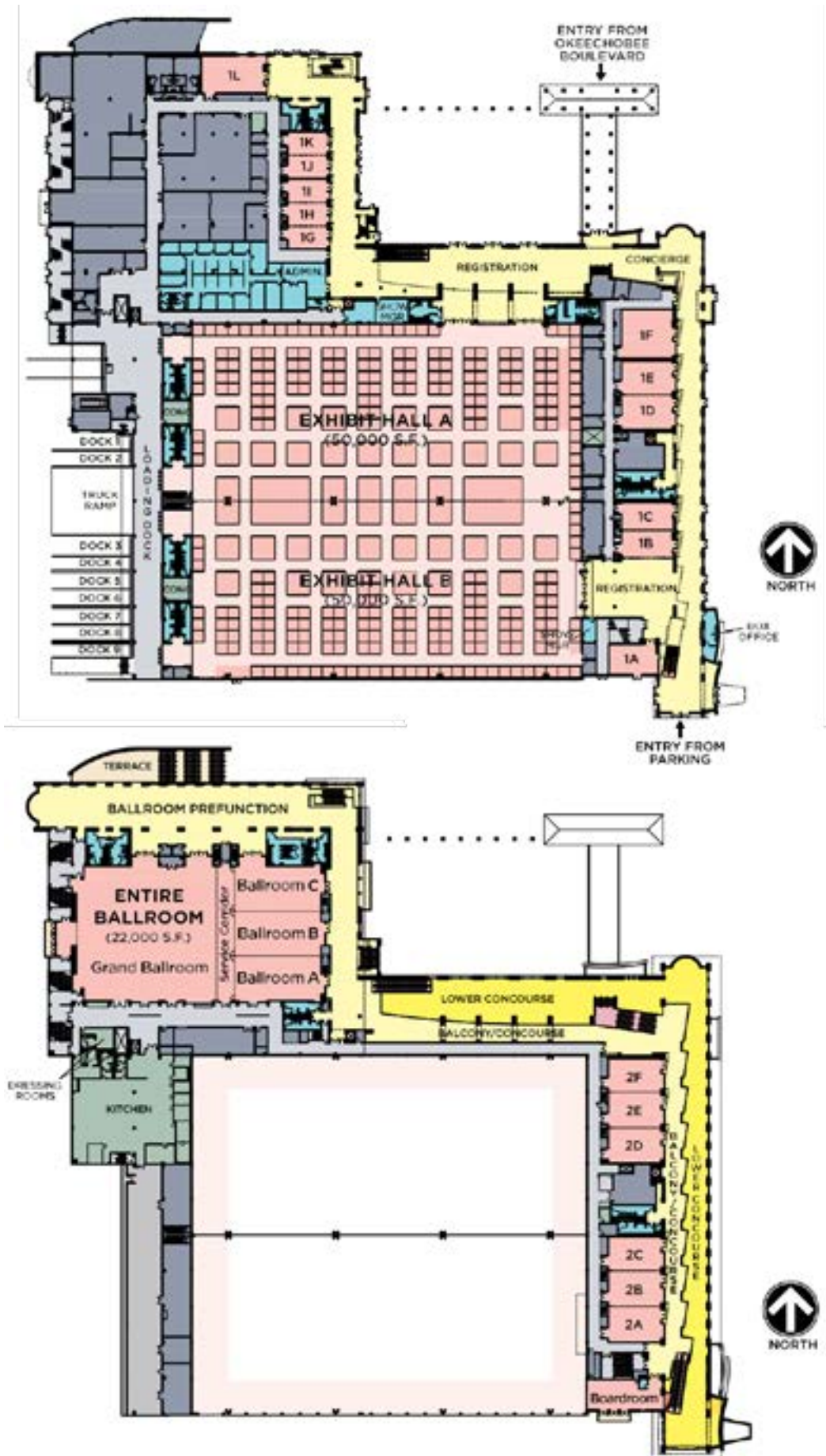

## HILTON WEST PALM BEACH FLOOR PLAN

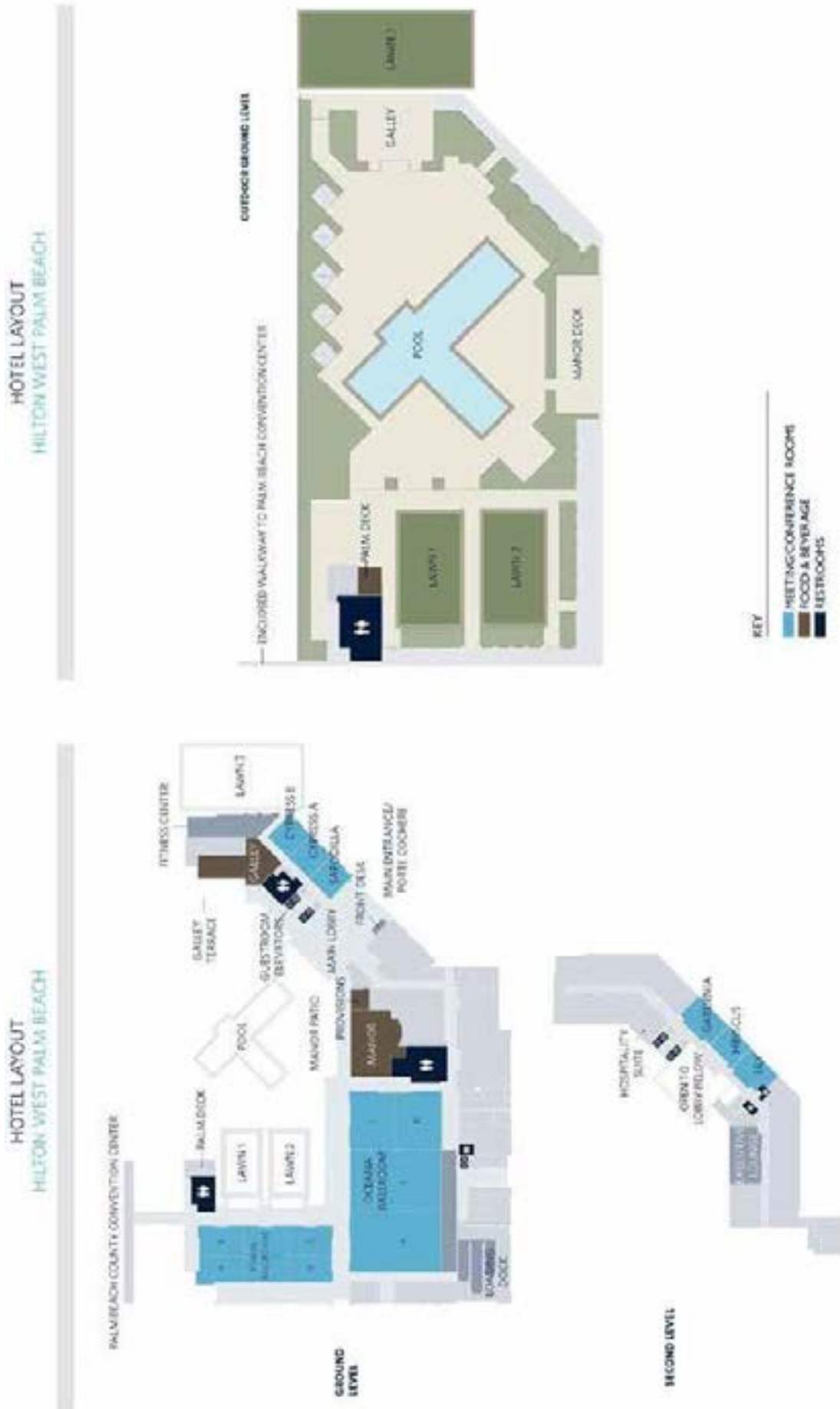



# Contents

Agenda of Activities .....	4
Awards Luncheon .....	6
Exhibit Hall Map. ....	9
Exhibitors .....	10
Floor Plan Hilton WPB.....	v
Floor Plan PBCCC. ....	iv
Future Conference Dates .....	vi
General Session.....	6
Hotels.....	3
In-Kind Donors .....	ii
Mobile App .....	5
Registration Policies.....	3
Theme.....	1
Training Sessions List.....	14
Training Session Descriptions .....	15
Training Session Matrix.....	23
Underwriters.....	iii
Workshops List.....	25
Workshop Descriptions .....	26
Workshop Matrix .....	24



Future dates for the Governor's Hurricane Conference® are:

**May 10-15, 2026**

Palm Beach County Convention Center / Hilton West Palm Beach

**May 16-21, 2027**

Rosen Shingle Creek Resort, Orlando, FL





# Trusted partner, stronger together.

Committed to Florida's  
emergency response,  
management, and  
community recovery.



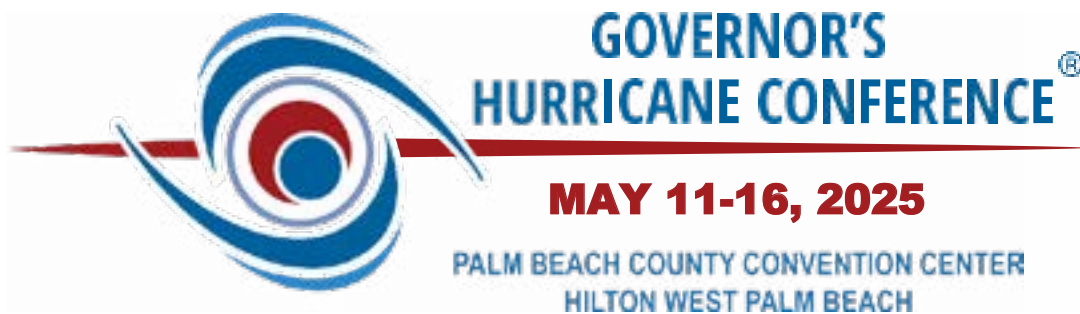

## ***Enduring Together-Persevering with Purpose***

The 2024 Atlantic hurricane season was one for the record books and a year that those involved in response and recovery efforts will certainly not forget. In Florida, the season was defined by three separate hurricane impacts, two of them coming within two weeks of each other. Hurricane Debby made landfall in the Big Bend as a Category 1 on August 5<sup>th</sup>. Hurricane Helene struck the same area as a Category 4 on September 26<sup>th</sup>, and Hurricane Milton made landfall as a Category 3 hurricane near Siesta Key, Florida on October 9<sup>th</sup>. Looking beyond Florida, we saw Hurricane Beryl bring wind and flooding to Texas and Louisiana, and Hurricane Helene's catastrophic impacts in Western North Carolina.

Once again, rural counties in the Big Bend of Florida found themselves responding to hurricanes while in active recovery from the storms of past years. Additionally, heavily populated coastal counties along the west coast of Florida received historic coastal and inland flooding, and wind damage from Debby, Helene, and Milton. In Hurricane's Debby and Helene, these impacts were felt even though landfall was hundreds of miles away. Storm surge levels from Hernando County south through Sarasota County were the highest many have seen in our lifetimes, flooding tens of thousands of structures along the coast and inland. The east coast of Florida also saw a significant tornado outbreak caused by Hurricane Milton's landfall on the west coast.

Our theme for this 39<sup>th</sup> edition of the Governor's Hurricane Conference – ***Enduring Together – Persevering with Purpose*** – represents a hurricane season that asked a lot of our collective profession. Multiple hurricane landfalls within a short period of time required continued service to our communities, often with little break, and a blurred line between response and recovery. This put added pressure on emergency management stakeholders and an increased importance on leaning on each other, collaborating across jurisdictions, supporting our teams, and persevering with the goal of improving outcomes for those we serve.

This year's conference reflects a comprehensive training and workshop experience taking into consideration our diverse responsibilities that drive us to a shared goal. This year, our sponsoring organizations have selected 28 training sessions, 59 workshops, and an informative General Session to share lessons learned from the 2024 season and better prepare us for what the future holds. We also offer networking opportunities to meet and reconnect with colleagues across our profession and develop lasting partnerships across our emergency management community.

The Governor's Hurricane Conference Board of Directors and Program Committee invite you to join us this year in West Palm Beach, FL as we apply the lessons of the past and persevere together!





# Capacity Path

Brighter. Stronger.

**Preparedness | Response | Recovery | Mitigation**

☎ 850-426-2327

📍 260 1st Ave S, Suite 200-42,  
St Petersburg, FL 33701

✉ info@capacitypath.com

## **Mental Health for Emergency Response**

**Relief for Survivors**

**Respite Care for Responders**

**Real Resilience for  
Impacted Communities**

# 2025 FLORIDA UPDATE

**With back to back storms in 2024, more than ever, Florida communities request to be strengthened and supported with robust measures for endurance and resilience to weather the changing tides and growling grey skies. Florida's Crisis Care Taskforce responded.**

In the aftermath of Hurricanes Helene and Milton, communities across Florida, from Taylor to Pinellas Counties, down to coastal Lee, deep into Hernando, Pasco and Polk, all the way across the state to St Lucie county with the fatal Spanish Lakes tornadoes, many faced unprecedented challenges from impacts experienced statewide, including exhaustion and burnout facing responders, county staff, and emergency management professionals.



With extraordinary demand for community crisis intervention and responder care for long term endurance, Capacity Path was able to increase capability, thanks to Florida's forward thinking. Through FDEM's capability to innovate to solve real problems, and the collaborative mass care framework, Capacity Path's Crisis Care Taskforce provided 33,000+ crisis intervention and resourcing sessions across 13+ counties for the three hurricane responses.

Florida's many small business owners, mobile home park residents, emergency management, social service agencies, law enforcement and fire service all expressed relief from the fast mobilization of Capacity Path's care teams designed to tend to the specificity of the needs they each uniquely faced. Honor, thanks, and glory to the many responders for your tireless service to the state of Florida.



**"I didn't realize how bad it could get, or how much I would need this kind of support. I don't know what we would have done without your team." -FL Coastal Fire Chief**





# CONFERENCE HOTELS

## **Hilton WPB**

600 Okeechobee Blvd.  
West Palm Beach, FL 33401  
Phone: (561) 231-6000

## **Marriott**

1001 Okeechobee Blvd.  
West Palm Beach, FL 33401  
Phone: (561) 833-1234

## **Hyatt Place**

295 Lakeview Ave.  
West Palm Beach, FL 33401  
Phone: (561) 655-1454

## **Hilton Airport**

150 Australian Ave.  
West Palm Beach, FL 33406  
Phone: (561) 684-9400

---

## IMPORTANT REGISTRATION POLICIES

- Name badges are color-coded based on the registration fee paid. Attendees will be required to wear their name badges at all conference functions.
  - Blue:** Fully registered for all training sessions and conference activities, including the Awards Luncheon. (Sunday - Friday)
  - Purple:** Fully registered for all training session activities (Sunday - Wednesday)
  - Red:** Fully registered for all conference activities, including the Awards Luncheon. (Wednesday - Friday)
  - Black:** Not registered, presenter only for presentations or conference support.
- 
- Registration may not be “shared.” Authorization for substitution of pre-registered attendees must be presented in writing.

# 39<sup>th</sup> Governor's Hurricane Conference®

## Agenda of Activities

### *Palm Beach County Convention Center / Hilton West Palm Beach*

#### **Sunday, May 11**

10:00 a.m. – 5:00 p.m. Registration Opens ..... PBCCC, Level 1  
12:00 p.m. – 5:00 p.m. Social Media Lounge ..... PBCCC, Level 1  
1:30 p.m. – 5:00 p.m. Training Sessions..... PBCCC, Level 1 & 2  
3:00 p.m. – 3:30 p.m. Networking Break..... Hilton Connector Doors

#### **Monday, May 12**

7:30 a.m. – 5:00 p.m. Registration Opens ..... PBCCC, Level 1  
8:00 a.m. – 8:30 a.m. Morning Beverages ..... PBCCC, Level 1  
8:00 a.m. – 5:00 p.m. Social Media Lounge ..... PBCCC, Level 1  
8:30 a.m. – 5:00 p.m. Training Sessions..... Hilton & PBCCC  
8:30 a.m. – 5:00 p.m. Media Room..... PBCCC, Room 1J/K  
10:00 a.m. – 10:30 a.m. Networking Break..... PBCCC Escalator & Hilton Connector Door  
12:00 p.m. – 1:30 p.m. Lunch .....(on your own)  
3:00 p.m. – 3:30 p.m. Networking Break..... PBCCC Escalator & Hilton Connector Door

#### **Tuesday, May 13**

8:00 a.m. – 5:00 p.m. Registration Opens ..... PBCCC, Level 1  
8:00 a.m. – 8:30 a.m. Morning Beverages ..... PBCCC, Level 1  
8:00 a.m. – 5:00 p.m. Social Media Lounge ..... PBCCC, Level 1  
8:30 a.m. – 5:00 p.m. Training Sessions..... Hilton & PBCCC  
8:30 a.m. – 5:00 p.m. Media Room..... PBCCC, Room 1J/K  
10:00 a.m. – 10:30 a.m. Networking Break..... PBCCC Escalator & Hilton Connector Door  
12:00 p.m. – 1:30 p.m. Lunch .....(on your own)  
3:00 p.m. – 3:30 p.m. Networking Break..... PBCCC Escalator & Hilton Connector Door

#### **Wednesday, May 14**

8:00 a.m. – 5:00 p.m. Registration Opens ..... PBCCC, Level 1  
8:00 a.m. – 8:30 a.m. Morning Beverages ..... PBCCC, Level 1  
8:00 a.m. – 5:00 p.m. Social Media Lounge ..... PBCCC, Level 1  
8:30 a.m. – 5:00 p.m. Media Room..... PBCCC, Room 1J/K  
8:45 a.m. – 11:00 a.m. General Session Sponsored by Indelible Solutions ..... PBCCC, Level 2, Grand Ballroom  
10:30 a.m. – 6:00 p.m. Exhibits..... PBCCC, Level 1, Exhibit Hall  
11:30 a.m. – 1:00 p.m. FEPA Board of Directors Meeting ..... Hilton, Cypress A&B  
12:00 p.m. – 1:30 p.m. Complimentary Lunch in Exhibit Hall ..... PBCCC, Level 1, Exhibit Hall  
1:30 p.m. – 5:00 p.m. Training Sessions..... Hilton & PBCCC  
3:00 p.m. – 3:30 p.m. Break in Exhibit Hall..... PBCCC Exhibit Hall  
5:00 p.m. – 6:00 p.m. Reception in Exhibit Hall ..... PBCCC Exhibit Hall  
6:15 p.m. – 7:30 p.m. American Red Cross Meeting ..... Hilton, Coral B

## Thursday, May 15

8:00 a.m. – 5:00 p.m.	Registration Opens .....	PBCCC, Level 1
8:00 a.m. – 8:30 a.m.	Morning Beverages .....	PBCCC Exhibit Hall
8:00 a.m. – 5:00 p.m.	Social Media Lounge .....	PBCCC, Level 1
8:00 a.m. – 12:00 p.m.	Exhibits.....	PBCCC, Level 1, Exhibit Hall
8:30 a.m. – 10:00 a.m.	Workshops .....	Hilton & PBCCC
8:30 a.m. – 5:00 p.m.	Media Room.....	PBCCC, Level 1, Room 1J/K
10:00 a.m. – 11:45 a.m.	Break & Dedicated Exhibit Time .....	PBCCC Exhibit Hall
11:45 a.m. – 1:30 p.m.	Awards Luncheon Sponsored by Indelible Solutions.....	PBCCC, Level 2, Grand Ballroom
1:30 p.m. – 5:00 p.m.	Workshops .....	Hilton & PBCCC
3:00 p.m. – 3:30 p.m.	Networking Break.....	PBCCC Escalator & Hilton Connector Door
5:30 p.m. – 7:00 p.m.	Florida VOAD Meeting .....	Hilton, Coral D/E

## Friday, May 16

8:00 a.m. – 8:30 a.m.	Morning Beverages .....	PBCCC, Level 1
8:30 a.m. – 12:00 p.m.	Workshops .....	Hilton & PBCCC
8:30 a.m. – 12:30 p.m.	Media Room.....	PBCCC, Level 1, Room 1J/K
10:00 a.m. – 10:30 a.m.	Networking Break.....	PBCCC, Level 1

### MOBILE APP

The session and presenter evaluations can now be completed directly through the mobile app. It is important to get your feedback on all sessions and speakers in order for the GHC to make improvements and offer a top rate attendee experience.

We encourage you to download the app to become familiar with all events offered at this year's conference. Search **GHC2025** in the App Store or in Google Play.

Or use the QR Code for the online version of the app.



Mobile App Sponsored by:





# 39<sup>th</sup> Governor's Hurricane Conference®

## General Session

Wednesday, May 14, 2025  
Palm Beach County Convention Center  
Grand Ballroom  
8:45 a.m. – 11:00 a.m.

### **Moderator**

Steve Weagle, Meteorologist  
WPTV

### **Honor Guard/ Pledge of Allegiance**

Palm Beach County Fire Rescue

### **National Anthem**

Alexander Drefoos School of the Arts

### **GHC President's Welcome**

Paul Womble  
Director  
Polk County Emergency Management

### **Welcome**

Maria Marino  
Mayor  
Palm Beach County

### Keynote Speakers

Jodie Fiske, Director  
*Manatee County Public Safety*  
Timothy Dudley, Jr., Director  
*Hillsborough County Emergency Management*  
Cathie Perkins, Director  
*Pinellas County Emergency Management*  
Sandra Tapfumaneyi, E.M. Chief  
*Sarasota County Emergency Services*

## Awards Luncheon

Thursday, May 15, 2025  
Palm Beach County Convention Center  
Grand Ballroom  
11:45 a.m. - 1:30 p.m.

### **Invocation**

### **Lunch**

### **Memorial Honors**

### **Awards Presentations**

Governor's Hurricane Conference®  
Members of the Board of Directors

## **GOVERNOR'S HURRICANE CONFERENCE®**

PO Box 279

Tarpon Springs, Florida 34688-0279

Phone: (727) 944-2724

Fax: (727) 944-2687

Email: [rene@flghc.org](mailto:rene@flghc.org)

Website: [www.flghc.org](http://www.flghc.org)



**Providing comprehensive and cost-effective  
emergency response and disaster  
recovery solutions since 1992.**

**J.R. Bergeron, Founder & CEO**

**BergeronEmergencyServices.com**



**Bergeron Emergency Services is proud to participate in the  
Florida Governor's Hurricane Conference focused on  
natural and man-made disasters, nationwide hurricane  
preparedness, planning, response, recovery, and mitigation.**

**We may be considered experts in emergency response and  
disaster recovery, but we are always up for being even better.**



## A New Name. **THE SAME LEGACY.**

Phillips Environmental is the newest chapter in a story that helped build the disaster response industry. Spun from the legacy of Phillips & Jordan—pioneers with decades of boots-on-the-ground experience—we're the same proven team with a singular focus on disaster recovery. Backed by the strength of the Phillips enterprise, we mobilize fast, scale big, and stay committed until the job is done. When communities need stability amid chaos, we deliver with precision, power, and purpose.





# EXHIBIT HALL MAP

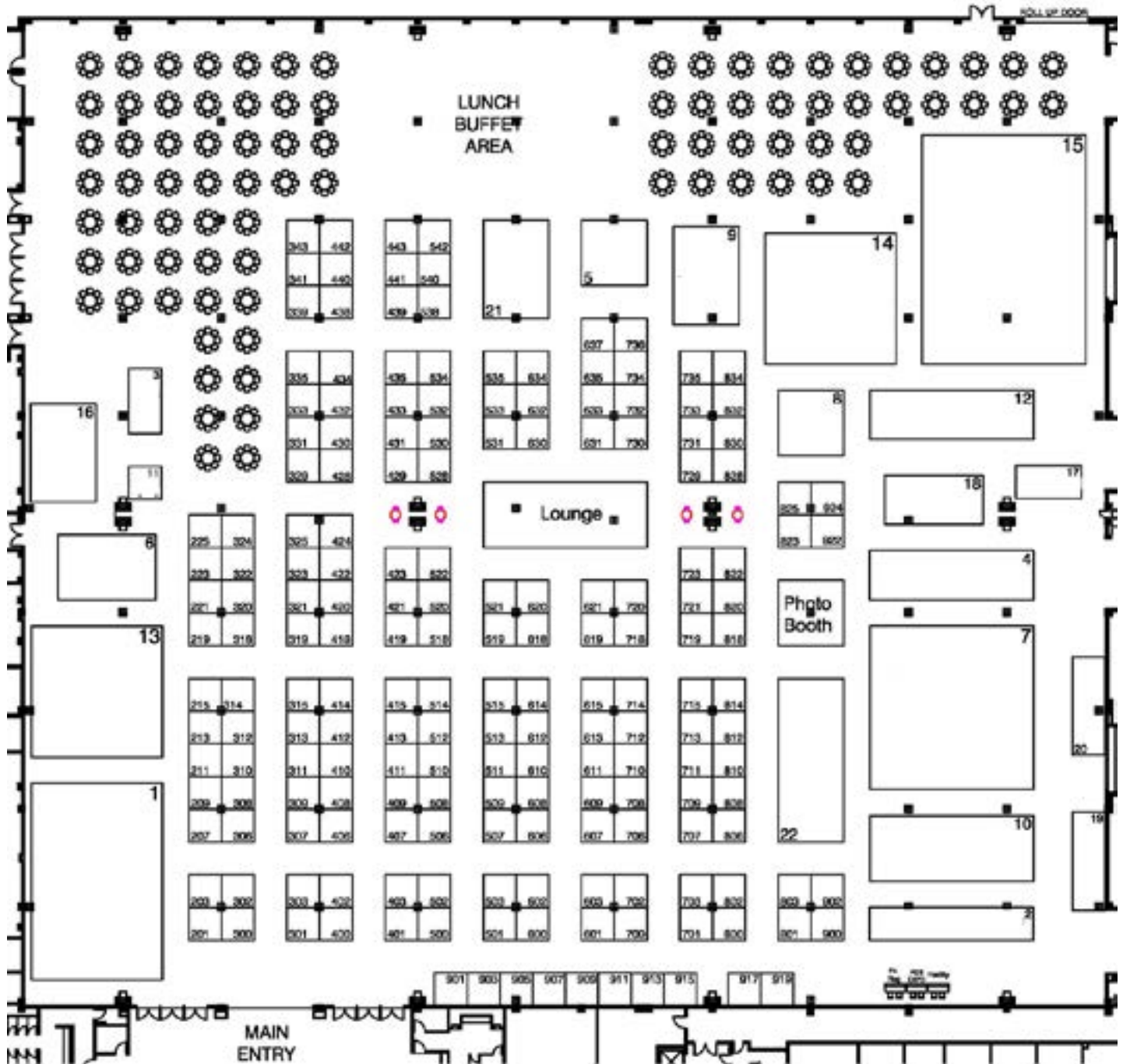

# 39<sup>th</sup> Annual Governor's Hurricane Conference®

## EXHIBITORS

as of 3/31/25

Company Name	Booth	FDOT / FL511	
AC Disaster Consulting	401	Federal Contracts Company	603
Advanced Roofing	324	FIRMAN Power Equipment	9
AeroClave	507	First Responder Network Authority	736
AGILE	611	FirstNet built by AT&T	637, 5
Airstar America, Inc	3	FloodBreak Automatic Floodgates	415
All Hands Consulting	300	Florida Independent Living Council	310
APTIM	424	Florida International University	318
AshBritt, Inc.	521	FLOWSTOP	320
ATL Diversified	518	Frontline Communications	12
BBA Pumps, Inc.	733	GA Foods	329
Beachview Logistics US, Inc.	532	Garner Environmental Services	800
BedEVAC, LLC	431	GCC (Guest Communications Corp)	407
Bergeron Emergency Services, Inc.	909	Global Sourcing Solutions	308
Bridgford Foods Corporation	528	Granny's Alliance Holdings, Inc.	319
Brief Relief	530	GrantWorks, Inc.	828
Byer Co., LLC	719	Ground Force Humanitarian Aid	339
Canopy Management Consulting Group LLC	614	Herzog	443
Carrier Rental Systems	612	HOIST Hydration	420
Cat5 Power Solutions	808	Hyatt Survey Services, Inc.	734
CDWG	302	IAEM	508
Ceres Environmental Services	501	Indelible Solutions	820
Chef Minute Meals	619	Innovare International, Inc.	534
Connecta Satellite Solutions	225	IRG Global Emergency Management	531
CrowderGulf	440	ISF, Inc.	423
CTC Disaster Response, Inc.	701	JAG Mobile Solutions	15
D&J Enterprises, Inc	729	Juware.com	503
DAVIS WATER SERVICE	718	Kelly & Company	601
DebrisTech	621	KPMG	818
Deployed Resources LLC.	618	LBiSat LLC	731
Disaster Program & Operations	221	LDV, Inc	10
DMG	428	LEMOINE	412
Doodie Calls	713	Lodging Solutions and Industrial Tent Systems	7
Dr. Shrink, Inc.	301	Looks Great Services of MS, Inc.	509
DRC Emergency Services/SLS	403	LTS	439
Duncan-Parnell	721	Macro Companies	408
eFactor3, LLC	702	Marden Ind DBA Supertrak	6
Emerge Marine	633	MCM Consulting Group, Inc	341
Emergency Relief Catering Company, LLC	421	Merit International	312
Emergency Vehicles, Inc.	4	Metric Consulting, LLC	620
Ernst & Young LLP	634	Midland Radio Corporation	429
ESR, LLC	438	Mitrtech	314
Esri	710	MLU Services	21
Exeter Architectural Products	515	MRE STAR	309

# 39<sup>th</sup> Annual Governor's Hurricane Conference®

## EXHIBITORS

as of 3/31/25

MSC Industrial Supply	806	SkyBase Communications LLC	303
myEMAapp.com	613	Skydyne	419
National Tent & Contractors	730	SMG Trailers	19
Neverflame	608	South Florida Electric, LLC	533
Nite Beam Products	203	Spot Coolers	907
nona Technologies	219	Stewart & Stevenson	801, 2
NOVAIR	215	Storm Services, LLC	632
Operation BBQ Relief	901	Stronger Than The Storm	631
Pantropic Power	514	Sun Coast Resources LLC	917
Paul Murray Oil, Inc.	307	Sunbelt Rentals	313
Peak Power Services	322	Sunbelt Solomon	506
Peplink	519	Sure-Pak 12 Meals	606
Peregrine	712	Taylor Power Systems, Inc.	8
Perimeter	735	TechOps Specialty Vehicles, LLC.	323
Phillips Environmental	422	Tetra Tech	432
Politac LLC	333	TFR Enterprises	430
Power Storage Solutions	732	The Blueprint Corporation	703
Precise Kit Promotions Inc	707	The BullBag® Corporation	20
Presray Corporation	411	The Sandbagger, LLC	500
Prism Lighting Services, LLC	11	Thompson Consulting Services	610
Procemx	409	Thunder Creek Equipment	17
ProLogic ITS	822	Tidal Basin	538
ProPac	16	Timberline Construction Group	700
PS Flood Barriers	311	T-Mobile	607, 18
Ranco Response	706	Tradewinds Power Corp	522
Rave Mobile Safety, a Motorola Solutions Company	602	Trinity Industrial	711
Ready America Inc	615	True North Emergency Management / Neel-Schaffer	510
Recovery Logistics LLC	413	U.S. Flood Control Corp.	400
Reverso	834	United Rentals, Inc.	14
Rich Specialty Trailers	22	United Site Services	343
ROK Brothers	331	USA Up Star	1
Royal Plus Disaster Cleanup	903	VECTOR Climate	913
Safety Products Inc	823	Verizon Frontline	335
Safeware Inc.	418	Versare Flooring	441
Salamander Technologies	433	Weatherhaven Resources, Inc.	922
Samdesk	213	WSP	406
Satellite Industries	13	Zebra Recovery	325
SDR	207		
SDS Weather	540		
Semler Industries	513		
ServiceMaster Recovery Management	209		
ServiceMaster Restoration Services	435		
Simeon Global Consulting LLC	635		



## EXHIBIT HALL EVENTS

Please visit the many vendors in the Exhibit Hall who support the GHC!



### Connect 2 Win!

**WIN a \$200 Amazon Gift Card from GHC - 5 Winners!**

**CONNECT with EXHIBITORS to WIN!**

Participating exhibitors have purchased a limited number of entry tickets. Exhibitors will distribute tickets (at their discretion) to attendees who make a 'connection' with them about their product or service. Fill out your tickets and put them in the raffle drum in the center of the exhibit hall. Five winners drawn during Exhibit Hall hours. You need not be present to win and can enter multiple tickets!

Participating exhibitors are listed on the MOBILE APP  
and the flyer in your portfolio!

---

## Photo Booth

While visiting our many exhibitors in the Exhibit Hall, stop by the Photo Booth where you will have the opportunity to picture yourself...literally...in the midst of a raging hurricane (and other disasters), and demonstrate to the world just how you would react to the experience. But wait...there's more! You will also be supplied with a photographic memento (a 4"x6" photo and on-site access to electronic format) that can be used not only to commemorate the event, but also to impress others with your bravery (hopefully!) and your preparedness prowess!

*This is underwritten as a free service to attendees by:*





**OVER 50 YEARS OF EXPERIENCE IN DISASTER RECOVERY**

**DEBRIS REMOVAL • REDUCTION • SITE MANAGEMENT • DEMOLITION**

The full-time D&J Enterprises disaster support team is dedicated to providing rapid, coordinated, and efficient response to any disaster situation that requires outside support. D&J has the personnel, equipment resources, strong financial backing, and experience necessary to do just that. Our extensive experience of over 50 years has created an abundance of knowledge and skills for our principals, managers, and personnel. With that experience and our ability to self-perform any size project immediately, D&J is your trusted partner in a time of need.



**334.821.1249 | 3495 LEE ROAD 10 | AUBURN, AL 36832**  
**WWW.HURRICANERECOVERY.COM**

## **2025 Training Sessions**

- TS1. EOC Resource Skillset (G2306)
- ~~TS2. Fundamentals of Grants Management (L0705) Canceled~~
- TS3. Emergency Planning (G235)
- TS4. Stronger Than the Storm: Psychological First Aid
- TS5. Homeland Security Exercise and Evaluation Program (HSEEP) (L146)
- TS6A. Leveraging GIS to Enhance Emergency Management Operations and Decision Making
- TS6B. Leveraging GIS to Enhance Emergency Management Operations and Decision Making (Repeat)
- ~~TS7. Free and User-Friendly GIS Tools for All Hazards Emergency Preparedness and Response Canceled~~
- TS8. Threat and Hazard Identification and Risk Assessment and Stakeholder Preparedness Review (MGT310)
- TS9. Community Mass Care Management (G108)
- ~~TS10. Tropical Meteorology 1: FEMA/EMI 311 – Hurricane Readiness Canceled~~
- ~~TS11. Tropical Decision Support – From Preparedness to Recovery Canceled~~
- ~~TS12. Examining Communications Principles & Hurricane Messaging Canceled~~
- ~~TS13. More Practical Lessons From Historical Hurricanes Canceled~~
- TS14. Emergency Operations Center (EOC) Tour
- TS15. Emergency Operations Center (EOC) Tour (repeat)
- ~~TS16. FEMA Procurement Under Grants (L0708) Canceled~~
- TS17. Introduction to HURREVAC
- TS18. Applications of HURREVAC***
- TS19. Planning for Disaster Debris Management (MGT460)
- TS20. Local Volunteers and Donations Management (G288)
- TS21. Evacuation Planning Strategies and Solutions (MGT461)
- TS22. PAWsitive Information About Service Animals
- TS23. From Planning to Practice: Inclusive Mass Care Strategies for Emergency Managers
- TS24. Small Animal Emergency Shelter Design – Facility Design & Environment***
- TS25. FEMA Disaster Recovery Reform Act: Section 1206
- TS26. Palm Beach County's Debris Mgmt. Plan: Tour the SWA's Renewable Energy Facility
- TS27. Facilitative Leadership Skills for Mobilizing the Community
- TS28. CliftonStrengths Assessment
- TS29. Management of Spontaneous Volunteers in Disasters (G489)

***BOLD ITALICS INDICATE ADVANCED LEVEL SESSION***



# **2025 Training Session Descriptions**

## **TS1. EOC Resource Skillset (G2306) – Organized by Jeff Goldberg**

Sunday, May 11, 1:30 p.m. – 5:00 p.m. PBCCC 1B  
Monday, May 12, 8:30 a.m. – 5:00 p.m.  
Tuesday, May 13, 8:30 a.m. – 5:00 p.m.  
Wednesday, May 14, 1:30 p.m. – 5:00 p.m.

The primary goal of this course is to provide participants with a practical learning experience on the EOC skillsets associated with resource support tasks. This training aims to enhance individuals in resource roles' understanding of the responsibilities and processes involved in EOC resources, including the development of essential documentation and the continual management of information across multiple agencies and personnel for effective EOC operations.

### **Prerequisites:** IS2200 – Basic EOC Functions

Students must download or print out materials before coming to class (instructor to provide link)

Level: Basic

Limit: 35

## **TS3. Emergency Planning (G235) - Organized by Jeff Goldberg**

Monday, May 12, 8:30 a.m. – 5:00 p.m. PBCCC 1C  
Tuesday, May 13, 8:30 a.m. – 5:00 p.m.  
Wednesday, May 14, 1:30 p.m. – 5:00 p.m.

This course offers training in the fundamentals of the emergency planning process, including the rationale behind planning. It will develop the capability for effective participation in the all-hazard emergency operations planning process to save lives and protect property threatened by disasters. This training is part of the FEMA Advanced Professional Series Certificate.

### **Prerequisites:** Students must download or print out materials before coming to class (instructor to provide link)

Level: Basic

Limit: 45

## **TS4. Stronger Than the Storm: Psychological First Aid – Organized by Christy Rojas**

Monday, May 12, 8:30 a.m. – 5:00 p.m. PBCCC 1D

Stronger than the Storm has partnered with the Network for Enhancing Wellness in Disaster-Affected Youth (or NEW DAY) - a SAMHSA-funded and National Child Traumatic Stress Network affiliated program, to train participants on Psychological First Aid (PFA). PFA is a technique designed to reduce the occurrence of post-traumatic stress disorder. PFA is an evidence-informed modular approach to help children, adolescents, adults, and families in the immediate aftermath of disaster and terrorism. PFA is designed to reduce the initial distress caused by traumatic events and to foster short and long-term adaptive functioning and coping. Principles and techniques of PFA meet four basic standards. They are: 1) consistent with research evidence on risk and resilience following trauma; 2) applicable and practical in field settings; 3) appropriate for developmental levels across the lifespan; and 4) culturally informed and delivered in a flexible manner. The PFA training will provide participants with the knowledge and skills necessary to use PFA in the aftermath of disasters/terrorism with survivors.

Level: Basic

Limit: 45

## **TS5. Homeland Security Exercise and Evaluation Program (HSEEP) (L146) – Organized by Jeff Goldberg**

Monday, May 12, 8:30 a.m. – 5:00 p.m. PBCCC 1E  
Tuesday, May 13, 8:30 a.m. – 5:00 p.m.  
Wednesday, May 14, 1:30 p.m. – 5:00 p.m.

The Homeland Security Exercise and Evaluation Program (HSEEP) (L146) is an intermediate-level course designed to provide a set of guiding principles, standardized methodology, available resources and practical skill development, which will assist in developing an HSEEP consistent exercise program. This course describes a common approach to exercise program management, design and development, conduct, evaluation, and improvement planning. HSEEP is an intermediate-level course and participants should come with a basic understanding of exercise design.

**Prerequisites:** IS-120.C: An Introduction to Exercises; IS-130.A: Exercise Evaluation and Improvement Planning  
Students must download or print out materials before coming to class (instructor to provide link)

Level: Basic  
Limit: 35

TS6A. Leveraging GIS to Enhance Emergency Management Operations and Decision Making – *Organized by Eve Rainey*

Monday, May 12, 8:30 a.m. – Noon PBCCC 2A

This is a dynamic, hands-on session designed to engage emergency management professionals in the power of GIS. Through collaborative group activities, brainstorming, and real-world scenarios, participants will explore how spatial thinking and GIS tools can improve disaster response, resource management, and decision-making. Attendees will work together on exercises like flood response planning, search and rescue coordination, and critical infrastructure protection, learning how GIS can optimize evacuation routes, monitor real-time data, and map vulnerabilities. No prior GIS experience is required. Participants will gain insights into how spatial data can enhance emergency operations and leave with practical, actionable ideas for incorporating GIS into their current workflows. This session is ideal for public safety officials, disaster response coordinators, and other professionals eager to strengthen their decision-making capabilities using spatial tools. Whether you're looking to start small or integrate GIS into a broader strategic initiative, this interactive roundtable will inspire new approaches to managing emergencies and protecting communities.

Level: Basic  
Limit: 30

TS6B. Leveraging GIS to Enhance Emergency Management Operations and Decision Making (Repeat) – *Organized by Eve Rainey*

Monday, May 12, 1:30 p.m. – 5:00 p.m. PBCCC 2A

This is a dynamic, hands-on session designed to engage emergency management professionals in the power of GIS. Through collaborative group activities, brainstorming, and real-world scenarios, participants will explore how spatial thinking and GIS tools can improve disaster response, resource management, and decision-making. Attendees will work together on exercises like flood response planning, search and rescue coordination, and critical infrastructure protection, learning how GIS can optimize evacuation routes, monitor real-time data, and map vulnerabilities. No prior GIS experience is required. Participants will gain insights into how spatial data can enhance emergency operations and leave with practical, actionable ideas for incorporating GIS into their current workflows. This session is ideal for public safety officials, disaster response coordinators, and other professionals eager to strengthen their decision-making capabilities using spatial tools. Whether you're looking to start small or integrate GIS into a broader strategic initiative, this interactive roundtable will inspire new approaches to managing emergencies and protecting communities.

Level: Basic  
Limit: 30

TS8. Threat and Hazard Identification and Risk Assessment and Stakeholder Preparedness Review (MGT310) – *Organized by Jeff Goldberg*

Monday, May 12, 8:30 a.m. – 5:00 p.m. PBCCC 2B  
Tuesday, May 13, 8:30 a.m. – 5:00 p.m.

This course will prepare participants to conduct a community Threat and Hazard Identification and Risk Assessment/ Stakeholder Preparedness Review (THIRA/SPR). Participants will identify threats and hazards of community concern, give those threats context, establish capability targets and determine how to apply the THIRA/SPR results. By using the THIRA/SPR process, stakeholders will develop a strategy to allocate resources and establish mitigation and preparedness activities. THIRA/SPR informed planning is consistent with and expands on nationally accepted emergency management standards as the basis for

planning this course, in combination with AWR213, MGT315, MGT414, and MGT452 are awarded the TEEX Infrastructure Protection Certificate.

**Prerequisites:** Must be a U.S. citizen to attend this session. Students must **bring their laptop** to class. We recommend bringing your own WIFI hotspot, if possible.

Level: Basic

Limit: 40

TS9. Community Mass Care Management (G108) – *Organized by Jessica Geib*

Monday, May 12, 8:30 a.m. – 5:00 p.m.

PBCCC 2C

Tuesday, May 13, 8:30 a.m. – 5:00 p.m.

This course provides training for local communities to prepare for and manage the Mass Care/Emergency Assistance (MC/EA) functions effectively. The goal is to prepare community agencies, organizations, and businesses to work together in coordination with emergency management and traditional MC providers to plan and provide MC/EA services to those affected by disaster. Participants will develop foundational knowledge of Mass Care and Emergency Assistance services in the community. It is not a “how to” for sheltering. Course information will be used to build community emergency action items and to identify gaps in the local jurisdiction’s program.

This course is intended for MC coordinators, management staff, non-governmental organization leaders, private sector, and other emergency management staff that are a part of the team and have a responsibility for effective MC/EA preparedness and response.

**Prerequisites:** Students must download or print out materials before coming to class (instructor to provide link)

Level: Basic

TS14. Emergency Operations Center (EOC) Tour – *Organized by John Jamason*

Monday, May 12, 8:00 a.m. – 5:00 p.m.

Offsite, Shuttle Bus

A well-designed and fully functional Emergency Operations Center (EOC) is critical for the successful management of disasters. This six-hour training session includes visits to three (3) area EOC’s including the Palm Beach County EOC, the City of West Palm Beach EOC, and the South Florida Water Management District EOC. Presentations will include information on organizing, staffing, and operating these facilities. Best practices will also be shared. Bus loads at 8:00 a.m. at the southeast entrance of the convention center.

**Please note: Lunch is scheduled for one hour after the second tour at a local restaurant along the route. Attendees are responsible for their own meal costs and payment.**

Level: Basic

Limit: 35

TS15. Emergency Operations Center (EOC) Tour (repeat) – *Organized by John Jamason*

Tuesday, May 13, 8:00 a.m. – 5:00 p.m.

Offsite, Shuttle Bus

A well-designed and fully functional Emergency Operations Center (EOC) is critical for the successful management of disasters. This six-hour training session includes visits to three (3) area EOC’s including the Palm Beach County EOC, the City of West Palm Beach EOC, and the South Florida Water Management District EOC. Presentations will include information on organizing, staffing, and operating these facilities. Best practices will also be shared. Bus loads at 8:00 a.m. at the southeast entrance of the convention center.

**Please note: Lunch is scheduled for one hour after the second tour at a local restaurant along the route. Attendees are responsible for their own meal costs and payment.**

Level: Basic Limit: 35



TS17. Introduction to HURREVAC – Organized by René Daines

Tuesday, May 13, 8:30 a.m. – Noon

PBCCC 1L

The National Hurricane Program's Decision Support Tool (HURREVAC) is a free web-based platform available to government emergency managers that provides evacuation timing guidance. HURREVAC combines real-time National Hurricane Center forecast products and storm surge modeling with evacuation clearance times from hurricane evacuation studies. The focus of the *Introduction to HURREVAC* training is to discuss HURREVAC features and functionality and provide a demonstration of the user interface. **Prerequisites:** Students must **bring their laptop** to this session and register for a web-based HURREVAC account: <https://hvx-registration.hurrevac.com/?go=account:register>. We recommend bringing your own WIFI hotspot, if possible.

Level: Basic

Limit: 50

TS18. Applications of HURREVAC – Organized by René Daines

Tuesday, May 13, 1:30 p.m. – 5:00 p.m.

PBCCC 1L

The National Hurricane Program's Decision Support Tool (HURREVAC) is a free web-based platform available to government emergency managers that provides evacuation timing guidance. HURREVAC combines real-time National Hurricane Center forecast products and storm surge modeling with evacuation clearance times from Hurricane Evacuation Studies. The Applications of HURREVAC training session's purpose is to demonstrate how to apply decision support functionality based on hurricane scenarios, including hurricane hazard risk assessment and evacuation timing guidance.

Intro to HURREVAC is not a prerequisite for Applying HURREVAC, however we strongly recommend that any new users take the Introductory offering first. This session does not cover basics, and assumes that users have some familiarity with program operation, either from the preceding Intro session or other previous experience.

**Prerequisites:** Students must **bring their laptop** to this session and register for a web-based HURREVAC account: <https://hvx-registration.hurrevac.com/?go=account:register>. We recommend bringing your own WIFI hotspot, if possible.

Level: Advanced

Limit: 50

TS19. Planning for Disaster Debris Management (MGT460) – Organized by Jeff Goldberg

Monday, May 12, 8:30 a.m. – 5:00 p.m.

PBCCC 2D

This management-level instructor-led course will provide lectures, knowledge checks, and course module tools/activities on pre-disaster debris management planning. The focus of the course is to identify debris management plan components and best planning practices using existing plan examples and case studies and to draft an outline of a debris management plan. This course will empower participants to create pre-disaster debris management plans for their own communities.

Level: Basic

Limit: 45

TS20. Local Volunteers and Donations Management (G288) – Organized by Christy Rojas

Tuesday, May 13, 8:30 a.m. – 5:00 p.m.

Hilton Coral B

Wednesday, May 14, 1:30 p.m. – 5:00 p.m.

This training will support local governments and their emergency management partners in preparing for, responding to, and recovering from disaster events at the local level. The course is designed to strengthen the abilities of local jurisdictions to successfully prepare for and handle volunteer and donations management issues that may arise. The course content and activities may also serve as a template, thereby enhancing uniformity in addressing areas of donated unsolicited goods, unaffiliated volunteers,

and undesignated cash. This training also provides information regarding the state's volunteer and donations management responsibilities, which are designed to help build relationships between government and non-governmental organizations. Identify how to manage effectively the surge of unsolicited goods. Gather information from organizations, agencies, volunteers, media, and others for donations intelligence purposes. Facilitate the matching of unaffiliated volunteers with appropriate organizations or agencies during program implementation. List the planning considerations for cash donations. Incorporate technology needed to manage successfully information on unaffiliated volunteers and unsolicited goods. Relate volunteer and donations management program responsibilities to the planning components of the annex.

**Prerequisites:** Students must download or print out materials before coming to class (instructor to provide link)

Level: Basic

Limit: 30

TS21. Evacuation Planning Strategies and Solutions (MGT461) – *Organized by Jeff Goldberg*

Tuesday, May 13, 8:30 a.m. – 5:00 p.m.

PBCCC 2D

This management-level course is designed to provide emergency managers, first responders, transportation professionals, security and safety professionals, and government administrators with the ability to utilize current tools and technologies to institute best practices and strategies to plan for and execute an emergency evacuation. This course discusses the hazard conditions for which an emergency evacuation could be an appropriate protective action and inform participants of resources and methods to help them better prepare for an emergency evacuation. This course will allow participants to explore data, modelling tools, and simulations that assist with the implementation of an emergency evacuation.

Level: Basic

Limit: 45

TS22. PAWsitive Information About Service Animals – *Organized by René Daines*

Wednesday, May 14, 1:30 p.m. – 5:00 p.m.

PBCCC 1A

Come see some PAWsome PAWfessionals at work! The audience will learn the different types of jobs service animals provide as well as the legal definition of a service animal, recent changes pertaining to service animals and the differences between other types of working animals such as police work, search and rescue, emotional and therapy animals. Where they can go and what they can do. Live demo at the end.

Level: Basic

Limit: 35

TS23. From Planning to Practice: Inclusive Mass Care Strategies for Emergency Managers – *Organized by Alison Osborn*

Wednesday, May 14, 1:30 p.m. – 5:00 p.m.

PBCCC 1L

In times of disaster, jurisdictions face the daunting task of delivering essential mass care services to their communities. However, managing these services—particularly ensuring the inclusion of individuals with disabilities and others with access and functional needs—presents significant challenges. This course is specifically designed for emergency management, VOAD, and public health professionals dedicated to developing comprehensive, inclusive plans that serve the entire community. Participants will explore strategies for integrating the principles of Whole Community Planning to effectively plan, coordinate, and implement mass care services that align with legal requirements and ethical standards. The course will also address the traditionally overlooked needs of individuals with autism, ensuring these marginalized populations are appropriately considered and supported during disasters. At the end of the course, participants will have the skills and knowledge to develop inclusive mass care plans that prioritize equity and accessibility, ensuring the needs of all community members are effectively addressed.

Level: Basic

Limit: 50

**TS24. Small Animal Emergency Shelter Design – Facility Design & Environment – Organized by Christy Rojas**

Wednesday, May 14, 1:30 p.m. – 5:00 p.m. PBCCC 2A

This interactive training adapts Module 3 from the Level 2 Operations Course and incorporates key concepts from Modules 1 and 2 (ICS, Biosecurity) to guide students through shelter design. Participants will tackle various disaster scenarios, assess shelter options (pre-existing or temporary structures), and consider factors like animal types, logistical challenges, and available resources to develop practical sheltering solutions. Students will collaborate on their designs and present their findings, offering alternatives and suggestions for improvement.

**Prerequisites:** It is strongly recommended students register for, and take the SART Pet Friendly Online Sheltering Course found at: <https://flsart.org/training/petshelter/> and have a current ICS 100 FEMA Certificate.

Level: Advanced  
Limit: 30

**TS25. FEMA Disaster Recovery Reform Act: Section 1206 – Organized by Lee Mayfield**

Wednesday, May 14, 1:30 p.m. – 5:00 p.m. PBCCC 2C

Under the Disaster Recovery Reform Act Section 1206, FEMA Public Assistance will reimburse eligible costs to help local governments scale up to meet the demand from the public while they make repairs and meet FEMA National Flood Insurance Program requirements for substantial damage assessments and determinations. Designed for emergency managers, this training will provide an overview of Section 1206 of the Disaster Recovery Reform Act (DRRA) and what the potential increased demand on local government services could look like after a hurricane. The training will focus on key roles and responsibilities, how to scale up to meet federal requirements and public demand, and how to set your jurisdiction up to be reimbursed for these costs after a disaster.

Level: Basic  
Limit: 55

**TS26. Palm Beach County's Debris Management Plan: Tour the SWA's Renewable Energy Facility – Organized by John Jamason**

Wednesday, May 14, 1:00 p.m. – 5:00 p.m. Offsite, Shuttle Bus

This three-hour on-site experience will include Solid Waste Authority of Palm Beach County emergency response staff presenting its debris management plan, which includes inter-local agreements with most municipalities, four qualified contractors, and nine potential sites to manage post-storm debris; a discussion with the waste-to-energy operator(s) on their storm preparation and recovery plans to allow them to continue to operate after an event and an interactive tour of a renewable energy facility to see an almost \$700 million community investment in the cleanest, greenest waste-to-energy facility in North America.

**Prerequisites:** Attendees must wear close-toed shoes during tour

Level: Basic  
Limit: 35

**TS27. Facilitative Leadership Skills for Mobilizing the Community – Organized by Robbie Sofaly**

Tuesday, May 13, 8:30 a.m. – 5:00 p.m. PBCCC 2E

This training is a professional development course. It discusses what is meant by the term facilitative leadership, as well as the challenges associated with being a Facilitative Leader. Participants examine some of the theories and practices relevant to facilitation and then apply them to situations in which they are asked to mobilize the community. Role plays that center around working with stakeholders and partners give participants a chance to apply models for interest-based problem solving and intervention.



The purpose of this course is to prepare participants to be effective facilitative leaders when mobilizing the community to meet client and community disaster-caused needs.

Level: Basic  
Limit: 30

TS28. CliftonStrengths Assessment – Organized by Robbie Sofaly

Wednesday, May 14, 1:00 p.m. – 5:00 p.m. PBCCC 2E

CliftonStrengths is a professional development course and assessment designed for professionals to pinpoint their unique talents within a work environment. By identifying these strengths, individuals can enhance their skills, acknowledge weaknesses, and optimize their overall performance. During this training session led by a certified Clifton Instructor, participants will undergo the assessment process to gain valuable insights into their personal talents.

Level: Basic  
Limit: 30

TS29. Management of Spontaneous Volunteers in Disasters (G489) – Organized by Christy Rojas

Monday, May 12, 8:30 a.m. – 5:00 p.m. PBCCC 2E

This course is designed to identify those issues and challenges in the management of spontaneous volunteers; how to manage these volunteers, develop a plan for your community; learn how to utilize and operate a Volunteer Reception Center (VRC). This course will also discuss best practices for managing volunteers including their use by VOADs. This course includes the setting up of a VRC and participants will exercise the skills they have learned to simulate a VRC.

Level: Basic  
Limit: 30



FLAMELESS • PORTABLE • COOKING

**Introducing Neverflame** – the game-changing **flameless, fumeless, eco-friendly** cooking and power solution for emergencies, outdoor adventures, and everyday use.

Cook safely **indoors or out**, on-the-go or on location, with zero flames, toxic fumes, or carbon monoxide. Heat meals, boil liquids, and power devices—all with one compact unit.

**Weights just 2–5 lbs**, powers electronics up to a week on one charge, and recharges over **600 times** via solar, vehicle, or wall outlet.

***Power Anywhere. Cook Everywhere. Total Peace of Mind.***

Come see us to learn more at **Booth 608**

[www.neverflame.com](http://www.neverflame.com)

(833) NVR-FLAM 833-687-3526 ext. 1 for Sales



SCAN FOR MORE INFO



#### RESTROOM TRAILERS



CC7024



FS810

#### BUNK BED TRAILERS



BK342



#### SHOWER TRAILERS



SWT7123



SWT4416

[WWW.RichSpecialtyTrailers.com](http://WWW.RichSpecialtyTrailers.com)

## WHEN THE STORM HITS, WE'VE GOT YOU COVERED.

*Tarps & Sandbags – Ready When You Need Them Most.*



*Disaster response is about speed, reliability, and preparation. That's why agencies across the hurricane prone states trust our contracted pricing for rapid access to high-quality tarps & sandbags.*

- Existing Government Contracts
- Biggest Variety, and Top Quality
- Fast, and Reliable Delivery

**AIS** | ALLINSAFETY



**Jonathan Gruenebaum**  
Government Relations Specialist  
800.376.8415 x115  
[jonathan@allinsafety.com](mailto:jonathan@allinsafety.com)



# 39<sup>th</sup> Annual Governor's Hurricane Conference

## 2025 TRAINING SESSIONS

Room	Sunday, May 11 <sup>th</sup>	
	1:30 p.m. - 5:00 p.m.	
1B	TS1. EOC Resource Skillset (G2306) – day 1 (limit 35)	
1GHI	<del>TS2. Fundamentals of Grants Management (L0705) – day 1 (limit 70)</del> <b>Canceled</b>	

Room	Monday, May 12 <sup>th</sup>	
	8:30 a.m. - 12:00 p.m.	1:30 p.m. – 5:00 p.m.
1B	TS1. EOC Resource Skillset (G2306) – day 2 (limit 35)	
1C	TS3. Emergency Planning (G235) – day 1 (limit 35)	
1D	TS4. Stronger than the Storm: Psychological First Aid (limit 45)	
1E	TS5. Homeland Security Exercise and Evaluation Program – day 1 (limit 35)	
1GHI	<del>TS2. Fundamentals of Grants Management (L0705) – day 2 (limit 70)</del> <b>Canceled</b>	
2A	TS6A. Leveraging GIS to Enhance Emergency Management Operations and Decision-Making (limit 30)	TS6B. Leveraging GIS to Enhance Emergency Management Operations and Decision-Making (Repeat) (limit 30)
2B	TS8. Threat and Hazard Identification and Risk Assessment and Stakeholder Preparedness Review (MGT310) – day 1	
2C	TS9. Community Mass Care/Emergency Assistance (G108) – day 1 (limit 30)	
2D	TS19. Planning for Disaster Debris Management (MGT460) – (limit 45)	
2E	TS29. Management of Spontaneous Volunteers in Disasters (G489)	
Hilton Coral C	<del>TS10. Tropical Meteorology 1: Hurricane Readiness for Coastal Communities (L0311) (limit 90)</del> <b>Canceled</b>	
Off-Site, Bus	TS14. Emergency Operations Center Tour ( <b>bus loads at 8:00 a.m.</b> ) (limit 35)	

Room	Tuesday, May 13 <sup>th</sup>	
	8:30 a.m. - 12:00 p.m.	1:30 p.m. - 5:00 p.m.
1B	TS1. EOC Resource Skillset (G2306) – day 3 (limit 35)	
1C	TS3. Emergency Planning (G235) – day 2 (limit 35)	
1D	<del>TS16. FEMA Procurement Under Grants (L0708) – day 1 (limit 45)</del> <b>Canceled</b>	
1E	TS5. Homeland Security Exercise and Evaluation Program – day 2 (limit 35)	
1GHI	<del>TS2. Fundamentals of Grants Management (L0705) – day 3 (limit 70)</del> <b>Canceled</b>	
1L	TS17. Introduction to HURREVAC (limit 50)	TS18. Applications of HURREVAC (limit 50)
2B	TS8. Threat and Hazard Identification and Risk Assessment and Stakeholder Preparedness Review (MGT310) – day 2	
2C	TS9. Community Mass Care/Emergency Assistance (G108) – day 2 (limit 30)	
2D	TS21. Evacuation Planning Strategies and Solutions (MGT461) (limit 45)	
2E	TS27. Facilitative Leadership Skills for Mobilizing the Community (limit 25)	
Hilton Coral B	TS20. Local Volunteers and Donations Management (G288) - day 1 (limit 30)	
Hilton Coral C	<del>TS11. Tropical Decision Support – From Preparedness to Recovery (limit 90)</del> <b>Canceled</b>	<del>TS12. Examining Communications Principles &amp; Hurricane Messaging (limit 90)</del> <b>Canceled</b>
Off-Site, Bus	TS15. Emergency Operations Center Tour ( <b>bus loads at 8:00 a.m.</b> ) (limit 35)	

Room	Wednesday, May 14 <sup>th</sup>	
	1:30 p.m. - 3:00 p.m.	3:30 p.m. - 5:00 p.m.
1A	TS22. PAWsitive Information about Service Animals (limit 35)	
1B	TS1. EOC Resource Skillset (G2306) – day 4 (limit 35)	
1C	TS3. Emergency Planning (G235) – day 3 (limit 35)	
1D	<del>TS16. FEMA Procurement Under Grants (L0708) – day 2 (limit 45)</del> <b>Canceled</b>	
1E	TS5. Homeland Security Exercise and Evaluation Program – day 3 (limit 35)	
1GHI	<del>TS2. Fundamentals of Grants Management (L0705) – day 4 (limit 70)</del> <b>Canceled</b>	
1L	TS23. From Planning to Practice: Inclusive Mass Care Strategies for Emergency Managers (limit 50)	
2A	<b>TS24. Small Animal Emergency Shelter Design – Facility Design &amp; Environment</b> (limit 30)	
2C	TS25. FEMA Disaster Recovery Reform Act: Section 1206 (limit 55)	
2E	TS28. CliftonStrengths Assessment (limit 25)	
Hilton Coral B	TS20. Local Volunteers and Donations Management (G288) - day 2 (limit 30)	
Hilton Coral C	<del>TS13. More Practical Lessons from Historical Hurricanes (limit 90)</del> <b>Canceled</b>	
Off-Site, Bus	TS26. Palm Beach County's Debris Management Plan: Tour the SWA's Renewable Energy Facility ( <b>bus loads at 1:00 p.m.</b> ) (limit 35)	



# 39<sup>th</sup> Annual Governor's Hurricane Conference

## 2025 WORKSHOPS

Room	Thursday 8:30 a.m. – 10:00 a.m.	Thursday 1:30 p.m. – 3:00 p.m.	Thursday 3:30 p.m. – 5:00 p.m.	Friday 8:30 a.m. – 10:00 a.m.	Friday 10:30 a.m. - Noon
<b>Palm Beach County Convention Center</b>					
1A	WS101. One Team, One Voice: County and Municipalities Working Together for Their Community	WS113. Your Florida State Guard-An Introduction	WS125. Other Emergency Feeding Options	WS137. Are You FEPA Certified?	WS149. Academic Research Presentations
1BC	WS102. Building a Ready & Resilient Disaster Response & Recovery Team	WS114. Preparing For and Responding to Hurricanes at the City Level-Best Practices	WS126. Rebuilding Utility Resilience: Pinellas County's Approach for Stronger Collaboration	WS138. Working Effectively with Elected Officials During Hurricane Preparedness, Response, & Recovery	WS150. FEMA Public Assistance in Florida – Hot Topics & Lessons Learned
1DE	WS103. Turning Setbacks into Comebacks: Understanding FEMA's Updated Appeals Process Rules	WS115. Healthcare Evacuation and Coordination - Helene/Milton Pane	WS127. Exploring F-ROC: A Game-Changer for Florida Communities	WS139. Changing How We Look at Situational Awareness in the EOC While Leveraging Technology	WS151. Atlantic Basin Hurricane Season Prediction/Outlook
1GHI	WS104. The Pinellas County Response Story: 2024 Hurricane Season	WS116. The Pinellas County Recovery Story: 2024 Hurricane Season	WS128. Leveraging AI for Effective Business Continuity and Risk Management	WS140. Leveraging AI for Smarter Response and Recovery	WS152. A.I. 101: Explanation of A.I. and Its Implications
1L	WS105. Hurricane Response in Fiscally Constrained Counties	WS117. The State of HURREVAC <b>Canceled</b>	WS129. Pre-Storm Preparation, Volunteer Mobilization and Other Lessons Learned from Previous Response Efforts	WS141. Partnerships to Bridge the GAP: Mass Care and Community Based Healthcare	WS153. Hurricane Milton: The Sarasota and Manatee County Story
2A	WS106. Empowering Rural Counties: Strengthening Volunteer and Donations Management and COADs	WS118. How Government and VOADS Can Collaborate for Response, Recovery, & Building Stronger, More Resilient Communities	WS130. From Shelter to Stability: Navigating Human Needs Solutions After Disaster	WS142. Florida Voluntary Organizations Active in Disaster: 35 Years Practicing the 4C's	WS154. Supporting Access and Functional Needs Populations Before, During, and After a Tropical Event
2BC	WS107. Community Engagement: Recovery Center Operations	WS119. Substantial Damage and Section 1206 – Best Practices and Resource Coordination Strategies	WS131. The ABC's of Debris Operations	WS143. CDBG Funding – Past, Present, Future	WS155. The Art of Finding Harmony! A Discussion of the Journey of 1st Time CDBG-DR Grantees
2DE	WS108. Mitigating First Responder Occupational Stress During Hurricane Operations	WS120. E-PLUS: Helping You Help Others <b>Canceled</b>	WS132. Using Technology of Coordination and Review of Healthcare CEMPs	WS144. Recovery Support Functions in Action	WS156. Hurricane-Related Fatalities: The Who, Where, When, and How
2F	WS109. Leading and Managing People During Blue Skies and Grey Skies	WS121. Florida Communications Unit ESF2: Disaster Season Roundtable	WS133. Urban Search & Rescue Deployment and Support	WS145. Disaster Legal Issue Spotting: An Interactive Workshop	WS157. Bull Horns, Billboards, Banner Planes & Beyond

<b>Hilton West Palm Beach</b>					
Hilton Coral AB	WS110. From Command to Collaboration: Advancing EM with the Incident Support Model	WS122. Emergency Operations Center Management: Best Practices for Running Your EOC During a Large-Scale Incident	WS134. Rebuilding Together Florida - Strategies for Sustainable Disaster Recovery Across Florida	WS146. Navigating Cybersecurity, Infrastructure Security, and Sustainability in the 911/Emergency Communications	
Hilton Coral C	WS111. Tropical Program: We Want to Hear More from You <b>Canceled</b>	WS123. The Implications of River Flooding and Florida Hurricanes <b>Canceled</b>	WS135. Adding Clarity, Confirmation, and Reach to Public Information <b>Canceled</b>	WS147. Leveraging Probability Data through GIS for Tropical Decision Support <b>Canceled</b>	WS158. Tornado Threats & Impacts with Hurricane Milton and Lessons Learned
Hilton Coral DE	WS112. Understanding State & Federal Procurement in Disasters	WS124. Two Steps Forward, One Step Back: The Impacts of Successive Disasters on Long-Term Recovery Efforts	WS136. You're Going to Need More Than Ice, Water, and Fuel: Modern Day Logistical Challenges	WS148. Housing Mitigation Strategies 101	WS159. The Politics of Disasters and Leading During Crisis

# 2025 Workshops

- WS101. One Team, One Voice: County and Municipalities Working Together for Their Community
- WS102. Building a Ready & Resilient Disaster Response & Recovery Team
- WS103. Turning Setbacks into Comebacks: Understanding FEMA's Updated Appeals Process Rules & What to Expect in Arbitration
- WS104. The Pinellas County Response Story: 2024 Hurricane Season
- WS105. Hurricane Response in Fiscally Constrained Counties
- WS106. Empowering Rural Counties: Strengthening Volunteer and Donations Management and COADs
- WS107. Community Engagement: Recovery Center Operations
- WS108. Mitigating First Responder Occupational Stress During Hurricane Operations
- WS109. Leading and Managing People During Blue Skies and Grey Skies
- WS110. From Command to Collaboration: Advancing EM with the Incident Support Model
- ~~WS111. Tropical Program: We Want to Hear More from You~~ Canceled
- WS112. Understanding State & Federal Procurement in Disasters
- WS113. Your Florida State Guard - An Introduction
- WS114. Preparing For and Responding to Hurricanes at the City Level - Best Practices
- WS115. Healthcare Evacuation and Coordination - Helene/Milton Panel
- WS116. The Pinellas County Recovery Story: 2024 Hurricane Season
- ~~WS117. The State of HURREVAC~~ Canceled
- WS118. How Government and VOADS Can Collaborate for Response, Recovery, & Building Stronger, More Resilient Communities
- WS119. Substantial Damage and Section 1206 – Best Practices and Resource Coordination Strategies
- ~~WS120. E-PLUS: Helping You Help Others~~ Canceled
- WS121. Florida Communications Unit ESF2: Disaster Season Roundtable
- WS122. Emergency Operations Center Management: Best Practices for Running Your EOC During a Large-Scale Incident
- ~~WS123. The Implications of River Flooding and Florida Hurricanes~~ Canceled
- WS124. Two Steps Forward, One Step Back: The Impacts of Successive Disasters on Long-Term Recovery Efforts
- WS125. USDA and Other Emergency Feeding Options
- WS126. Rebuilding Utility Resilience: Pinellas County's Approach for Stronger Collaboration
- WS127. Exploring F-ROC: A Game-Changer for Florida Communities
- WS128. Leveraging AI for Effective Business Continuity and Risk Management
- WS129. Pre-Storm Preparation, Volunteer Mobilization and other Lessons Learned from Previous Response Efforts
- WS130. From Shelter to Stability: Navigating Human Needs Solutions After Disaster
- WS131. The ABC's of Debris Operations
- WS132. Using Technology of Coordination and Review of Healthcare CEMPs
- WS133. Urban Search & Rescue Deployment and Support
- WS134. Rebuilding Together Florida-Strategies for Sustainable Disaster Recovery Across Florida

~~WS135. Adding Clarity, Confirmation, and Reach to Public Information~~ **Canceled**  
WS136. You're Going to Need More Than Ice, Water, and Fuel: Modern Day Logistical Challenges  
WS137. Are You FEPA Certified?  
WS138. Working Effectively with Elected Officials During Hurricane Preparedness, Response, and Recovery  
WS139. Changing How We Look at Situational Awareness in the EOC While Leveraging Technology  
WS140. Leveraging AI for Smarter Response and Recovery  
WS141. Partnerships to Bridge the GAP: Mass Care and Community Based Healthcare  
WS142. Florida Voluntary Organizations Active in Disaster: 35 Years Practicing the 4C's  
WS143. CDBG Funding – Past, Present, Future  
WS144. Recovery Support Functions in Action  
WS145. Disaster Legal Issue Spotting: An Interactive Workshop  
WS146. Navigating Cybersecurity, Infrastructure Security, and Sustainability in the 911/Emergency Communications  
~~WS147. Leveraging Probability Data through GIS for Tropical Decision Support~~ **Canceled**  
WS148. Housing Mitigation Strategies 101  
WS149. Academic Research Presentations  
WS150. FEMA Public Assistance in Florida – Hot Topics & Lessons Learned  
WS151. Atlantic Basin Hurricane Season Prediction/Outlook  
WS152. AI 101: Explanation of AI and Its Implications  
WS153. Hurricane Milton: The Sarasota and Manatee County Story  
WS154. Supporting Access and Functional Needs Populations Before, During, and After a Tropical Event  
WS155. The Art of Finding Harmony! A Discussion of the Journey of 1st Time CDBG-DR Grantees  
WS156. Hurricane-Related Fatalities: The Who, Where, When, and How  
WS157. Bull Horns, Billboards, Banner Planes & Beyond  
WS158. Tornado Threats & Impacts with Hurricane Milton and Lessons Learned  
WS159. The Politics of Disasters and Leading During Crisis

## **2025 Workshop Descriptions**

WS101. One Team, One Voice: County and Municipalities Working Together for Their Community – *Organized by Faye Evans*

Thursday, May 15, 8:30 a.m. – 10:00 a.m. PBCCC 1A

Communication and coordination between county and municipal partners is essential during times of disaster. Palm Beach County Division of Emergency Management, Palm Beach County Intergovernmental Affairs, and the Palm Beach County League of Cities has a long history of working together as a team to create a system of clear communication during blue and gray skies. Learn ways you can build a system to leverage resources, open communication, and provide transparency in times of crisis. Learn tips and tricks to navigate relationships through all levels of government to achieve a positive outcome for residents within your communities.

WS102. Building a Ready & Resilient Disaster Response & Recovery Team – *Organized by Lee Mayfield*

Thursday, May 15, 8:30 a.m. – 10:00 a.m. PBCCC 1BC

This panel discussion will focus on building and developing resilient and focused response and recovery teams, using proven steps to help your team members and their families prepare for and recover from disaster events. In emergency management, we focus on planning, responding, and serving others during major events; however, we often forget to help our teams prepare their home and family for the same events. This panel discussion features experienced emergency management professionals discussing how they lead and prepare their teams and leadership as they prepare, respond, and recover from emergency activations. The panelists will share what they have learned from recent activations and response operations on encouraging and supporting team members and their families throughout crisis events. The panelist will also provide some tips on self-care and offer ideas and resources to help you build a more engaged and resilient response team.

**WS103. Turning Setbacks into Comebacks: Understanding FEMA's Updated Appeals Process Rules & What to Expect in Arbitration – Organized by Lisa Barnes**

Thursday, May 15, 8:30 a.m. – 10:00 a.m. PBCCC 1DE

This session will provide a unique opportunity to learn about the procedural rules and best practices applicable to FEMA's appeal and arbitration processes, from professionals who have been in the trenches, and using real-world case studies to illustrate major pitfalls and best practices. It is critical that stakeholders understand the available options and this session will provide the "rule book" to mitigate risks and help level the playing field when FEMA is expected to deny costs. Panelists will provide an overview of the FEMA administrative appeal process, including recent changes, and a detailed review of the Disaster Recovery Reform Act (DRRA) arbitration process now available for qualifying disputes related to any major disaster event declared January 1, 2016 and forward. Panelists will also cover best practices to support efficient and effective resolution of issues based on their actual experience with both processes, and address recent appeal and arbitration decisions and the lessons learned from those actions.

**WS104. The Pinellas County Response Story: 2024 Hurricane Season – Organized by Jessica Geib**

Thursday, May 15, 8:30 a.m. – 10:00 a.m. PBCCC 1GHI

This session will provide a comprehensive overview of Pinellas County's response to the 2024 hurricane season, featuring a panel of key coordination partners from various departments, along with the Emergency Management Director. Panelists will discuss the county's response to Hurricanes Helene and Milton, covering critical topics such as water rescue operations, communications challenges, utilities restoration, healthcare disruptions, and sheltering needs. Through sharing lessons learned and best practices, attendees will gain valuable insights into coordinating complex responses across departments and agencies. The panel will also highlight strategies for addressing key challenges, such as ensuring the delivery of essential services and maintaining public safety, and will provide actionable recommendations for implementing these approaches in future disaster scenarios.

**WS105. Hurricane Response in Fiscally Constrained Counties – Organized by Jeff Goldberg**

Thursday, May 15, 8:30 a.m. – 10:00 a.m. PBCCC 1L

FEMA Public Assistance reimbursements are disbursed after expenses have been covered by the applicant. However, what happens when the initial funds are unavailable? This recent hurricane season proved exceptionally costly. In this session, we'll explore the challenges faced by financially strained counties as they managed the expenses incurred from not just one, but multiple federally declared disasters.

**WS106. Empowering Rural Counties: Strengthening Volunteer and Donations Management and COADs – Organized by Christy Rojas**

Thursday, May 15, 8:30 a.m. – 10:00 a.m. PBCCC 2A

Disaster response in rural communities presents unique challenges, particularly in managing volunteers and donations under ESF 15. This session will explore strategies to build capacity in rural areas by engaging volunteers and developing COADs (Community Organizations Active in Disaster) to address critical needs efficiently. Drawing from real-world experiences, such as responses to Hurricane Idalia, Debby, and Helene. Participants will gain insights into the pivotal roles of successful utilization of CERT, donation coordination, and supply distribution and how specialized roles can transform chaotic scenarios into coordinated, community-driven recovery efforts.



WS107. Community Engagement: Recovery Center Operations – Organized by *Phill Brodeur*

Thursday, May 15, 8:30 a.m. – 10:00 a.m. PBCCC 2BC

This session aims to establish a comprehensive framework for community engagement in disaster recovery by leveraging the collaborative strengths of federal, state, and county agencies, as well as nonprofit organizations. Recognizing that effective recovery relies on coordinated efforts, we propose a multi-tiered approach that fosters communication, resource sharing, and participatory decision-making among stakeholders. The primary objective of this workshop is to strengthen partnerships by creating opportunities and communication channels among federal, state, local agencies, and nonprofits to enhance coordination during disaster response and recovery. Additionally, the workshop will focus on resource mobilization by establishing a shared platform to streamline support for affected communities.

WS108. Mitigating First Responder Occupational Stress during Hurricane Operations – Organized by *Franklin Riddle*

Thursday, May 15, 8:30 a.m. – 10:00 a.m. PBCCC 2DE

There has been minimal attention to mitigating first responders' mental wellness during and in the immediate aftermath of catastrophic events. With the support of Florida's Chief Financial Officer, initial efforts during the Champlain Towers building collapse and Hurricane Ian led to the establishment of a multi-disciplinary mental wellness team, which is now part of the State Emergency Response Plan. We will present this multi-disciplinary approach to mitigating occupational stress that integrates human resources such as peer support teams and technologies such as virtual reality (VR) as a means to decrease stress and restore cognitive functioning. Pilot data establishing the efficacy of the human and VR components will be presented through data collected in controlled settings and during Hurricane Idalia, Helene and Milton. Ongoing challenges to the implementation of this model will be discussed as are solutions, including a new mobile behavioral health command unit, allowing stress mitigation efforts to operate close to the disaster site, thereby further enhancing these efforts when and where they are most likely to be effective.

WS109. Leading and Managing People During Blue Skies and Grey Skies – Organized by *Kimberly Prosser*

Thursday, May 15, 8:30 a.m. – 10:00 a.m. PBCCC 2F

As emergency managers, we have a wide array of job specific technical training available to us through a wide range of outlets, be they sponsored by the county or state EMA, available via FEMA's Emergency Management Institute (EMI), or from Homeland Security Consortium partners. As we move up on the emergency management profession though, fewer resources are available that focus on effectively managing or leading staff members. This session will provide an opportunity for those newer to managing and leading staff to benefit from very experienced managers/leaders sharing lessons they have learned during their careers. For experienced managers, these lessons can serve as reminders and continuous learning on leading and managing people. Our intent is to leave ample time at the end of the workshop for questions from the audience, as well as for the audience to share from their experience.

WS110. From Command to Collaboration: Advancing EM with the Incident Support Model – Organized by *Robbie Sofaly*

Thursday, May 15, 8:30 a.m. – 10:00 a.m. Hilton Coral AB

In many disaster responses, post-incident reviews often highlight communication breakdowns. While the Incident Command System (ICS) is effective for managing on-scene operations, it can be less efficient in Emergency Operations Centers (EOCs), where coordination and communication are critical. The Incident Support Model (ISM) offers a solution by shifting the focus from command and control to strategic support, continuous communication, and collaboration. ISM enables the Planning Section to focus on both crisis action and future planning, providing the EOC Manager with well-prepared, deliberate plans. By removing Situational Awareness duties from ICS's Planning Section, ISM enhances communication with diverse stakeholders, ensuring vital information flows in both directions, from the field into the EOC and from the EOC to the community. This model allows for real-time feedback, enabling more responsive and adaptable operations during a crisis. ISM also promotes better community engagement by integrating continuous feedback into decision-making, building trust and transparency.

WS112. Understanding State & Federal Procurement in Disasters – Organized by *Kimberly Prosser*

Thursday, May 15, 8:30 a.m. – 10:00 a.m. Hilton Coral DE

Learn essential insights into state and federal contracting, compliance, and disaster procurement. Ideal for procurement professionals, vendors, and government officials, this session equips you with tools to enhance compliance, efficiency, and success in both routine and emergency scenarios. Key Takeaways: Master Florida State Procurement: Understand methods, governance, and ethics for smooth, compliant transactions; Federal Procurement Standards (2 C.F.R. Part 200): Stay current with FEMA's interpretations and strategies for safeguarding federal funding.

WS113. Your Florida State Guard-An Introduction – Organized by Ed Kessler

Thursday, May 15, 1:30 p.m. – 3:00 p.m. PBCCC 1A

Created in 1941 as the Florida Defense Force, then later renamed Florida State Guard, was established to backfill the long-term mobilization and deployment of the Florida National Guard during WWII from 1941 to 1947. Re-established as the Division of the Florida State Guard (FSG) in June 2022, through Florida State Statute 251, the FSG is authorized to grow to strength of 1500 volunteers. Led by a cadre of state employees located in Tallahassee and Camp Blanding Joint Training Center, the FSG provides rapid augmentation to state and local partners by providing access to flooded and compromised areas, route clearance, spontaneous rescues, scene triage, and area reconnaissance and assessment, and is poised to assist with community sustainment efforts. The FSG fulfills many diverse missions via their Crisis Response Battalion, Maritime Response Squadron, Aviation Response Squadron, and Special Missions Unit. This workshop will highlight these capabilities, our recent disaster responses, and how to request FSG support to enhance training, interoperability, and disaster response.

WS114. Preparing For and Responding to Hurricanes at the City Level-Best Practices – Organized by Phill Brodeur

Thursday, May 15, 1:30 p.m. – 3:00 p.m. PBCCC 1BC

In recent years, like many other cities, the City of Plantation has experienced significant staff turnover. This has resulted in a number of new emergency managers and departmental directors with storm-related responsibilities. As a result, the city has had to update and recreate its emergency management processes. This effort goes beyond simply updating CEMP documents—it includes building relationships with vendors, re-establishing and clarifying roles with other governmental agencies, and more. Additionally, the city used insights gained from a smaller event (the April 2023 Broward Flooding) to evaluate its readiness, improve staff training, and enhance technology. We would like to share our experiences—what worked and what didn't—and continue learning from other agencies through this panel forum.

WS115. Healthcare Evacuation and Coordination - Helene/Milton Panel – Organized by Franklin Riddle

Thursday, May 15, 1:30 p.m. – 3:00 p.m. PBCCC 1DE

This will be a discussion-based workshop from the event leading to the evacuation of health care facilities in Pinellas County for both Hurricane Helene and Milton. Our panel comprised of staff from the Tampa Bay Health and Medical Preparedness Coalition and Pinellas County Emergency Management, will discuss the factors leading to evacuation decisions and how health care facilities can be active members of this discussion. The workshop will also focus on how health care facilities can properly execute evacuation or shelter in place plans and how to adapt when plans fail or change as well as deal with situations that arise during and immediately after the landfall of a hurricane.

WS116. The Pinellas County Recovery Story: 2024 Hurricane Season – Organized by Jessica Geib

Thursday, May 15, 1:30 p.m. – 3:00 p.m. PBCCC 1GHI

Building on the previous session, this workshop will focus on Pinellas County recovery strategies following the 2024 hurricane season. Panelists will delve into the challenges associated with assessing substantial damage to homes, addressing debris removal, and meeting unmet human needs in the wake of back-to-back hurricanes. Discussions will include strategies for complex housing needs, managing step down shelters, and navigating long-term recovery, particularly the implementation of the RSF (Recovery Support Function) structure. Attendees will explore best practices for managing recovery efforts and overcoming logistical and resource challenges to accelerate recovery in affected communities. This session will provide actionable insights for responding to the most pressing issues and how you can incorporate lessons learned into your own planning.

WS118. How Government and VOADS Can Collaborate for Response, Recovery, & Building Stronger, More Resilient Communities –  
*Organized by Faye Evans*

Thursday, May 15, 1:30 p.m. – 3:00 p.m. PBCCC 2A

This workshop will guide non-profits, emergency management teams, and elected officials on effectively connecting residents with critical services across all phases of disaster preparedness, response, and recovery. Drawing from our experience, we will highlight key strategies for proactive communication, service management, and volunteer coordination. Key objectives include: Best practices for communicating essential services to residents before and after hurricanes, with a focus on vulnerable populations; A breakdown of the disaster phases for non-profits, detailing available services during preparedness, response, and recovery, and how organizations can align their resources accordingly; A framework for managing volunteers efficiently, addressing challenges and offering solutions for organizing post-disaster volunteer efforts; Strategies for building strong partnerships with other organizations, agencies, and local authorities to improve recovery outcomes. Finally, we will emphasize the critical role of Long-Term Recovery Groups (LTRGs) in sustaining community resilience.

WS119. Substantial Damage and Section 1206 – Best Practices and Resource Coordination Strategies – *Organized by Lee Mayfield*

Thursday, May 15, 1:30 p.m. – 3:00 p.m. PBCCC 2BC

This session will provide a thorough exploration of the DRRR Section 1206 reimbursement processes, focusing on key best practices, recommendations, and requirements. Participants will gain insights into proactively coordinating, approaching and documenting substantial damage permitting and code enforcement activities, and conducting effective community outreach. This session will include case studies to help the participants learn practical strategies for handling complex scenarios and ensuring compliance with FEMA guidelines as well as discuss substantial damage field assessment best practices.

WS121. Florida Communications Unit ESF2: Disaster Season Roundtable – *Organized by Lisa Barnes*

Thursday, May 15, 1:30 p.m. – 3:00 p.m. PBCCC 2F

Hear from Florida's Statewide Interoperability Coordinator (SWIC) and Field Communications Unit Leaders on the 2024 response season, and emerging technologies utilized to support EOC's, 9-1-1 centers, incident management teams, and incident responders across all disciplines. Learn about training opportunities and resources available across Florida.

WS122. Emergency Operations Center Management: Best Practices for Running Your EOC During a Large-Scale Incident –  
*Organized by Lee Mayfield*

Thursday, May 15, 1:30 p.m. – 3:00 p.m. Hilton Coral AB

Emergency Operations Centers (EOCs) serve a critical role during disasters, from being the hub for all coordination during response to facilitating recovery efforts. This workshop will focus on the key skills and resources needed to manage an EOC through the lens and best practices of Sarasota and Palm Beach Counties. This high-level overview will focus on enhancing teamwork, building successful communication strategies, and maximizing resources and mutual aid during a high-stress activation.

WS124. Two Steps Forward One Step Back: The Impacts of Successive Disasters on Long-Term Recovery Efforts – *Organized by Christy Rojas*

Thursday, May 15, 1:30 p.m. – 3:00 p.m. Hilton Coral DE

Lee County, Florida was two days away from the two-year anniversary of Hurricane Ian when the region was impacted by Hurricane Helene. Not quite two weeks after Hurricane Helene, the area was yet again struck; this time by Hurricane Milton. Many of the most vulnerable Hurricane Ian survivors found themselves once again having to piece their homes back together. Further complicating recovery efforts were the major changes made to the FEMA Individual Assistance program in March of 2024 which created flexible funding, expanded eligibility, and a simplified application process. In this workshop, we will discuss how Hurricanes Helene and Milton restarted the recovery process for some Hurricane Ian survivors, set others back many months, and found others who had escaped earlier storms unscathed navigating the long-term recovery process for the first time. Attendees will hear from long term recovery groups, case management agencies, non-profits, and governmental representatives on the challenges of navigating recovery from multiple disasters with differing resource allocations and optimizing recovery outcomes for survivors while avoiding duplication of

benefits.

WS125. Emergency Feeding Options – *Organized by Kimberly Prosser*

Thursday, May 15, 3:30 p.m. – 5:00 p.m. PBCCC 1A

This panel will include representatives from local emergency management. They will discuss the USDA's programs including the National School Lunch Program (NSLP), The Emergency Food Assistance Program (TEFAP), Supplemental Nutrition Assistance (SNAP), and Disaster SNAP; partnering with non-profit organizations for mass feeding, and lessons learned in the 2024 hurricane season.

WS126. Rebuilding Utility Resilience: Pinellas County's Approach for Stronger Collaboration – *Organized by Jessica Geib*

Thursday, May 15, 3:30 p.m. – 5:00 p.m. PBCCC 1BC

In 2024, Pinellas County Utilities underwent a leadership transition, which sparked a shift in how emergency management was approached. Faced with a changing climate and the need to prepare for potentially stronger hurricanes, the department set out to build a new emergency management program from the ground up. County department leadership will share insights on the challenges they encountered, including the learning curve and strategies for gaining support for the new program. They will also reflect on the best practices and lessons learned of their responses during the 2024 hurricane season. Additionally, a municipality representative will join the discussion to explore how the County collaborated with local utilities and address the unique challenges faced by municipal departments during Hurricanes Helene and Milton.

WS127. Exploring F-ROC: A Game-Changer for Florida Communities – *Organized by Phill Brodeur*

Thursday, May 15, 3:30 p.m. – 5:00 p.m. PBCCC 1DE

We will review the successful completion of the second year of the Florida Recovery Obligation Calculation (F-ROC) program. This groundbreaking initiative has revolutionized the recovery process for Florida communities, expediting the disbursement of Public Assistance dollars and offering timely relief in times of need. During this session, we will delve into the origins of F-ROC, review its current status, and map out our future plans. Additionally, participants will gain a clear understanding of the program's successes, opportunities, and lessons learned since inception. Come and learn how F-ROC has positively impacted Florida and discover what lies ahead in our continued efforts to optimize the recovery process for our communities.

WS128. Leveraging AI for Effective Business Continuity and Risk Management – *Organized by John Jamason*

Thursday, May 15, 3:30 p.m. – 5:00 p.m. PBCCC 1GHI

In an increasingly uncertain world, organizations must adopt innovative strategies to ensure resilience and minimize risk. This workshop focuses on harnessing the power of Artificial Intelligence (AI) to enhance business continuity and risk management efforts. Participants will explore how AI technologies can predict potential disruptions, automate response protocols, optimize resource allocation, and strengthen cybersecurity defenses. Designed for business continuity planners, IT leaders, risk managers, and executives, this session will provide practical insights and real-world applications of AI to proactively manage risks and maintain critical operations during crises. Join us to learn how to transform your organization's approach to continuity and risk management with cutting-edge AI solutions.

WS129. Pre-Storm Preparation, Volunteer Mobilization and other Lessons Learned from Previous Response Efforts - *Organized by Christy Rojas*

Thursday, May 15, 3:30 p.m. – 5:00 p.m. PBCCC 1L

The panel for this session will discuss the efforts made and tools used by The Church of Jesus Christ of Latter-day Saints to be prepared to respond as quickly and efficiently following a hurricane or other natural disaster. We will cover lessons learned regarding command center set up, organization of supplies, work order management, how we mobilize large numbers of volunteers, and our efforts to teach our members to be as self-sufficient as possible, especially during and after a disaster.



We welcome anyone to come and learn about the contribution our church is making to help cleanup Florida and bring some measure of peace and hope to those needing it.

WS130. From Shelter to Stability: Navigating Human Needs Solutions After Disaster – *Organized by Jessica Geib*

Thursday, May 15, 3:30 p.m. – 5:00 p.m. PBCCC 2A

After a disaster, shelter clients face varying recovery timelines: some can return home immediately, others once power is restored, while some face more complex situations where their homes are severely damaged or inaccessible, or they encounter other barriers to recovery. Simply applying for FEMA Individual Assistance or Transitional Sheltering Assistance may not be enough to help them secure stable housing. This session will explore the complexities of addressing shelter clients' human needs from the perspectives of county, state, non-profit, and contractor entities. Focusing on collaboration, participants will discuss how to effectively work together to ensure a seamless recovery process that meets basic needs and utilizes available resources at all levels. Key to this effort is asking the right questions and staying focused on the ultimate goal: returning impacted residents to safe and sanitary housing.

WS131. The ABC's of Debris Operations – *Organized by Jeff Goldberg*

Thursday, May 15, 3:30 p.m. – 5:00 p.m. PBCCC 2BC

DMS sites, pre-event contracts, monitoring, waterways—the to-do list is endless! So, what lessons can we take from this past season and those before it? Join this dynamic panel discussion featuring experts in the trenches—from debris removal companies to monitoring teams. They'll share real-world insights and hard-earned lessons to help you stay ahead and be better prepared for when disaster strikes again.

WS132. Using Technology of Coordination and Review of Healthcare CEMPs – *Organized by Franklin Riddle*

Thursday, May 15, 3:30 p.m. – 5:00 p.m. PBCCC 2DE

Last year, the Florida Health Care Coalitions funded a statewide compliant platform for the development and review of healthcare CEMPs for healthcare and emergency management partners. In this session, plan reviewers will have the opportunity to work within the system to learn how they can review, query, and navigate the CEMP plans that have been developed within their individual counties and area of jurisdiction. This is a simplified process for review and feedback for CEMPs; allowing local emergency managers to use technology to coordinate with healthcare coalitions and individual health centers. We will end with a Q&A session with a panel of healthcare coalition, tech and emergency management subject matter experts.

WS133. Urban Search & Rescue Deployment and Support – *Organized by Eve Rainey*

Thursday, May 15, 3:30 p.m. – 5:00 p.m. PBCCC 2F

This workshop will comprehensively address the operational framework of urban search and rescue (US&R) resources deployed in response to both anticipated and unanticipated events. Participants will gain insights into the current resources available within the State of Florida, including their capabilities and the coordinated support from Florida, federal, and EMAC (Emergency Management Assistance Compact) resources. Key topics will include pre-event planning strategies and deployment criteria essential for effective preparedness. Attendees will be guided through the establishment of a planning cell, its evolution into an incident support team/incident management team upon deployment identification, and the operational procedures and requirements before, during, and post-deployment. Furthermore, the workshop will highlight the essential role of emergency managers in facilitating necessary information and interactions throughout the deployment phases. Additionally, it will overview supplementary fire-based resources that may accompany and persist after completion of US&R missions.

WS134. Rebuilding Together Florida -Strategies for Sustainable Disaster Recovery Across Florida – *Organized by Jessica Geib*

Thursday, May 15, 3:30 p.m. – 5:00 p.m. Hilton Coral AB

This workshop will provide a comprehensive look at Rebuilding Together Florida's experiences in disaster recovery, drawing on lessons learned from recent events such as Hurricanes Ian, Idalia, and Debby. Participants will explore best practices for long-term, sustainable recovery efforts, with a particular focus on supporting underserved communities in disaster-prone areas. The session will cover key operational goals, including assessing statewide vulnerabilities, identifying areas often overlooked by short-term recovery efforts, and developing strategies to assist low-income families, older adults, veterans, and individuals with disabilities. Attendees will learn about the importance of establishing and maintaining a long-term presence in affected communities through partnerships with local organizations. Additional topics will include securing resources for extended recovery, balancing immediate needs with long-term rebuilding goals, and adapting recovery strategies for different regions, including coastal and inland areas. This session offers valuable insights into the ongoing commitment required for effective disaster recovery and rebuilding efforts.

**WS136. You're Going to Need More Than Ice, Water, and Fuel: Modern Day Logistical Challenges – Organized by Ed Kessler**

Thursday, May 15, 3:30 p.m. – 5:00 p.m.

Hilton Coral DE

In recent years, emergency managers are tasked with a variety of event types outside of weather-related disasters. Panelists have years of industry experience responding to a variety of events, including the management of over 100 COVID-19 testing and vaccine sites, and thousands of beds at post-disaster support camps. The panel will discuss challenges and lessons learned from recent events to ground the conversation in real world examples, such as operating within short timelines, in small spaces, and in different types of landscapes or structures. Audience members will learn the importance of having a comprehensive emergency response contract in place for assets such as pumps, power, ice, water, and basecamps. The key to being prepared is planning during blue skies to identify what your constraints are and what services are needed to bridge the gaps, allowing government leaders, emergency managers, and private-sector contractors to focus on the immediate response and the community in need.

**WS137. Are You FEPA Certified? – Organized by Jeff Goldberg**

Friday, May 16, 8:30 a.m. – 10:00 a.m.

PBCCC 1A

Why be FEPA Certified? What does it mean to me? During this interactive workshop, learn what kinds of emergency management certification opportunities exist for you as a FEPA member. This includes the Healthcare Certification and Instructor Certification. This workshop will cover the items that you need to pay attention to as you craft your certification application. Commissioners will present the factors needed to succeed, and then you can ask any specific questions relating to your certification application. Some best practices using the FEPA Certification Portal for online submission will be discussed. THIS WILL NOT BE A STEP-BY-STEP GUIDE TO THE PORTAL.

**WS138. Working Effectively with Elected Officials During Hurricane Preparedness, Response, and Recovery – Organized by Kimberly Prosser**

Friday, May 16, 8:30 a.m. – 10:00 a.m.

PBCCC 1BC

The missions of emergency managers and first responders are not political in nature. Truly excelling in accomplishing those missions during Hurricane preparedness, response, and recovery, even mitigation, requires effective collaboration and communication with elected and other government officials. This session will provide an opportunity for those newer to the Florida emergency management or responder community to learn from their peers how they have navigated this important part of the job. Elected officials on the panel will also provide their perspective on how they would like to and/or need to be involved in these processes for planning and operational purposes.

**WS139. Changing How We Look at Situational Awareness in the EOC While Leveraging Technology – Organized by Alison Osborn**

Friday, May 16, 8:30 a.m. – 10:00 a.m.

PBCCC 1DE

With ever changing ways to collect data for situational awareness, there is a way to leverage technology to create one place for information to feed. Manatee County Emergency Management and Public Safety have partnered with Peregrine to create an Integrated Public Safety solution for the county. This workshop will focus on the software solution that brings together multiple data points seamlessly into practical dashboards for emergencies, events, and daily monitoring. A demonstration of the solution used for Manatee County will bring new vision to how we look at extracting data from sources like ESRI, NWS, NHC, CAD, WebEOC, HURREVAC, SCADA, and many more, into a usable product with low effort.

WS140. Leveraging AI for Smarter Response and Recovery – Organized by John Jamason

Friday, May 16, 8:30 a.m. – 10:00 a.m.

PBCCC 1GHI

In the face of disaster recovery challenges, the integration of Artificial Intelligence (AI) tools presents a profound opportunity to bolster response strategies, optimize resource allocation, and fortify resilience. This presentation delves into how AI can revolutionize efforts across three critical domains; Firstly, by enhancing situational awareness through AI-driven analytics that process vast datasets from sources like social media and satellite imagery, emergency teams gain real-time insights into disaster-affected areas.

Secondly, AI algorithms can optimize resource allocation by forecasting post-disaster community needs based on historical data patterns. This predictive analysis helps organizations anticipate requirements for essentials such as shelter, food, and medical supplies, enabling more efficient resource deployment, minimizing waste, and enhancing overall response effectiveness. Lastly, AI-powered communication tools such as chatbots and virtual assistants play a pivotal role in improving communication channels. This integration not only enhances accessibility but also ensures that critical information reaches those who need it most promptly.

WS141. Partnerships to Bridge the GAP: Mass Care and Community Based Healthcare – Organized by Faye Evans

Friday, May 16, 8:30 a.m. – 10:00 a.m.

PBCCC 1L

Florida's Community Health Centers (CHCs) address social determinates of health through highly accessible primary care and services and recognize the increased, complex needs of vulnerable patient populations during disasters. Upon activation, county emergency management (EM) and partners engage in mass care operations to meet emerging needs including sheltering, feeding, and supply distribution. Raising awareness of CHC services and partnership opportunities can support collaborative approaches to meeting these needs through proactive communication and planning with EM, Public Health, and Community/Voluntary Organizations in a Disaster (C/VOADs). This panel discussion will highlight the shared recovery goals across EM, Public Health, C/VOADs, and CHCs to explore how these partners work together to close potential gaps between mass care and community-based healthcare. This workshop will share current examples from Hurricanes Helene and Milton.

WS142. Florida Voluntary Organizations Active in Disaster: 35 Years Practicing the 4C's – Organized by Jessica Geib

Friday, May 16, 8:30 a.m. – 10:00 a.m.

PBCCC 2A

This workshop will celebrate 35 years of history and impact as the Florida Voluntary Organizations Active in Disaster (FLVOAD), highlighting key milestones and lessons learned in disaster recovery. Panel participants will provide insights into FLVOAD's mission to support disaster survivors and strengthen collaborative networks across Florida, emphasizing the critical role of the 4C's (Coordination, Communication, Cooperation, and Collaboration) in effective emergency management. The session will discuss how these principles have shaped FLVOAD's approach to disaster response, preparedness, and recovery, illustrating the power of collective action through partnerships with local, state, and federal agencies, non-profits, and volunteers. Real-world examples will provide practical strategies for enhancing coordination, improving communication, and fostering cooperation among all sectors involved in disaster management, ultimately supporting long-term recovery and resilience in vulnerable communities.

WS143. CDBG Funding – Past, Present, Future – Organized by Lee Mayfield

Friday, May 16, 8:30 a.m. – 10:00 a.m.

PBCCC 2BC

Join us for a special panel discussion commemorating the 50th anniversary of Community Development Block Grant (CDBG) funds. This event will delve into the rich history of the CDBG program, examining its significant role in disaster recovery and community rebuilding. Our panel of industry experts will provide a comprehensive overview of the program's evolution, highlighting key milestones and its impact on affected communities over the decades. We will also explore innovative approaches and emerging trends that are shaping the future of disaster recovery. Topics will include evolving challenges, recent policy advancements, and strategies for leveraging CDBG-DR funds to foster more resilient, equitable communities. Whether you're a policymaker, grant administrator, community leader, or simply interested in the future of disaster recovery, this discussion will offer valuable insights and forward-looking perspectives on the program's ongoing transformation and its critical role in enhancing community resilience.

WS144. Recovery Support Functions in Action – Organized by Lee Mayfield

Friday, May 16, 8:30 a.m. – 10:00 a.m.

PBCCC 2DE

After the historic 2024 hurricane season, communities throughout Florida will be embarking on a complex and long-term disaster recovery process. The Recovery Support Function (RSF) structure has been refined over past storm recoveries to enable an organized, comprehensive, and whole-community based recovery effort. This workshop will highlight Florida communities who are utilizing the RSF structure and jurisdictions who have built out a planning framework to use RSFs after future storms.

WS145. Disaster Legal Issue Spotting: An Interactive Workshop – Organized by Jessica Geib

Friday, May 16, 8:30 a.m. – 10:00 a.m.

PBCCC 2F

Join us for an interactive workshop on disaster legal services, designed to help emergency management partners identify and address common legal issues faced by survivors. Participants will learn about key legal challenges in disaster recovery and engage in activities like Disaster Legal Services Bingo to spot legal issues in real-life scenarios. Experts will highlight how legal aid plays a vital role in disaster preparedness and recovery, using examples from recent hurricanes including Debby, Helene, and Milton. Attendees will leave equipped with practical knowledge on how to access legal assistance for their communities when the next event strikes.

WS146. Navigating Cybersecurity, Infrastructure Security, and Sustainability in the 911/Emergency Communications – Organized by Alison Osborn

Friday, May 16, 8:30 a.m. – 10:00 a.m.

Hilton Coral AB

With the increased frequency of emergencies, the need for a secure, reliable, and sustainable 911 communication system is more critical. This panel consists of 911 community leaders, who will discuss the current and future landscape of cybersecurity and infrastructure security. Discussion topics will include integrating cybersecurity protocols to safeguard against evolving threats; ensuring privacy protections for sensitive information; developing sustainable practices that enhance critical infrastructure resiliency. Members of the panel will explore current advancements and challenges, and how building a collaborative relationship with CISA will help 911centers develop an effective emergency response to future threats. The panel will also explore building a collaborative relationship with CISA and the role of artificial intelligence and machine learning in emergency communications. Attendees will gain insights into innovative strategies for implementing secure and sustainable emergency communication systems, learn how collaborating with government partners can benefit their emergency preparedness, and discuss how to balance technological innovation with security and privacy.

WS148. Housing Mitigation Strategies 101 – Organized by Eve Rainey

Friday, May 16, 8:30 a.m. – 10:00 a.m.

Hilton Coral DE

In the aftermath of severe weather events, state and local government officials are presented with a near-impossible task: managing an active humanitarian crisis while simultaneously planning for a long-term recovery effort. As the severity and frequency of severe weather events increases, mitigation strategies become increasingly attractive as property losses become increasingly repetitive. Both FEMA and HUD grants fund two housing mitigation strategies: buyouts and elevations. These grant types represent an important binary choice that government officials must make – "Should we rebuild our homes stronger, or should we retreat from the threat?" This workshop will discuss the dichotomy between home elevation programs and home buyout programs. It will provide local officials with a list of goals they can and should accomplish before disasters strike so that a strategy, vetted by impacted communities, is already in place when it is needed. The presenters will discuss what the differences between buyouts and elevations are, the homeowner experience in both types of programs, and various funding sources for these types of grant programs.

WS149. Academic Research Presentations – Organized by Jessica Geib

Friday, May 16, 10:30 a.m. – Noon

PBCCC 1A

This session will feature selected research presentations from students in Emergency and Disaster Management related academic courses or programs. Participants are selected through an application process. A panel discussion with key emergency management stakeholders and practitioners will follow each presentation.



All are encouraged to attend to engage with future emergency managers and current researchers. Research posters will be on display near the registration table throughout the week. Audience participation is encouraged.

WS150. FEMA Public Assistance in Florida – Hot Topics & Lessons Learned – *Organized by Robbie Sofaly*

Friday, May 16, 10:30 a.m. – Noon PBCCC 1BC

Since Hurricane Irma hit Florida in 2017, FEMA's eligibility and funding decisions have become increasingly strict. This session will explore the policy interpretations behind FEMA's decision making through real world case studies involving Florida Public Assistance applicants. Specifically, four increasingly common reasons for denial will be discussed: procurement non-compliance, failure to establish pre-disaster condition, failure to establish disaster-caused damage, and inadequacy of documentation. Additionally, the topic of cost reasonableness will be covered and how sub-recipients can decrease their risk of de-obligation. Attendees will leave aware of potential eligibility issues and ways to avoid falling into these common pitfalls.

WS151. Atlantic Basin Hurricane Season Prediction/Outlook – *Organized by René Daines*

Friday, May 16, 10:30 a.m. – Noon PBCCC 1DE

Colorado State University is excited to share its comprehensive Atlantic hurricane forecast for the upcoming 2025 season. During this presentation, we will delve deeply into the various components and methodologies that underpin our forecast.

WS152. AI 101: Explanation of AI and Its Implications – *Organized by John Jamason*

Friday, May 16, 10:30 a.m. – Noon PBCCC 1GHI

Artificial Intelligence and its implications for emergency management can be a force multiplier for practitioners at all levels. These applications can range from real-time decision making, automated responses, simulations, trainings, data management, grant management, communications, and resource optimization. The Future of AI for Florida can be leveraged to support smaller rural communities, supporting planning, partnerships, and leaving with a take a way tips for use right after this session.

WS153. Hurricane Milton: The Sarasota and Manatee County Story – *Organized by Lee Mayfield*

Friday, May 16, 10:30 a.m. – Noon PBCCC 1L

Hurricane Milton made landfall near Siesta Key on Wednesday, October 9, 2024, as a Category 3 hurricane. Just a few days prior, Milton rapidly intensified into a Category 5 storm, a worst-case scenario for coastal counties along the west coast of Florida. This workshop will highlight two counties in the direct path of Hurricane Milton and allow attendees to hear their story. From evacuation decisions and sheltering, to debris operations, and post-disaster housing issues, the panel will have an open conversation on successes, challenges, and pitfalls as they dealt with their final storm response of the 2024 season.

WS154. Supporting Access and Functional Needs Populations Before, During, and After a Tropical Event – *Organized by Lisa Barnes*

Friday, May 16, 10:30 a.m. – Noon PBCCC 2A

Maintaining independence, communication, transportation services, safety, support, and health care for individuals requiring additional response and recovery assistance is critical to ensuring the survival and well-being of our most vulnerable citizens. This workshop focuses on the professionals and organizations that support and serve individuals with disabilities who live independently, reside in long-term care facilities, are elderly, children, from diverse cultural backgrounds, have limited English proficiency, or face transportation challenges. The emphasis will be on practical strategies for collaboration and purposeful service delivery to enhance preparedness, response, and recovery efforts. Presenters will include experts with experience in providing services to individuals with access and functional needs during the challenging 2024 Hurricane Season.

WS155. The Art of Finding Harmony! A Discussion of the Journey of 1st Time CDBG-DR Grantees – *Organized by Lee Mayfield*

Friday, May 16, 10:30 a.m. – Noon PBCCC 2BC

Hurricane Ian, a near Category 5 hurricane, pounded Southwest Florida in September 2022 resulting in catastrophic widespread damage and loss of life, presenting significant challenges to emergency response and recovery managers. This discussion will be with

panel members from Florida Commerce, Florida first time CDBG-DR local grantees, Sarasota and Volusia counties, and GrantWorks and will center on the do's and don'ts, challenges faced, and successes of designing and implementing programs that are compliant and meet community needs. Discussions will include strategies to develop Action Plans and the planned initiation of programs. The presentation will include real-life examples and lessons learned regarding program set-up, reporting, data management, program design, community engagement, local inter-departmental impact, and educating elected officials.

WS156. Hurricane-Related Fatalities: The Who, Where, When, and How – Organized by David Sharp

Friday, May 16, 10:30 a.m. – Noon

PBCCC 2DE

This session explores the critical assessment of hurricane-related fatalities, a key statistic reflecting community preparedness and resilience. Accurately determining this number is complex, with death records sometimes taking over a year to finalize. This workshop, a collaboration between the College of Public Health at the University of South Florida and NOAA's National Hurricane Center, will delve into the methodologies for collecting data on hurricane-related fatalities. They will present findings on trend analysis such as direct versus indirect fatalities, demographic and geographic impacts, causes of death, and timing in relation to the storm. Understanding these patterns is essential for refining response strategies. The presenters aim to demonstrate how this information is utilized to enhance public education and improve emergency preparedness and response plans. By gaining deeper insights into hurricane-related fatalities, communities can better strategize to reduce future storm-related deaths, ultimately fostering greater resilience against natural disasters.

WS157. Bull Horns, Billboards, Banner Planes & Beyond – Organized by John Jamason

Friday, May 16, 10:30 a.m. – Noon

PBCCC 2F

Dive into the art of communication after disaster strikes. When technology fails, it's time to go back to basics. From the booming power of bull horns to the timeless effectiveness of billboards, this course explores various methods to ensure your message reaches its audience. We won't stop there; we'll also tackle banner planes, crafting attention-grabbing messages amidst chaos. Whether you're communicating with Baby Boomers or Gen Alpha, this course equips you with the tools to effectively reach any demographic. Join us as we navigate the post-disaster communication landscape with creativity, resilience, and a touch of old-school charm.

WS158. Tornado Threats & Impacts with Hurricane Milton and Lessons Learned – Organized by Faye Evans

Friday, May 16, 10:30 a.m. – Noon

Hilton Coral C

This workshop combines a presentation and panel discussion to highlight the often-overlooked threat of tornadoes in tropical systems. NOAA's National Weather Service (NWS) will provide an overview of these tornadoes, which can disrupt preparedness, increase risks during hurricanes, and complicate response efforts. The session will review the rare tornado outbreak from Hurricane Milton, featuring deadly EF2 and EF3 tornadoes that caused catastrophic damage along Florida's Treasure Coast. Emergency Managers from Palm Beach, Martin, and Saint Lucie counties, along with WPBF 25, will share insights, challenges, and lessons learned from this event. Attendees will gain tools and strategies to better assess tornado threats, improve communication, and protect vulnerable populations during hurricanes.

WS159. The Politics of Disasters and Leading During Crisis – Organized by Lee Mayfield

Friday, May 16, 10:30 a.m. – Noon

Hilton Coral DE

Pete Gaynor served as FEMA Administrator and acting Secretary for the Department of Homeland Security in addition to his roles as a director of a state and local emergency management agency and 26 years in the U.S. Marine Corps. This workshop will focus on Pete's lessons learned based on successfully leading complex organizations through multiple disasters. Pete will share his valuable experience with attendees to include discussions on politics during disasters, leading up, and resisting pressure during crisis. The workshop will also end with an engaging Q&A session.

# Diverse Selection of **BUNK HOUSE**

## Sleeping Quarter Trailers



# NRT

SPECIALTY TRAILERS

Sourcewell



**NRTSales.com**

**877-727-3621**



## BE A MASTER OF DISASTER WITH AN M.A. IN DISASTER MANAGEMENT

Apply for Fall 2025 | Application Deadline: June 1, 2025

From top-ranked academic programs to collaborative partnerships with domestic and international agencies, **Florida International University** is a South Florida anchor institution and a solutions center for growing crises and disasters.

The **Master of Arts in Disaster Management** at FIU's Academy for International Disaster Preparedness is a 30-credit graduate program featuring coursework in emergency management and international humanitarian assistance. FIU developed this program in response to the growing frequency of natural and human-induced disasters. Graduates of the program have pursued careers in private and public sectors across global, federal, state, and local levels.

The program's curriculum develops and improves the skills of disaster practitioners and those interested in entering the exciting field of disaster management. Instead of a traditional thesis, both fully online and face-to-face students complete a multi-day disaster field operations exercise. The exercise tests students' abilities to respond to a large-scale international disaster.

- 11-month graduate program
- Among the lowest tuition rates at FIU (Financial aid and scholarships are available)
- Face-to-Face or fully Online classes
- Flexible program for busy schedules
- Internships and post-graduation job employment opportunities

### DID YOU KNOW?

Classes take place in FIU's Emergency Operations Center (EOC)—**only 11%** of universities in the U.S. have an active EOC.



For more information, contact:  
Dulce Suarez, PhD  
Graduate Program Assistant Director  
T: 305-348-0451 | E: [dboza@fiu.edu](mailto:dboza@fiu.edu)

Learn more at  
[academy.fiu.edu](https://academy.fiu.edu)





## Notes

## This image shows a full page of blank, lined paper. It features approximately 20 evenly spaced horizontal grey lines across the entire width of the page, typical of notebook or legal stationery. The background is a solid off-white color. There are no margins, text, or other markings present.



**EMERGENCY  
SANDBAG**  
*Response*



## Rapid Sandbag Deployment for Flood Emergencies

### Hurricane Season Demands Speed. ESR Delivers.

Emergency Sandbag Response collaborates with municipalities to provide rapid, on-site sandbag deployment within hours, helping leaders stay ahead of the storm. Our mobile units operate across multiple locations at once, to prioritize high-risk areas for effective flood protection.



#### Fill One Sandbag Every 3 Seconds

Each ESR unit fills a sandbag every 3 seconds, supplying thousands across multiple sites to meet any storm response need.



#### Fully Mobile Sandbag Deployment

ESR deploys self-contained mobile units and crews directly to city's designated locations, removing manual labor and logistical hurdles.



#### Pre-Season Contracts for Priority Response

Cities that contract with ESR secure dedicated resources in advance, ensuring they have the sandbags they need before a flood hits.

Booth #  
**438**

**Meet us at the Governor's  
Hurricane Conference.**

May 14-15, 2025  
Palm Beach, FL



**Lock-in your pre-season contract.  
Schedule your consultation today.**

(888) 777-0002 | [actnow@sandbags.info](mailto:actnow@sandbags.info)  
[www.sandbags.info](http://www.sandbags.info)

# IRG GLOBAL

EMERGENCY MANAGEMENT



PREVENTION



MITIGATION



RESPONSE



PREPAREDNESS



RECOVERY

When disaster strikes,  
IRG Global is ready.

**IRGGLOBAL.COM**

From hurricanes to wildfires and international crises, our team has been on the frontlines of disaster response. With decades of experience, we've helped communities recover, rebuild, and thrive after some of the most challenging emergencies in recent history.

EXPLORE OUR  
EXPERIENCE

